

DATA SHEET

FR-HP Pitch Control Unit

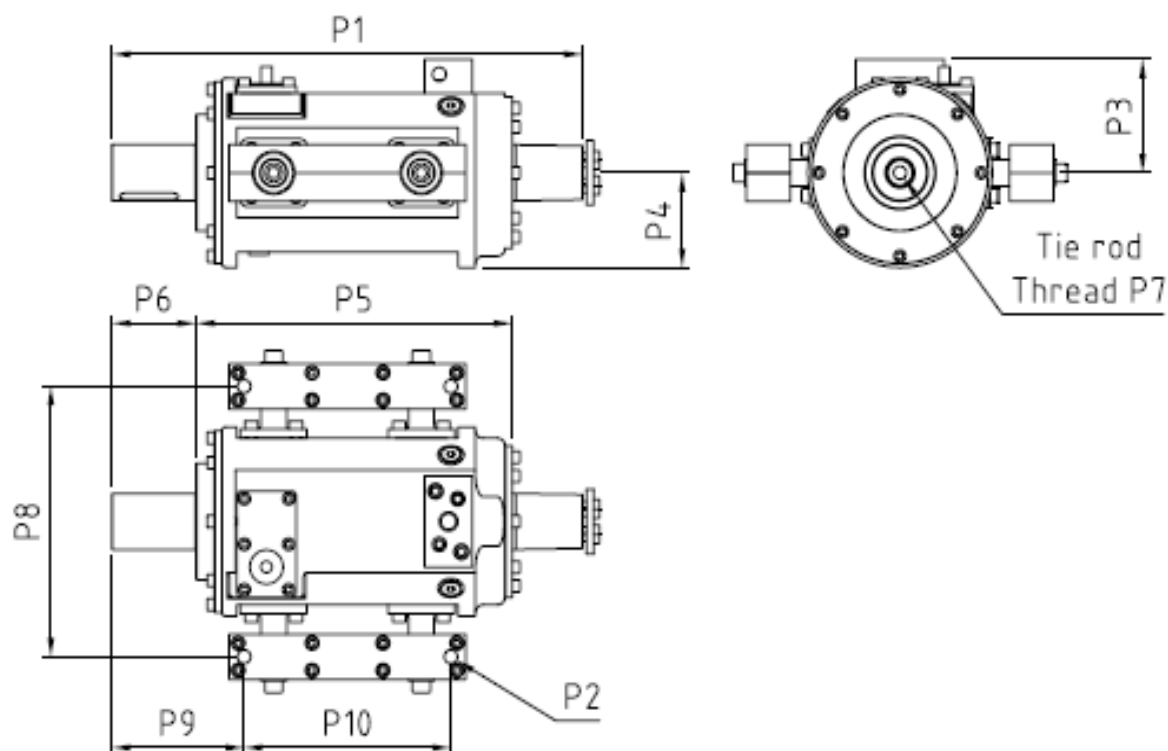

VP	3	4	5	6	7	8	9	10	11	11½	12
P1 [mm]	637	637	788	788	788	940	940	940	1230	1661	1469
P2 [mm]	ø18	ø18	ø18	ø18	ø18	ø31	ø31	ø31	ø31	-	ø25
P3 [mm]	150	150	175	175	175	210	210	210	270	275	325
P4 [mm]	125	125	120	120	120	153	153	153	250	500	280
P5 [mm]	428	428	500	500	500	600	600	600	785	1045	848
P6 [mm]	114	114	143	143	143	175	175	175	242	309	357
P7 [mm]	M20	M24	M27	M30	M36	M36	M36	M48X3	M52x3	M64x4	M70x4
P8 [mm]	357	357	387	387	387	479	479	479	634		610
P9 [mm]	179	179	254	254	254	295	295	295	374		550
P10 [mm]	280	280	280	280	280	380	380	380	2x270		2x280
Weight [kg]	87	87	152	152	152	240	240	240		1350	1280
Stroke [mm]	90	90	100	100	100	135	135	135	170	175	180
Working pressure [bar]	40	40	30	40	40	40	40	40	50	50	
Max. Pressure [bar]	60	60	60	60	60	60	60	60	60	60	
Tie rod force [kN]	50	50	62	78	109	102	102	205	400	550	
Flow ₁ [l/min]	8	8	14	14	14	36	36	36	43	60	
Time full stroke t ₁ [s]	10	10	10	10	10	10	10	10	20	20	



Stadionvej 4 · DK-3390 Hundested · Danmark · Telefon +45 47 93 71 17 · Telefax +45 47 93 99 02

E-mail: hundested@hundestedpropeller.dk

www.hundestedpropeller.dk