

Propeller 22" – 24" – 26"

Single Pitch for shaft

- 1) OPERATING INSTRUCTIONS 3-blade Gori Folding Single Pitch Propeller
- A) Disassemble complete propeller hub for mounting
- B) Assemble hub on shaft
- C) Exchange of "rubber blade stop"
- D) Exchange of "zinc anodes"
- E) Cleaning of "Gearwheel"
- F) Service sets & Spare Parts List
- G) Supplied Tools

DK

Læs instruktionen før der arbejdes med propellen.

Vigtigt!

Udskift zink hvis de er korroderet mere end 50%.

Advarsel!

Pas på skarpe kanter.

GB

Read the Instructions before any work on the propeller.

Important!

Replace Zinc if eroded more than 50%.

Warning!

Beware of sharp edges.

D

Bitte die Anweisung lesen, bevor Sie mit dem Propeller arbeiten.

Wichtig!

Zinkteile auswechseln, wenn sie mehr als 50% korrodiert sind.

Warnung!

Achten Sie auf die scharfe Kanten.

F

Lire les instructions avant toute intervention sur l'hélice

Important!

Remplacer l'anode zinc si elle est corrodé à plus de 50%

Attention!

Attention aux bords coupants

IT

Leggere attentamente le Istruzioni prima di qualsiasi operazione sull'elica.

Importante!

Sostituire l'anodo di zinco se usurato più del 50%

Avvertenza!

Prestare attenzione alle parti taglienti

ESP

Lea las instrucciones antes de efectuar cualquier trabajo en la hélice.

¡ Importante !

Reemplazar el ánodo si observa mas de un 50 % de corrosión.

¡ Advertencia !

Tenga cuidado con las esquinas afiladas.

OPERATING INSTRUCTIONS 3-blade Gori Folding Single Pitch Propeller

CONGRATULATIONS on choosing the 3-blade Gori Folding Propeller.

Under sail

When sailing under sail the blades usually fold, however, you should put the lever in reverse if the engine is not turned on. This will lock the shaft and ensure that the propeller folds and does not spin.

When under sail, and boat is moving forward thru the water, the propeller will usually fold, to make sure this is the case, the shaft must be stopped before the engine is turned off.

With a mechanic gear box, you may leave the lever in reverse. The shaft is stopped, and the propeller will not spin.

With a hydraulic gear box, you need to put the lever in reverse (boat moving forward thru the water), before turning off the engine, to make sure the shaft is stopped, and propeller will fold.

MOVING AHEAD UNDER POWER

When the engine is turned on, and lever moved from neutral to forward position, the propeller will automatically open (Centrifugal Power), and the boat start moving forward.

MOVING ASTERN UNDER POWER:

When moving backwards from a stand still position (lever moved from neutral to astern), centrifugal power will open the blades, and the boat start moving backwards. When putting the lever back to neutral, the blades will not fold (Moving Backwards), when putting the lever back to forward, the propeller will just start turning the other way, and boat will move ahead.

In reverse, the curved edge on the blade will always be the leading edge. When moving forward from a standstill (folded blades), the curved edge of the blade is the leading. When switching from reverse to forward (Maneuvering), the straight edge of the blade will always be the leading edge when moving forward. The single pitch propeller (SP) operates the same pitch on both sides of the blades.

Before going sailing, check that the propeller works in both forward and reverse.

For the propeller to operate properly, the propeller must be clean and the blades able to move easy and freely. If the boat has not been used for some time, you should shift cautiously between forward and reverse a few times before sailing to clean the teeth of the blades and the gears from fouling.

WARNING !

- **Do not start the engine when the boat is out of the water.**
- **The propeller has sharp edges. Be careful not to cut your fingers !**
- **Make sure that the propeller blades do not suddenly open or close and trap your fingers for example.**
- **Do not turn the propeller/engine shaft until the boat is in the water.**
- **Stop the engine before diving or swimming in the vicinity of the boat.**
- **The propeller blades are like knives and can cause considerable damage when rotating. Be careful!**
- **Do not attempt to remove fishing net or ropes from the propeller when the engine is in motion.**
- **Check that the propeller works in both forward and reverse before starting each trip.**
- **If any strange sounds or vibration are noticed coming from the propeller, stop the engine immediately and solve the problem.**
- **In case of problems in connection with the mounting, use or function of the propeller, contact Gori Propeller or the importer in your country.**

Disassemble complete propeller hub for mounting – (A)

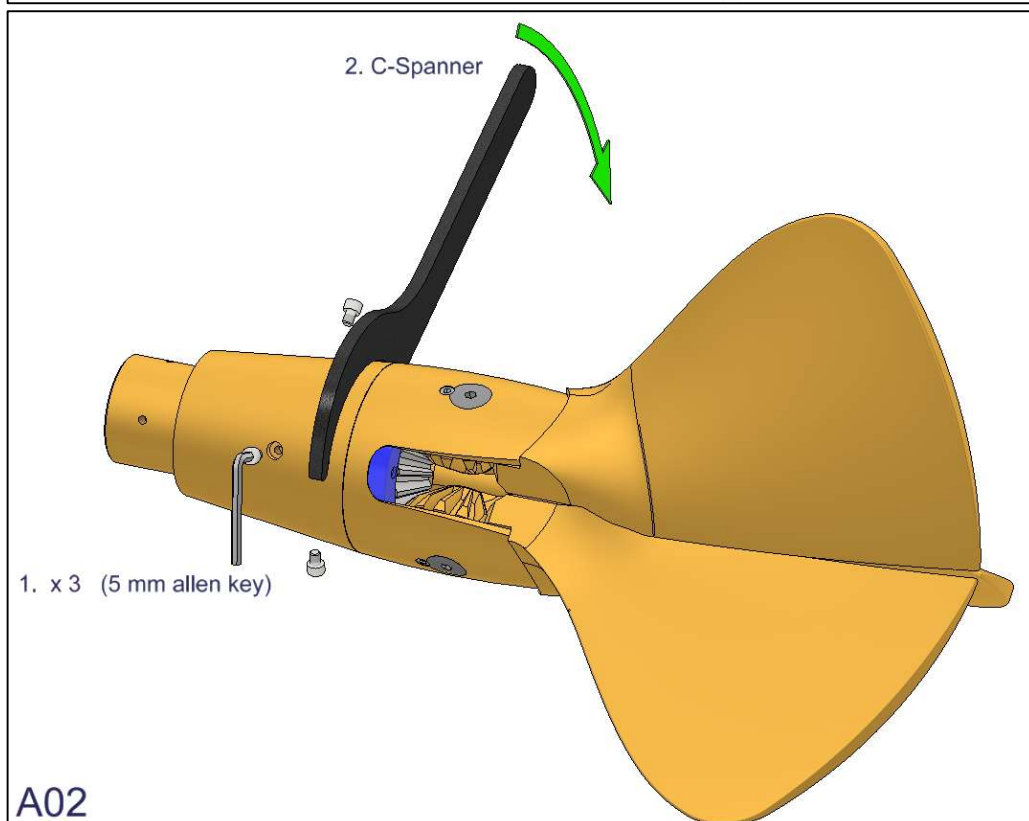
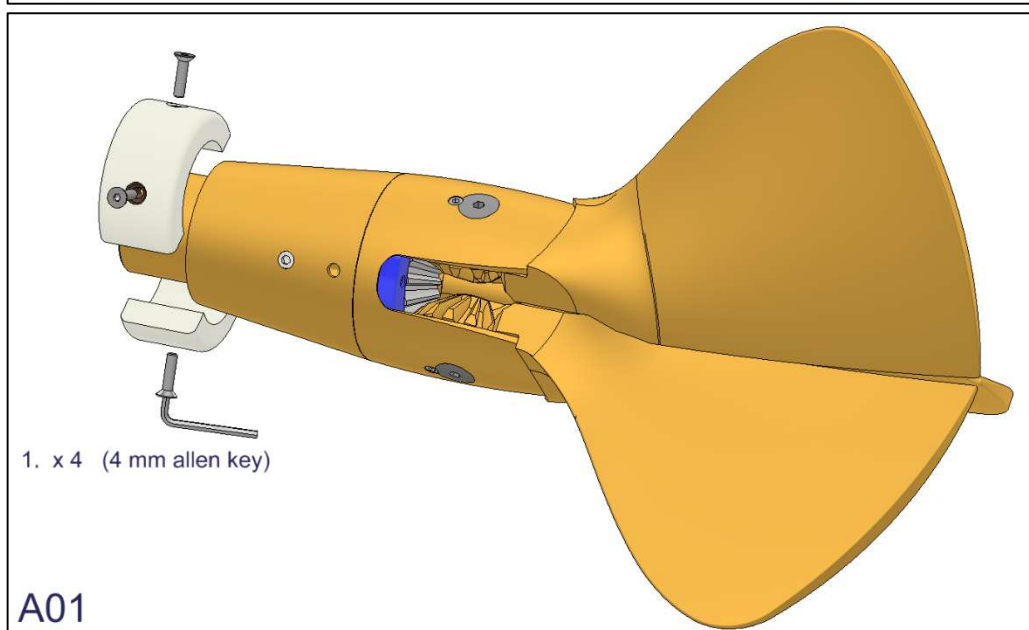
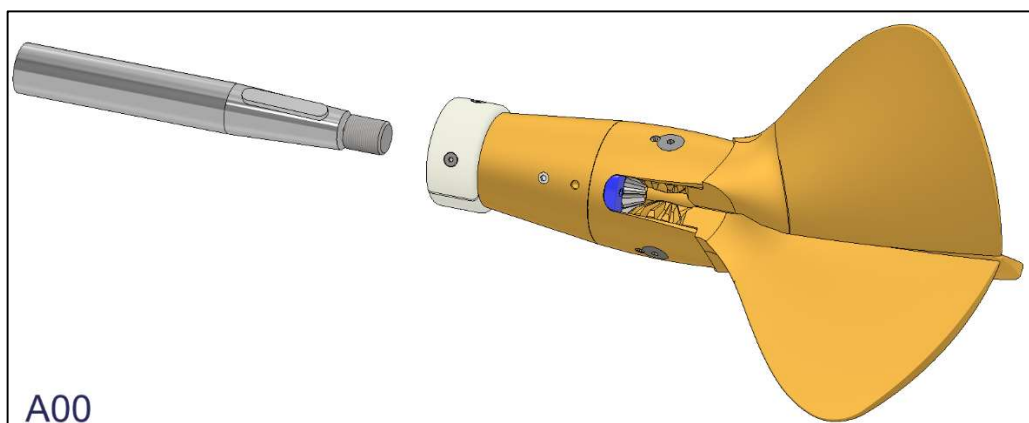

Disassemble complete propeller hub for mounting – (A)

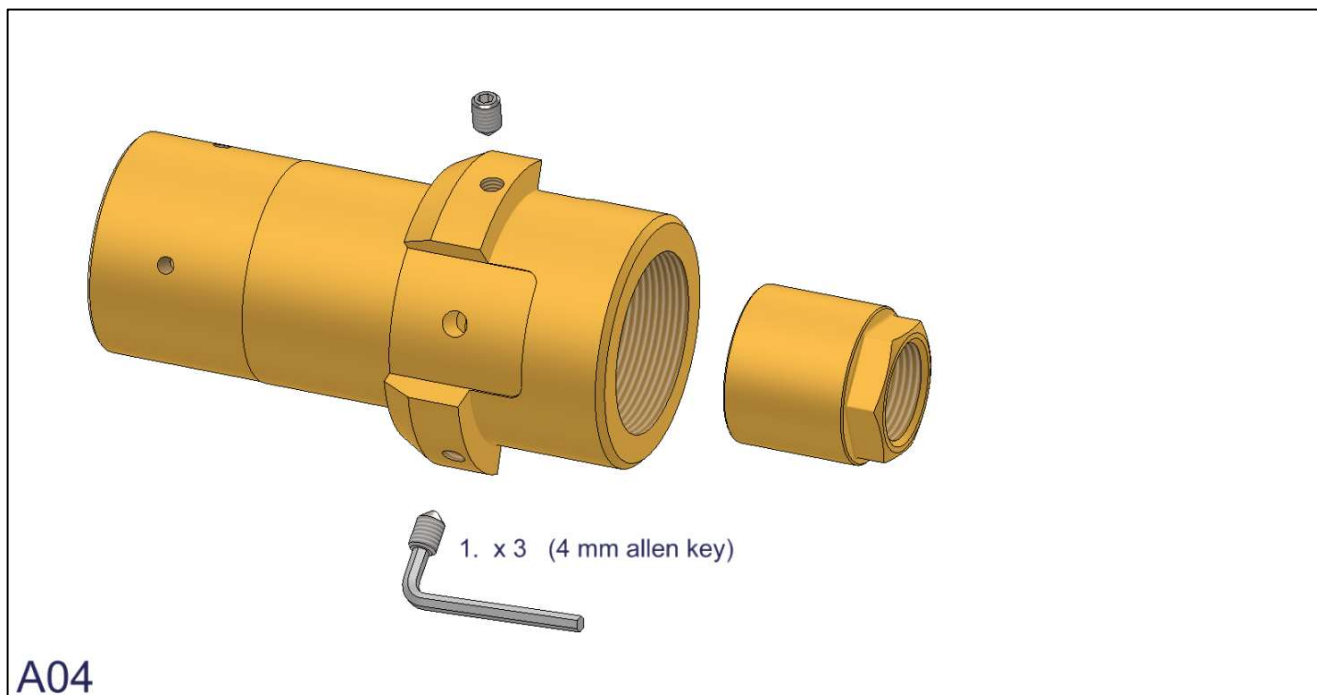
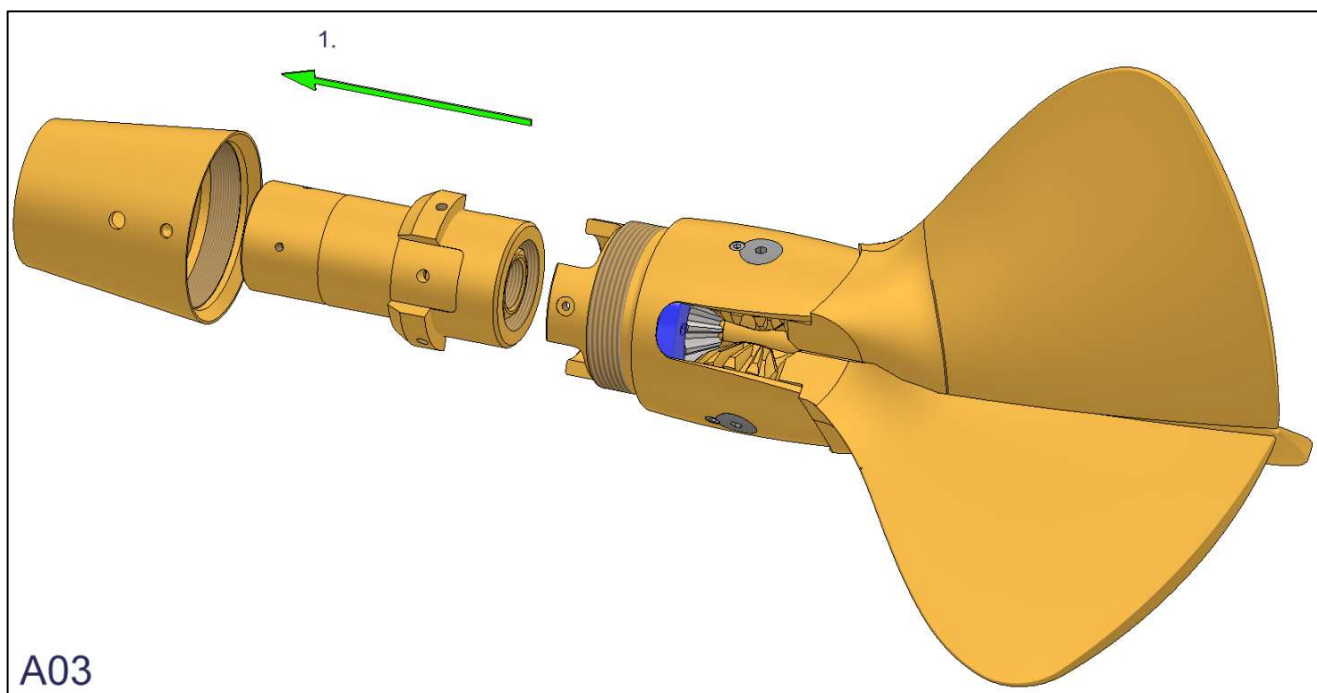

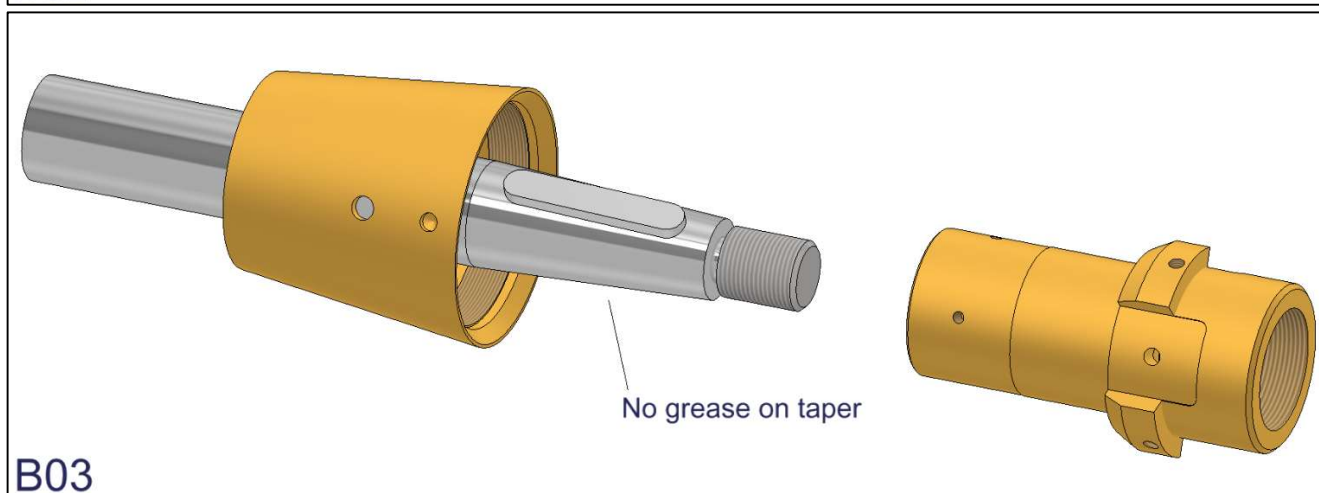
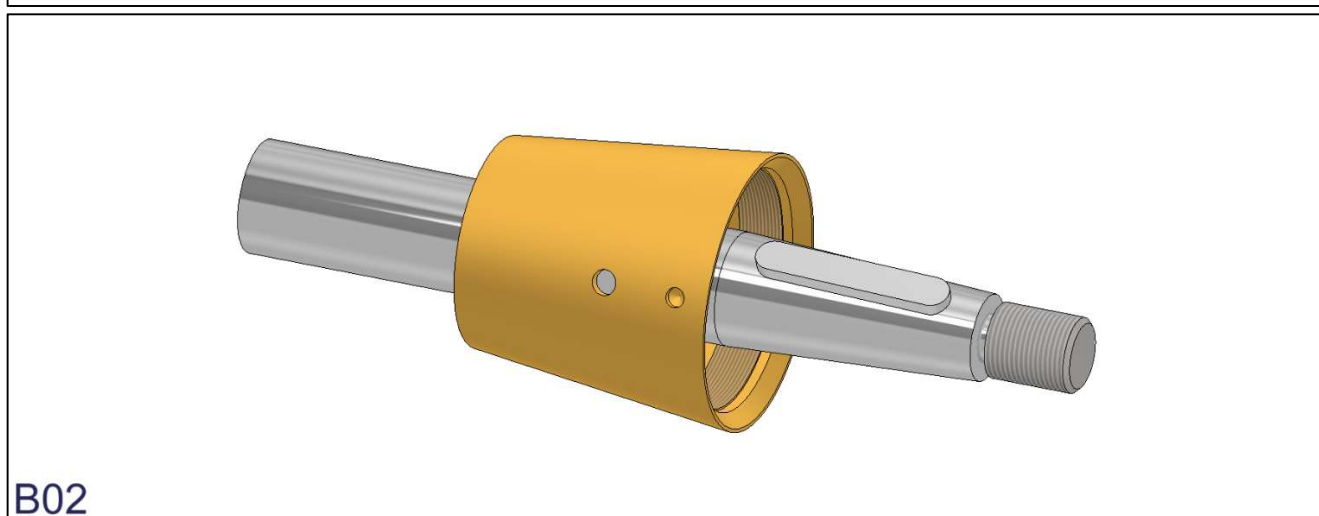
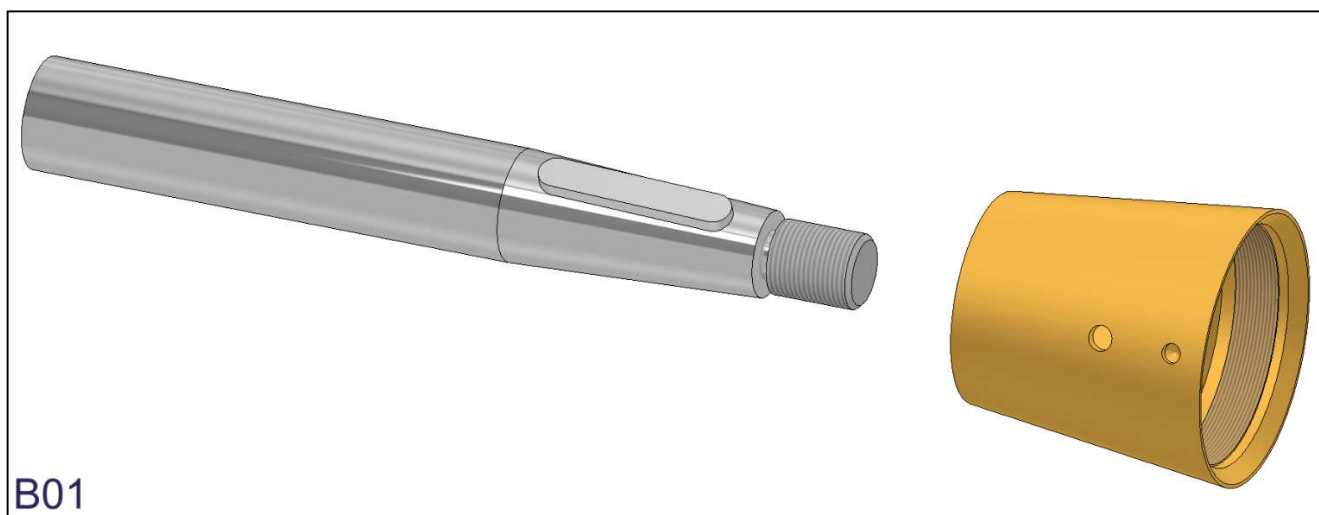

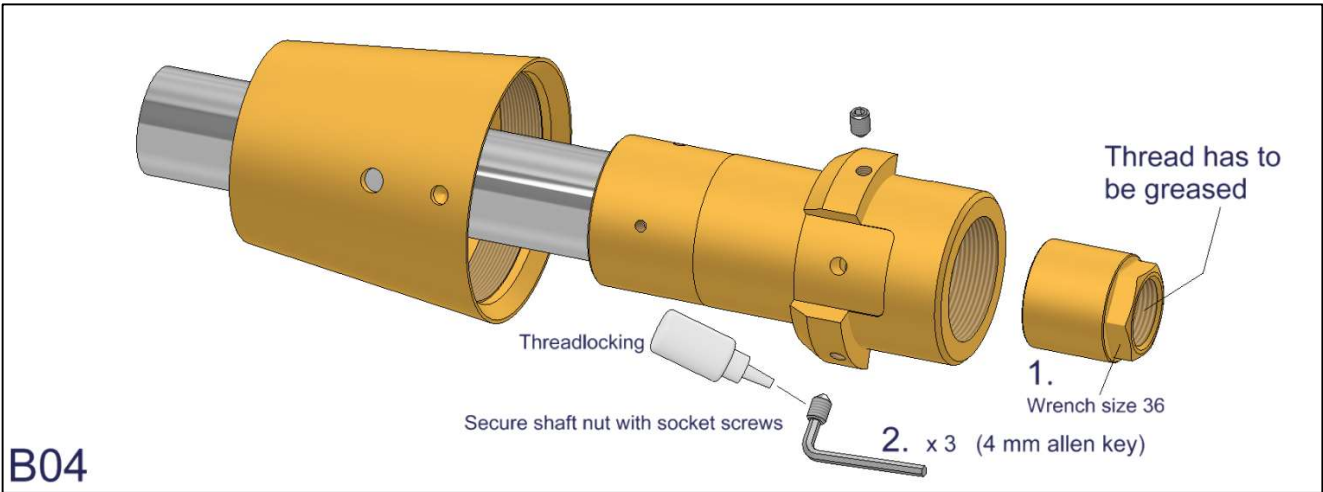

Torque settings for Gori shaft nuts in Nm			
Norm Thread		Torque	
Diameter	Pitch		
mm	mm	Nm	
Table: See section "F".			

Thread has to be greased
No grease on taper on shaft

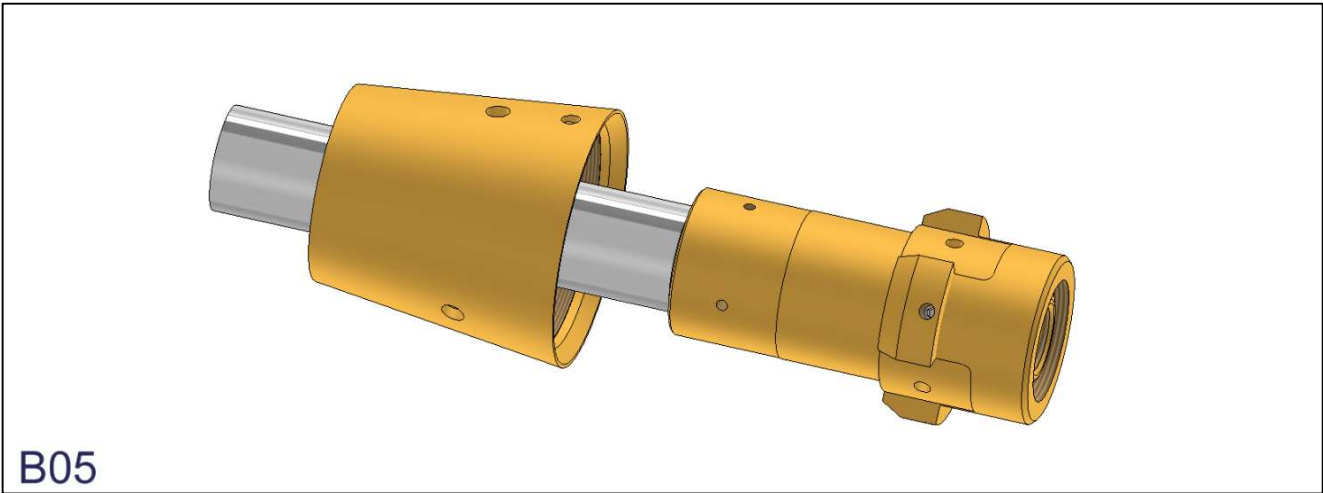

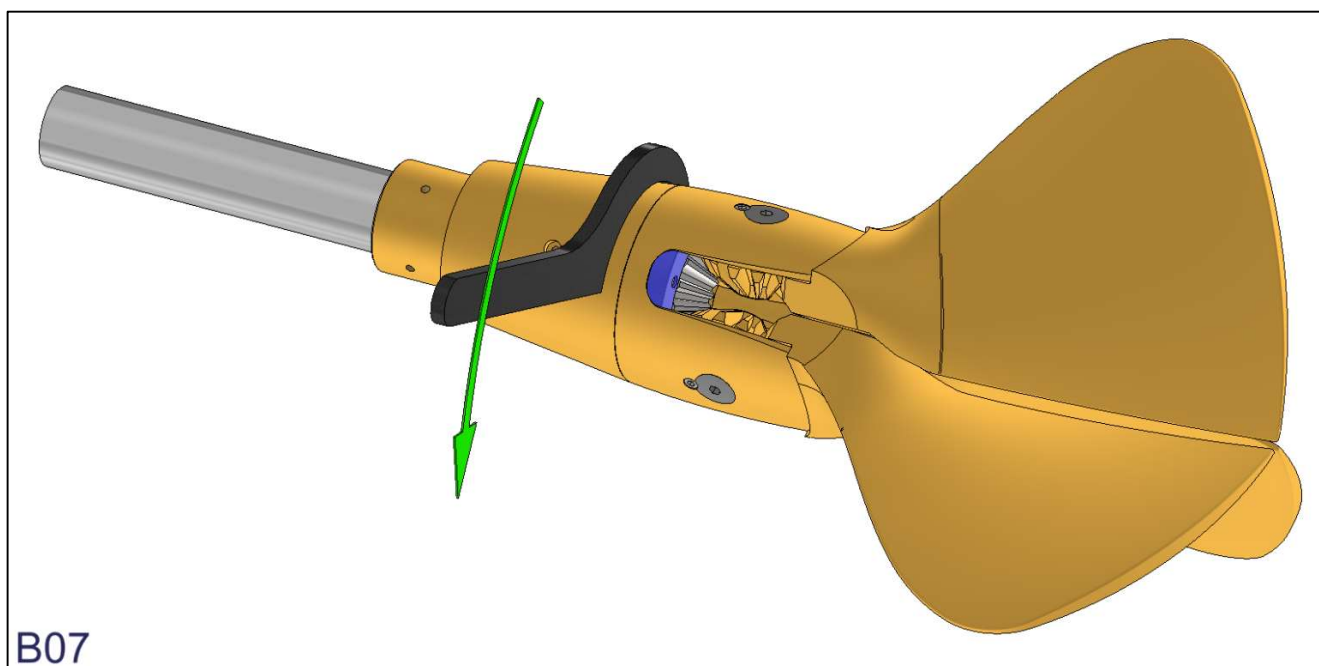
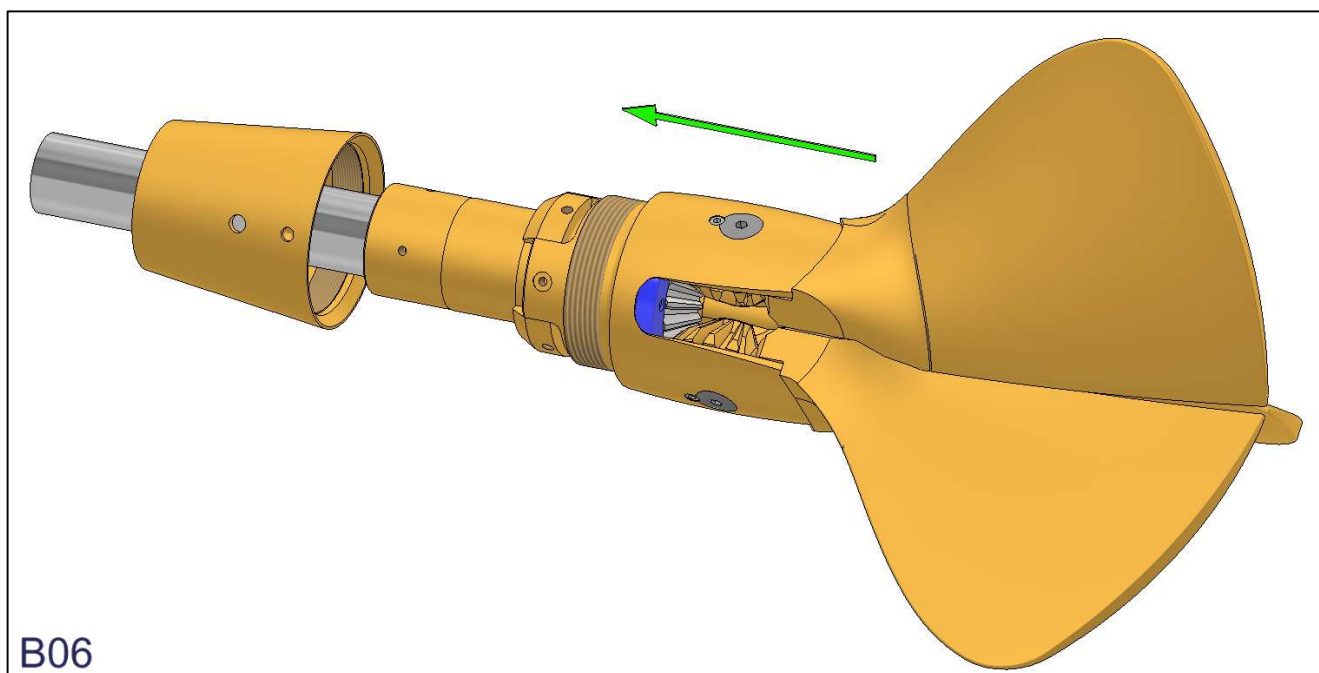

Assemble hub on shaft – (B)

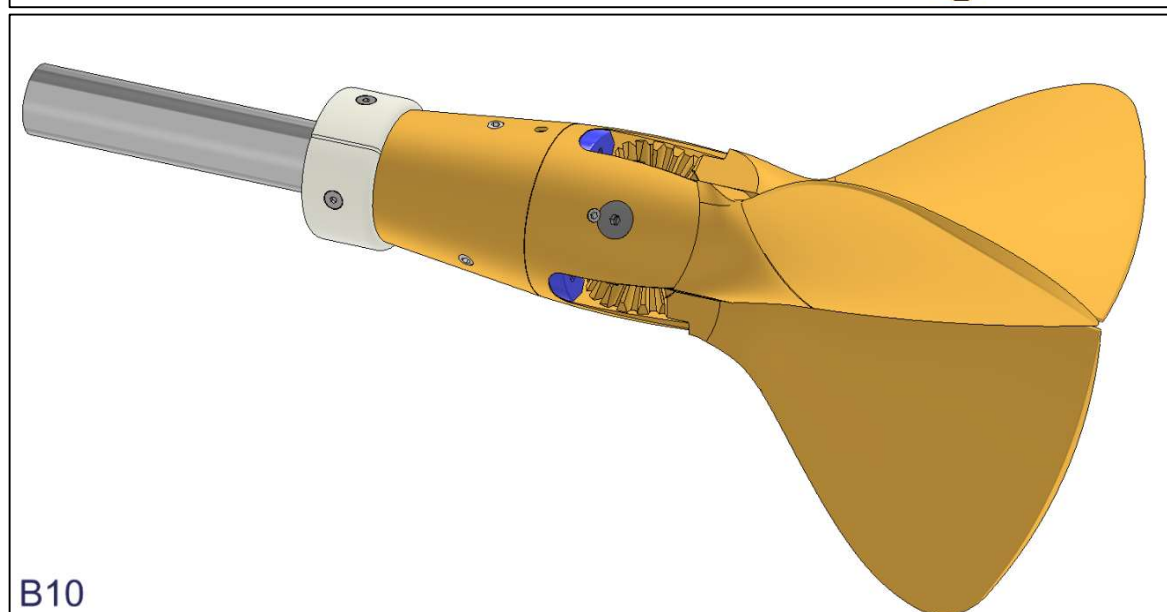
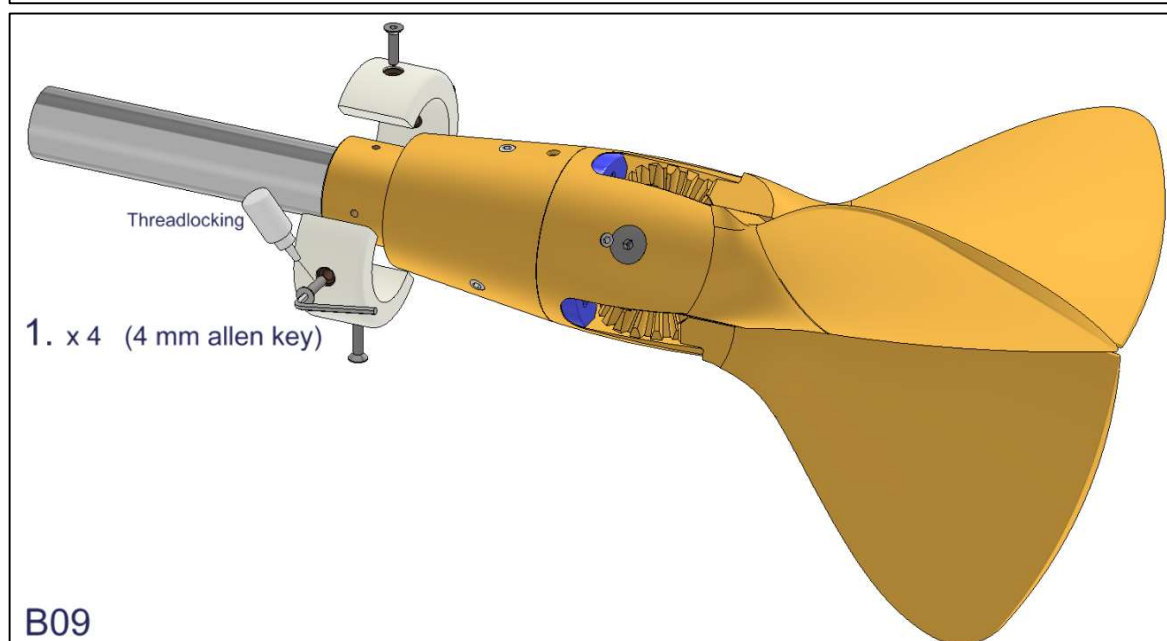
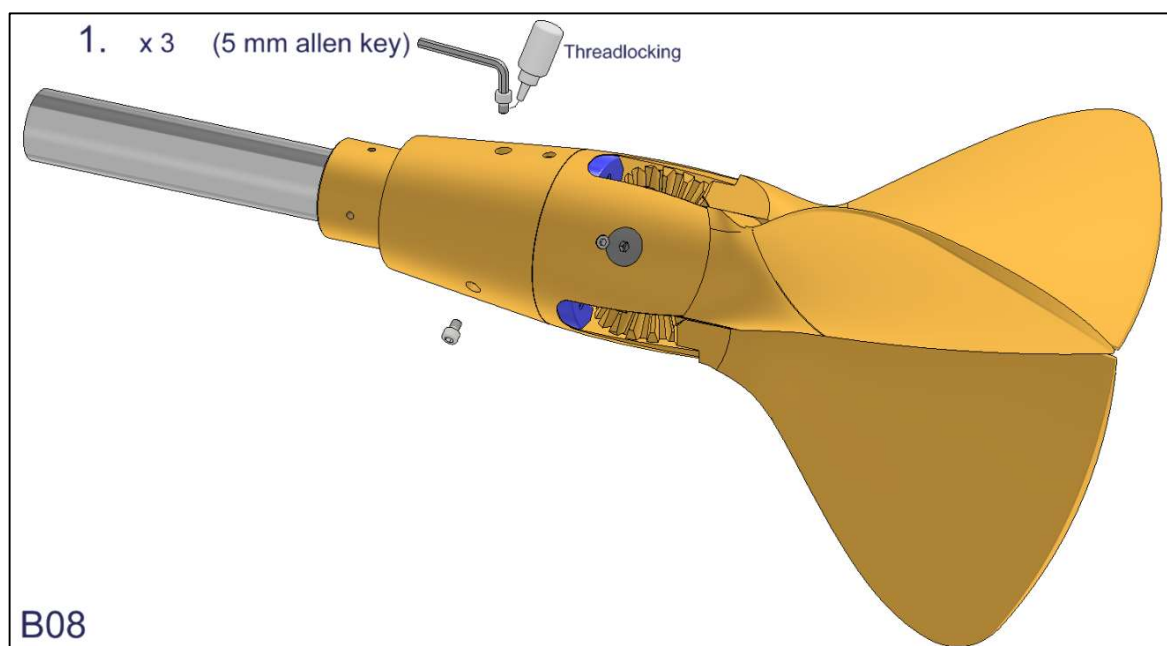

Exchange of “rubber blade stop” – (C)

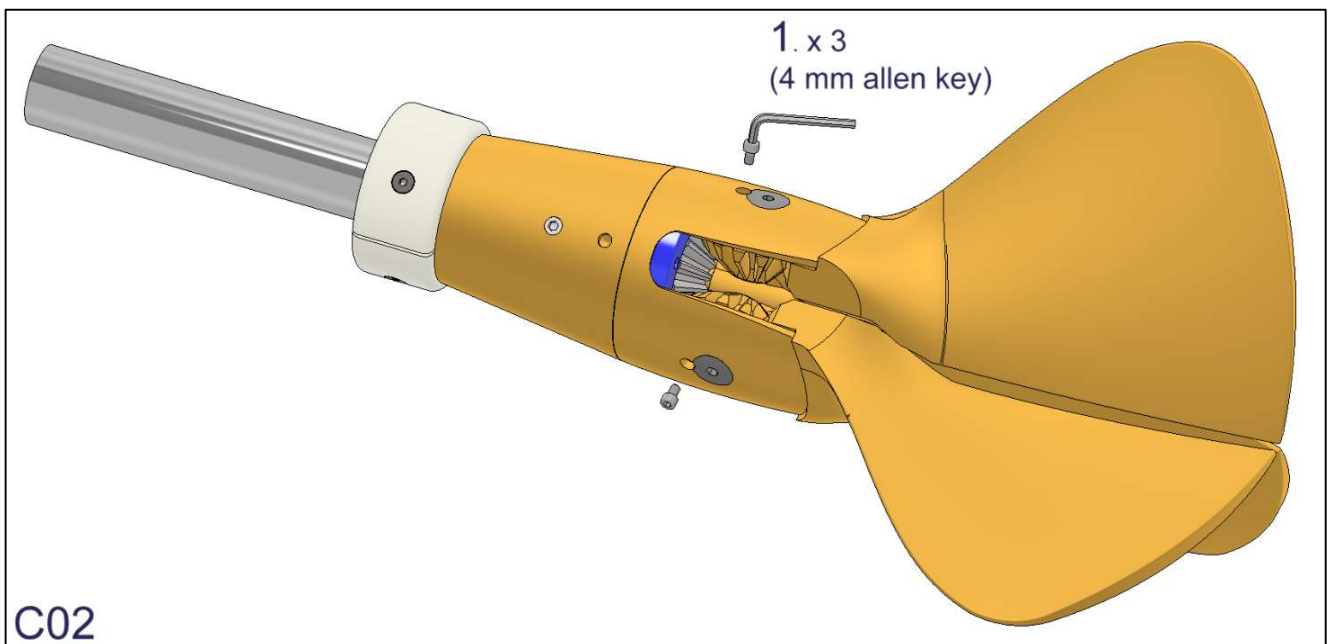
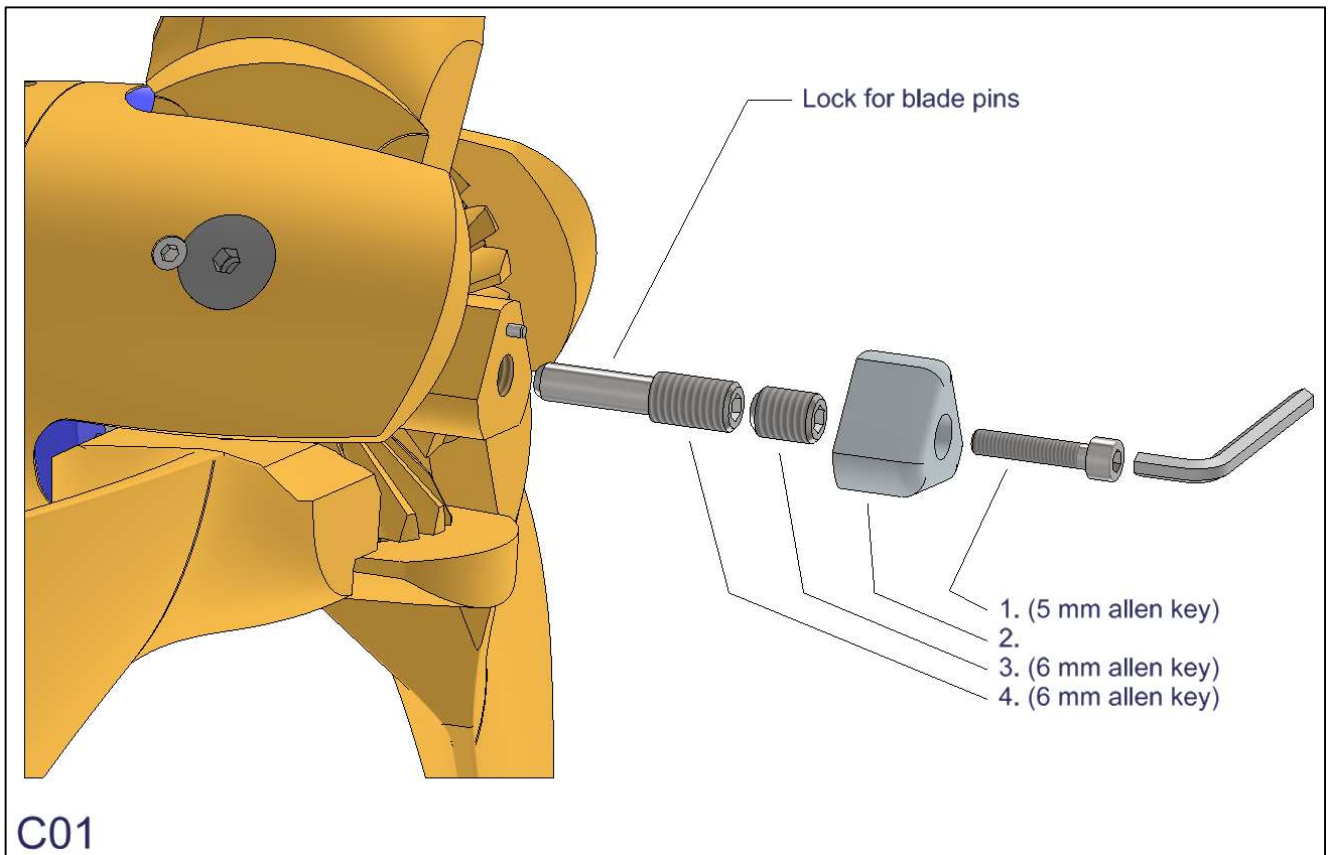

Exchange of “rubber blade stop” – (C)

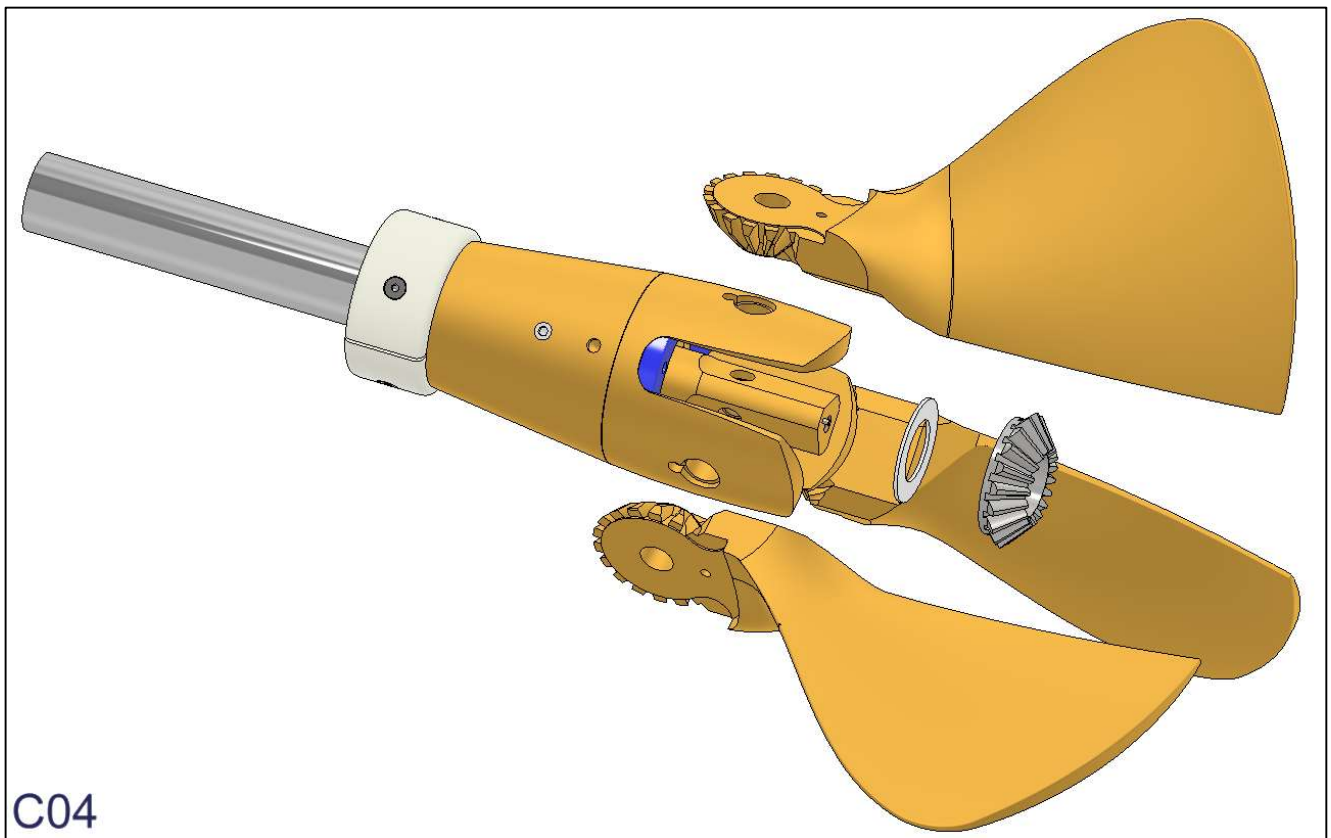
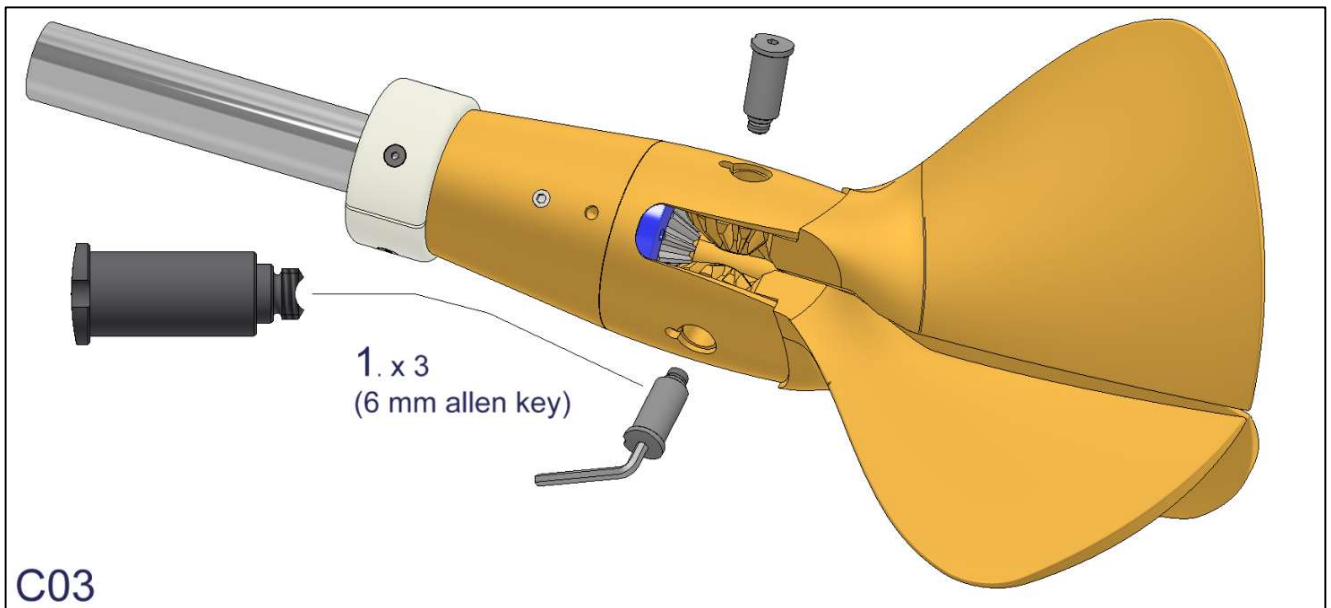

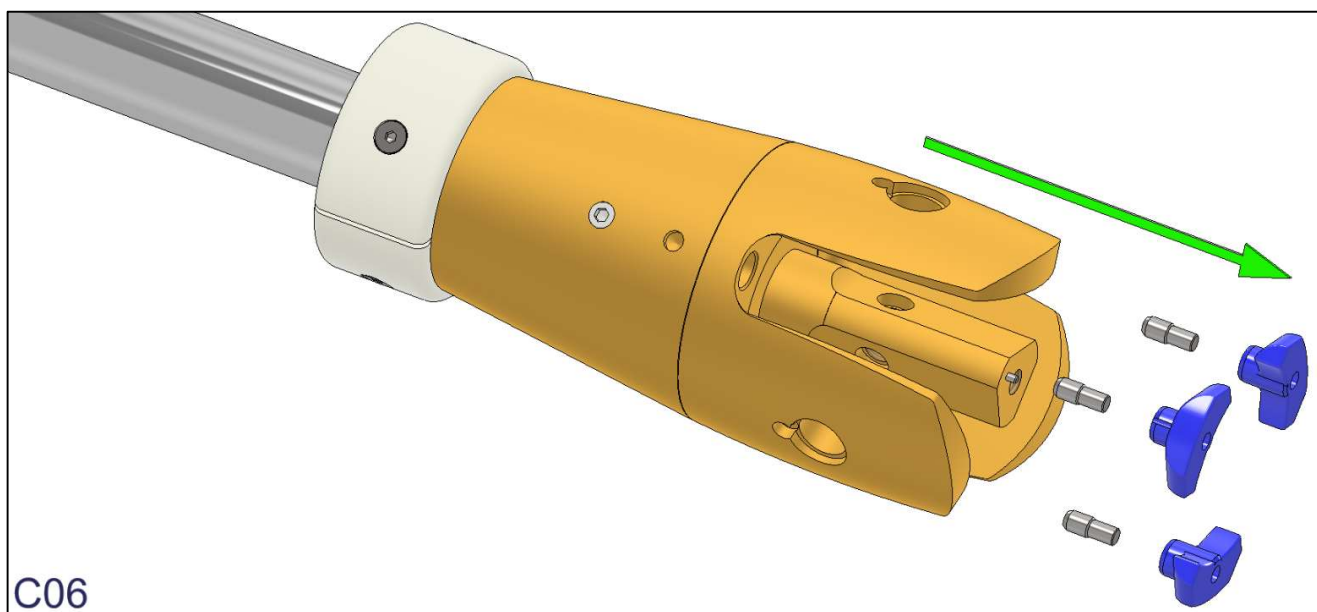
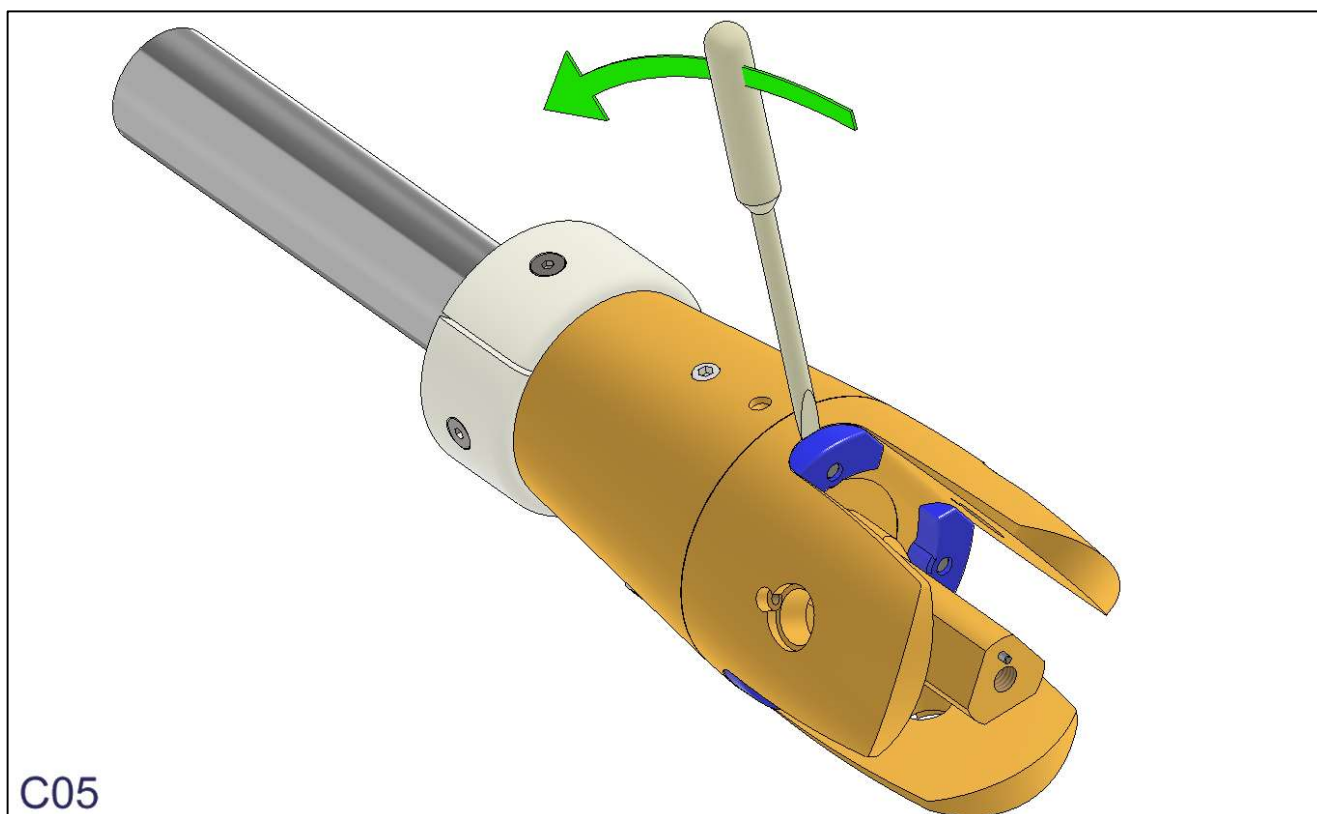

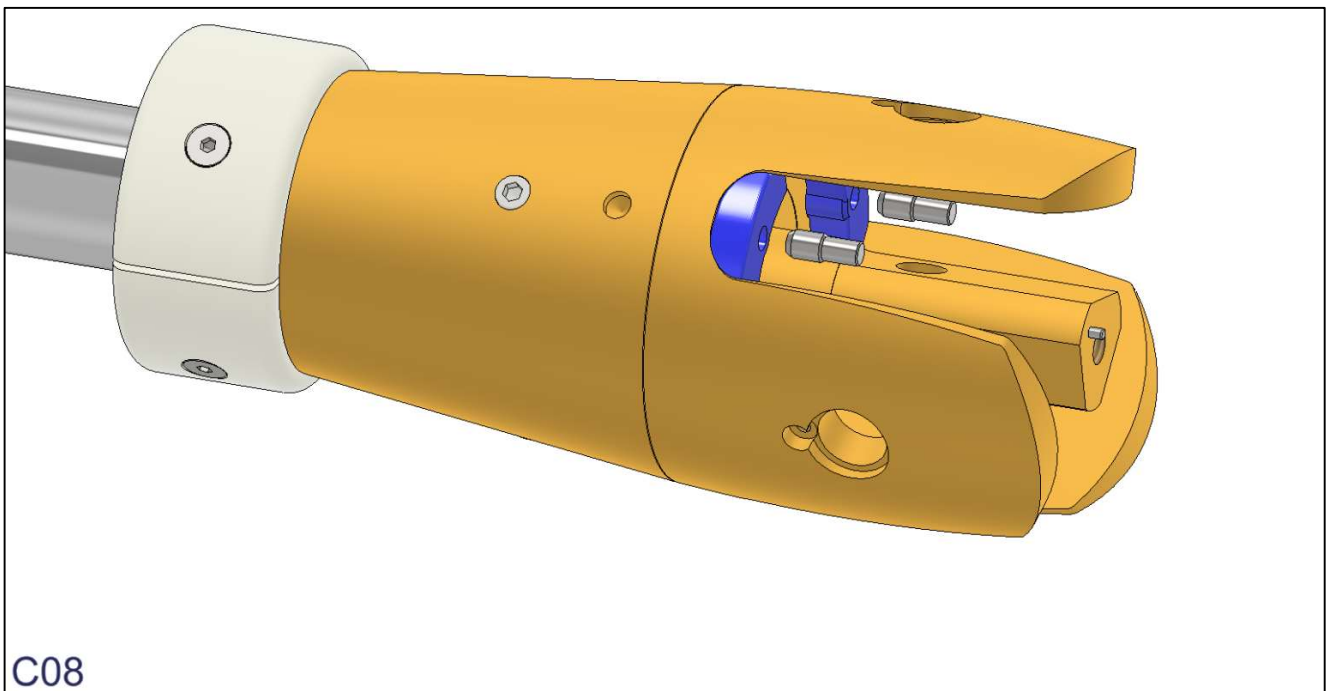
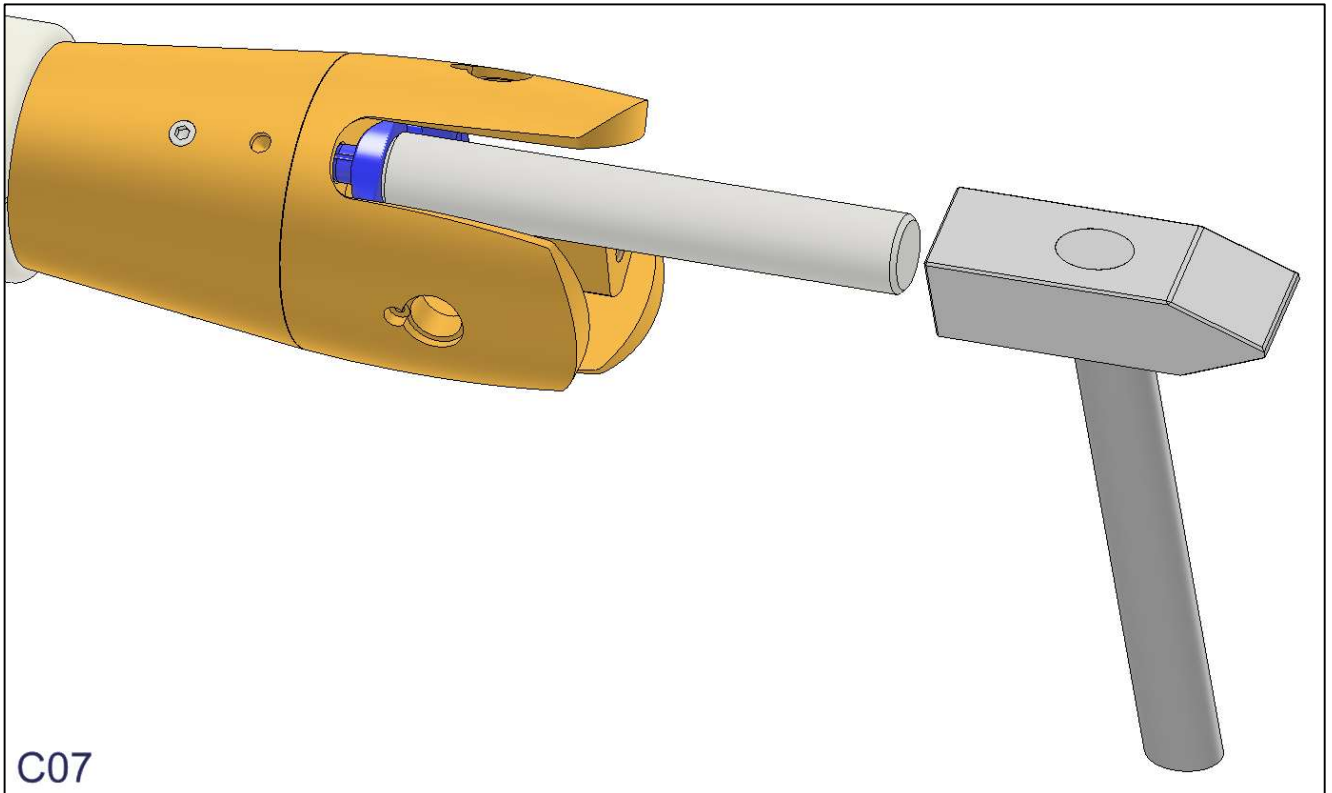

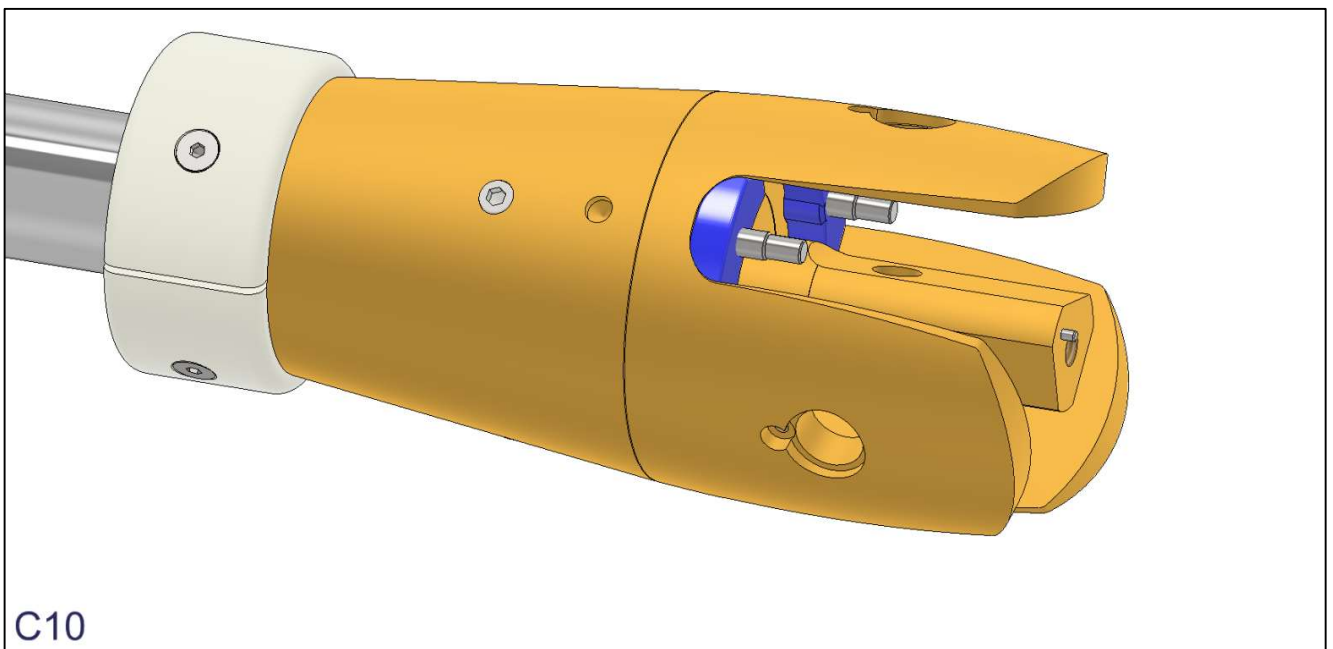
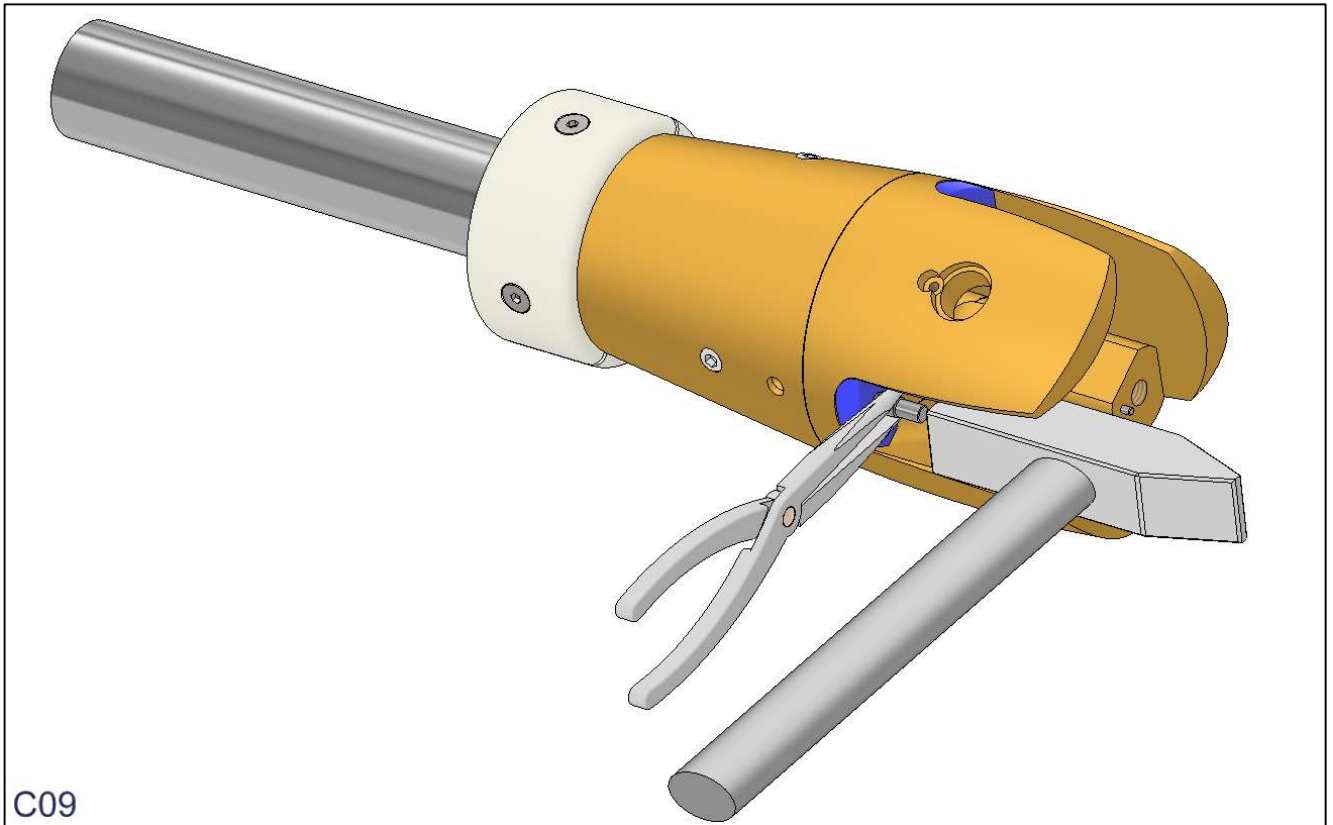

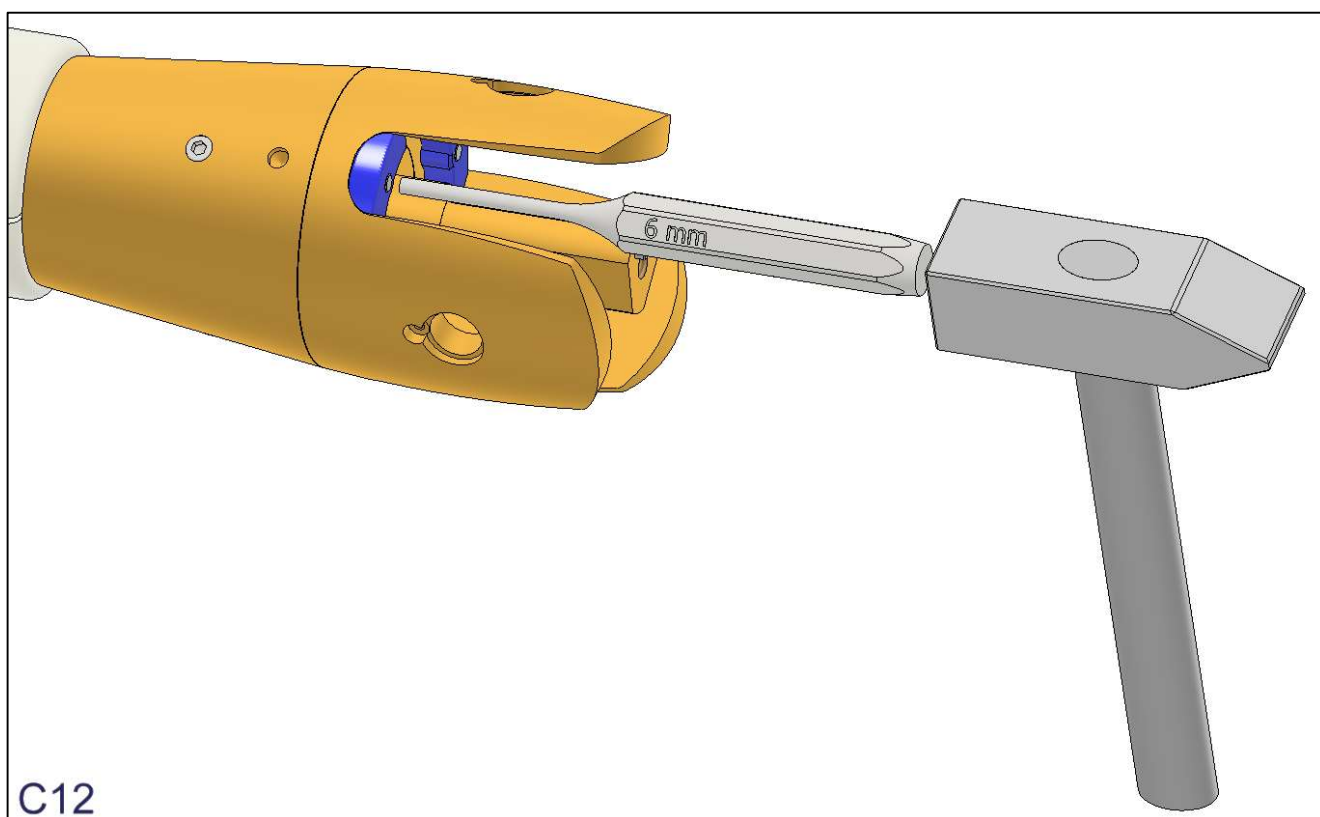
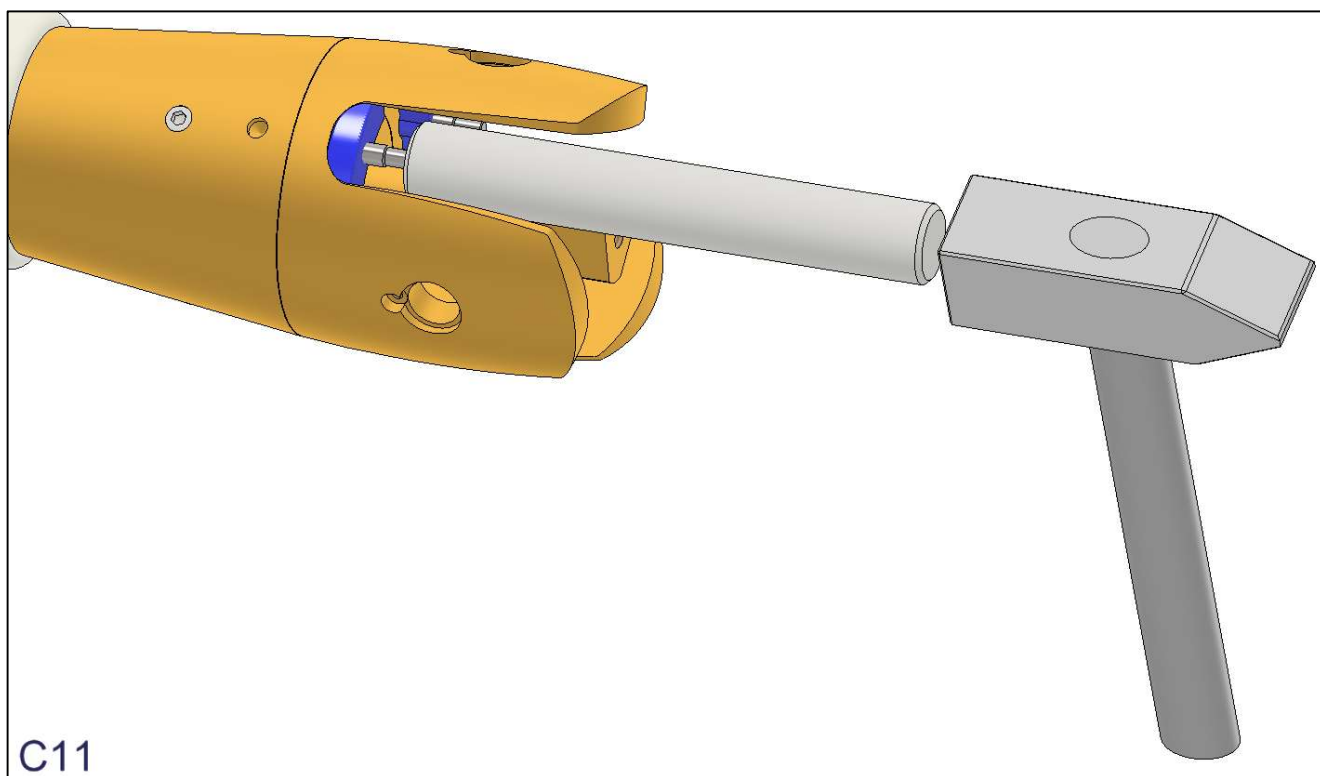

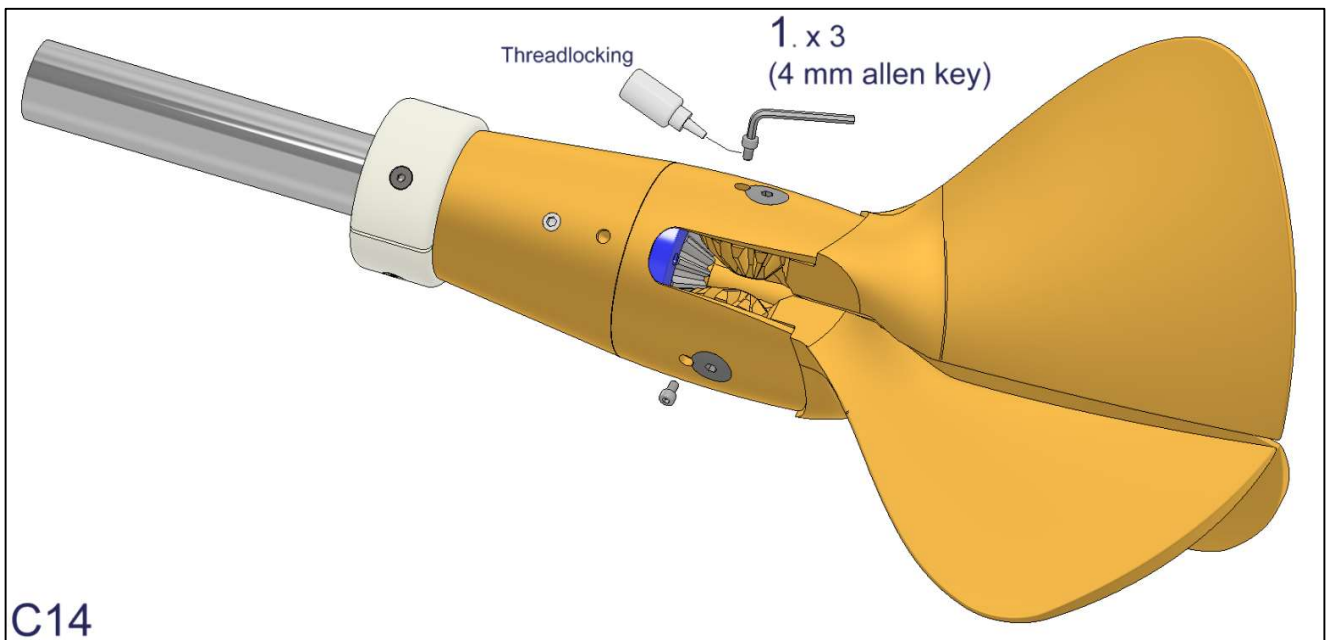
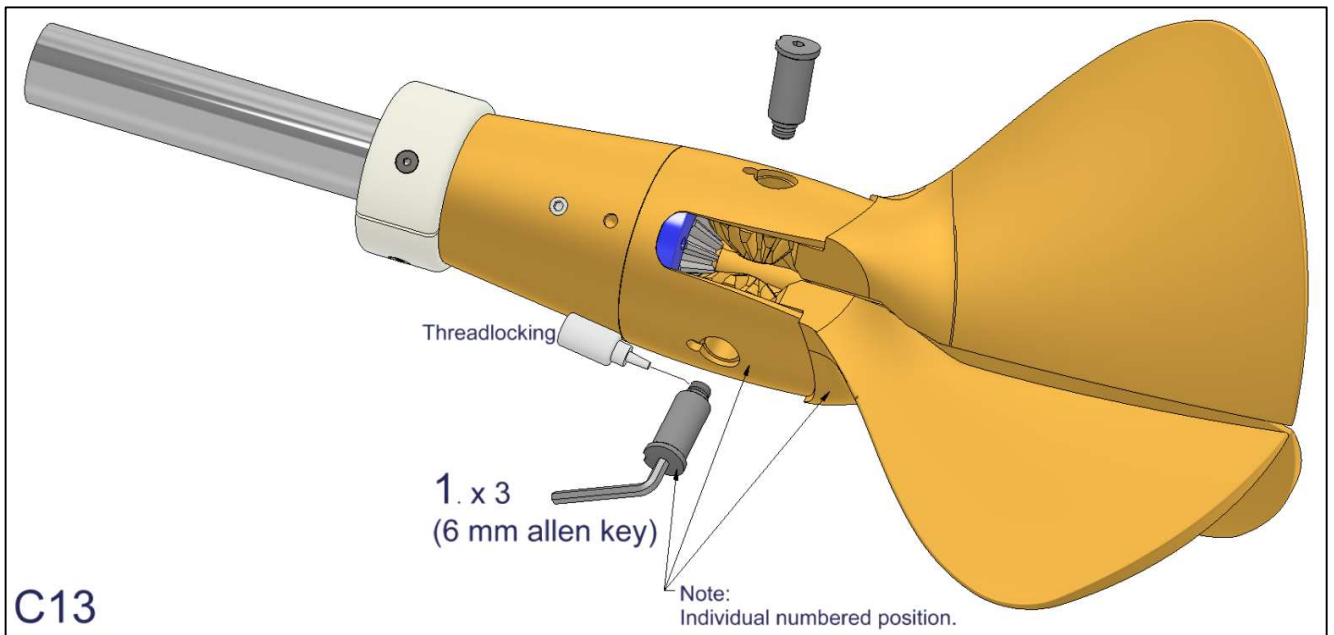

Exchange of “rubber blade stop” – (C)

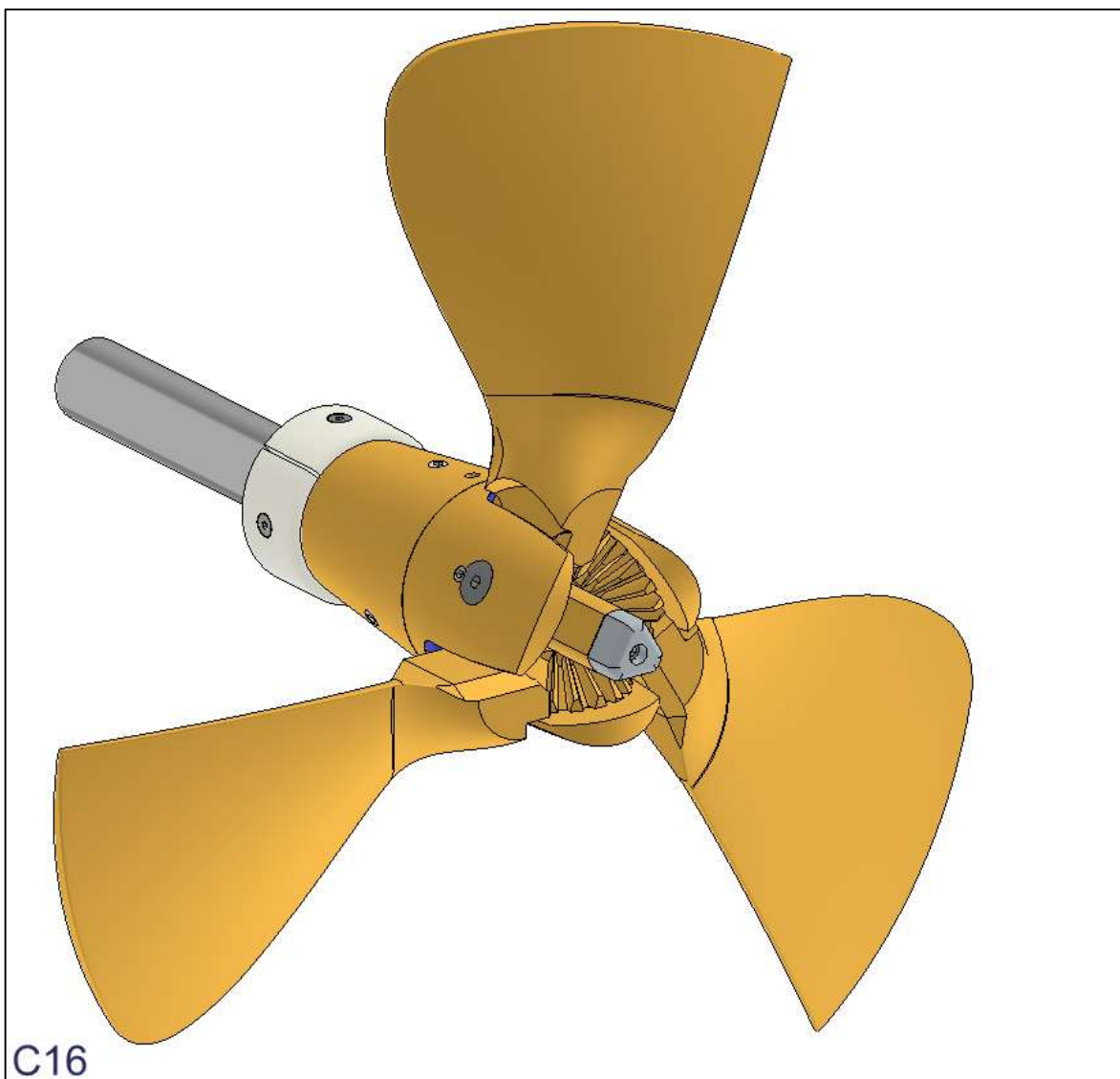
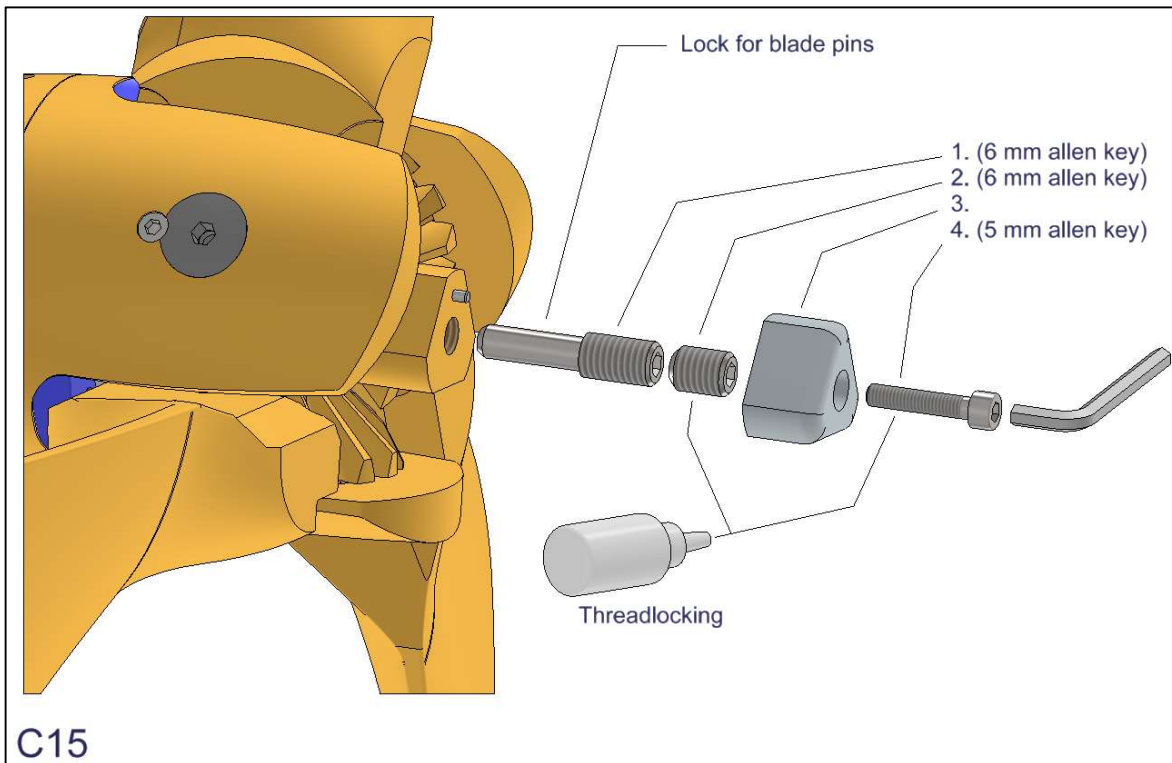

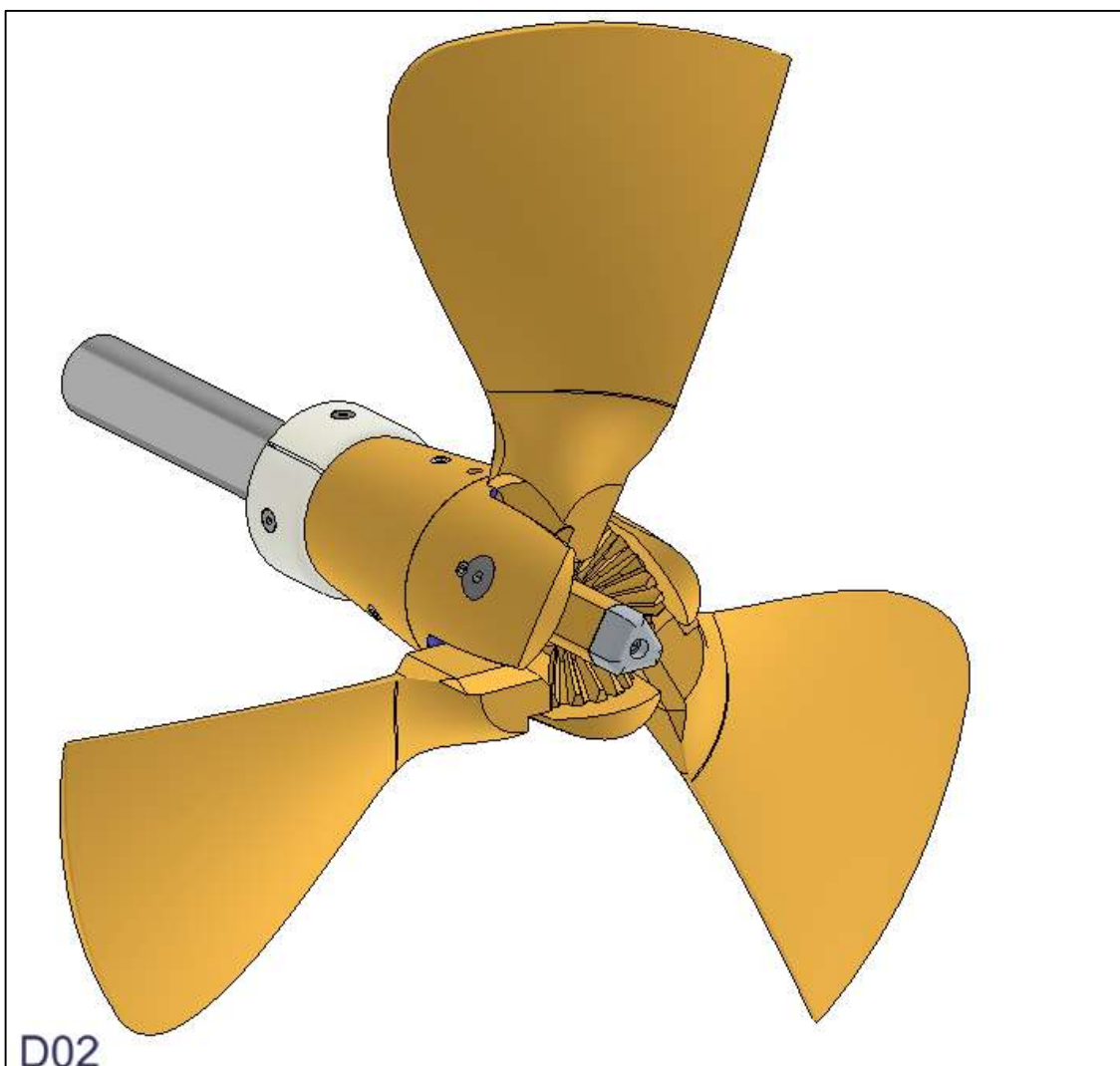
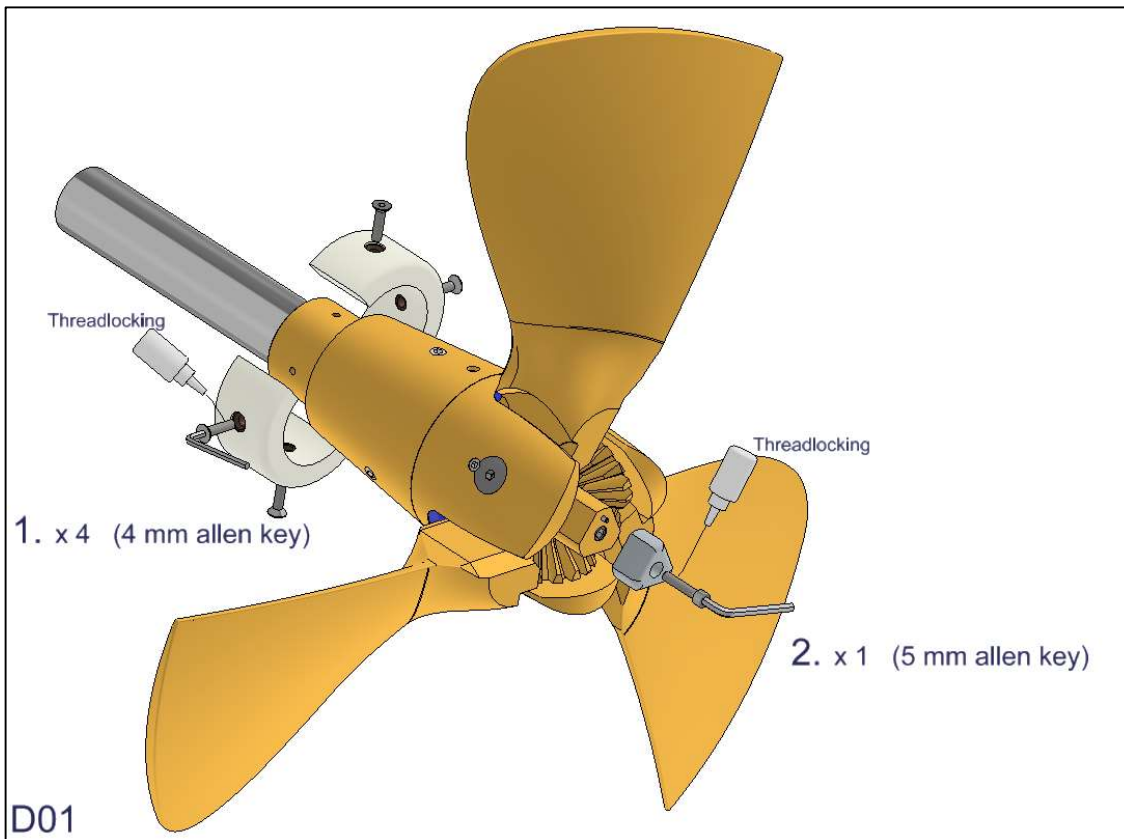

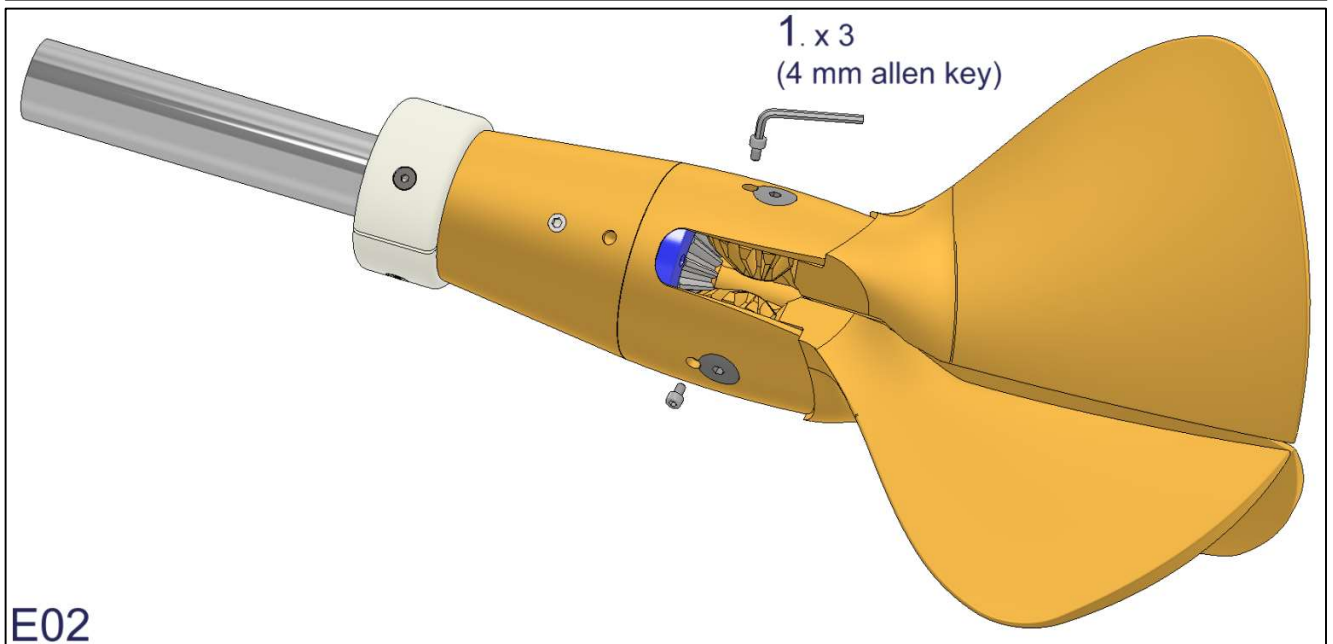
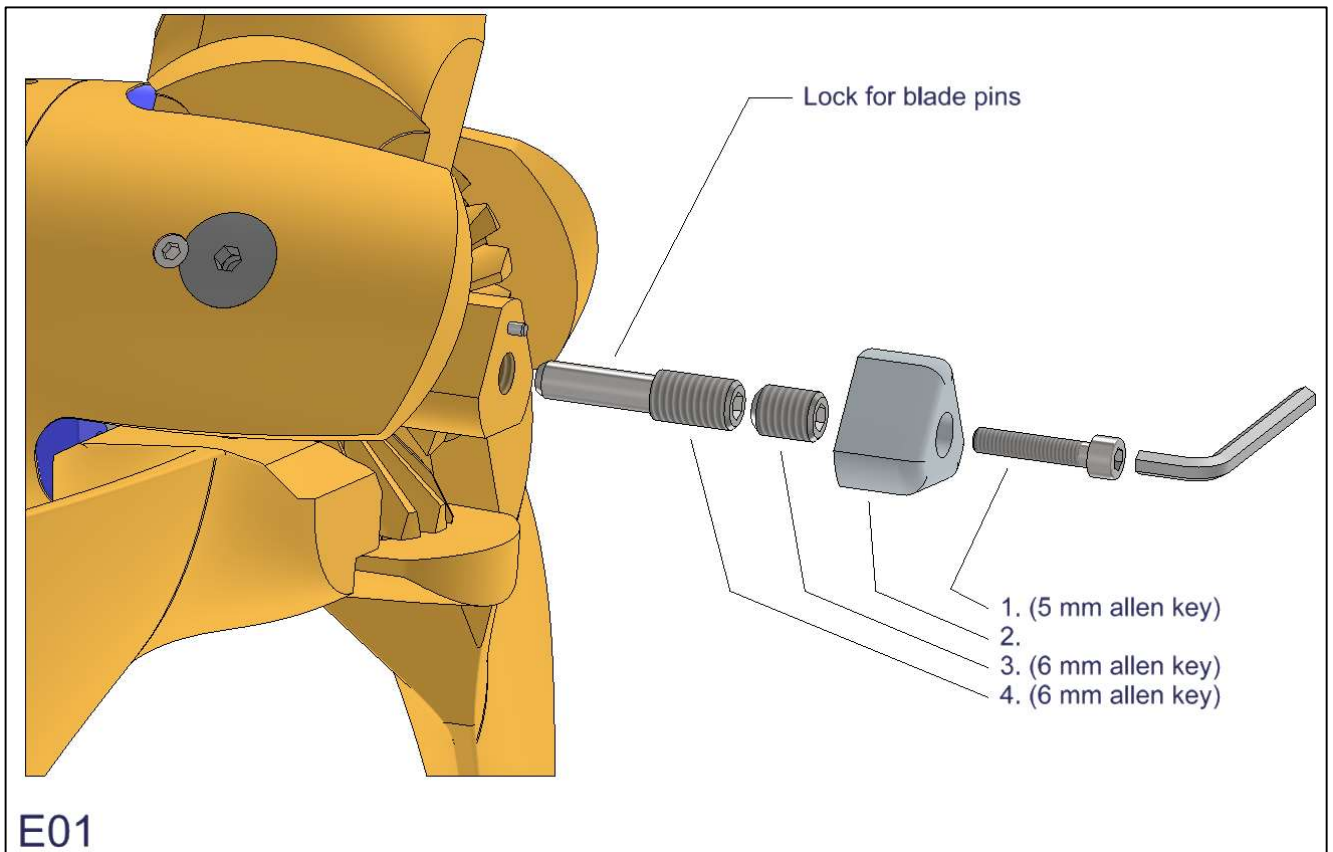

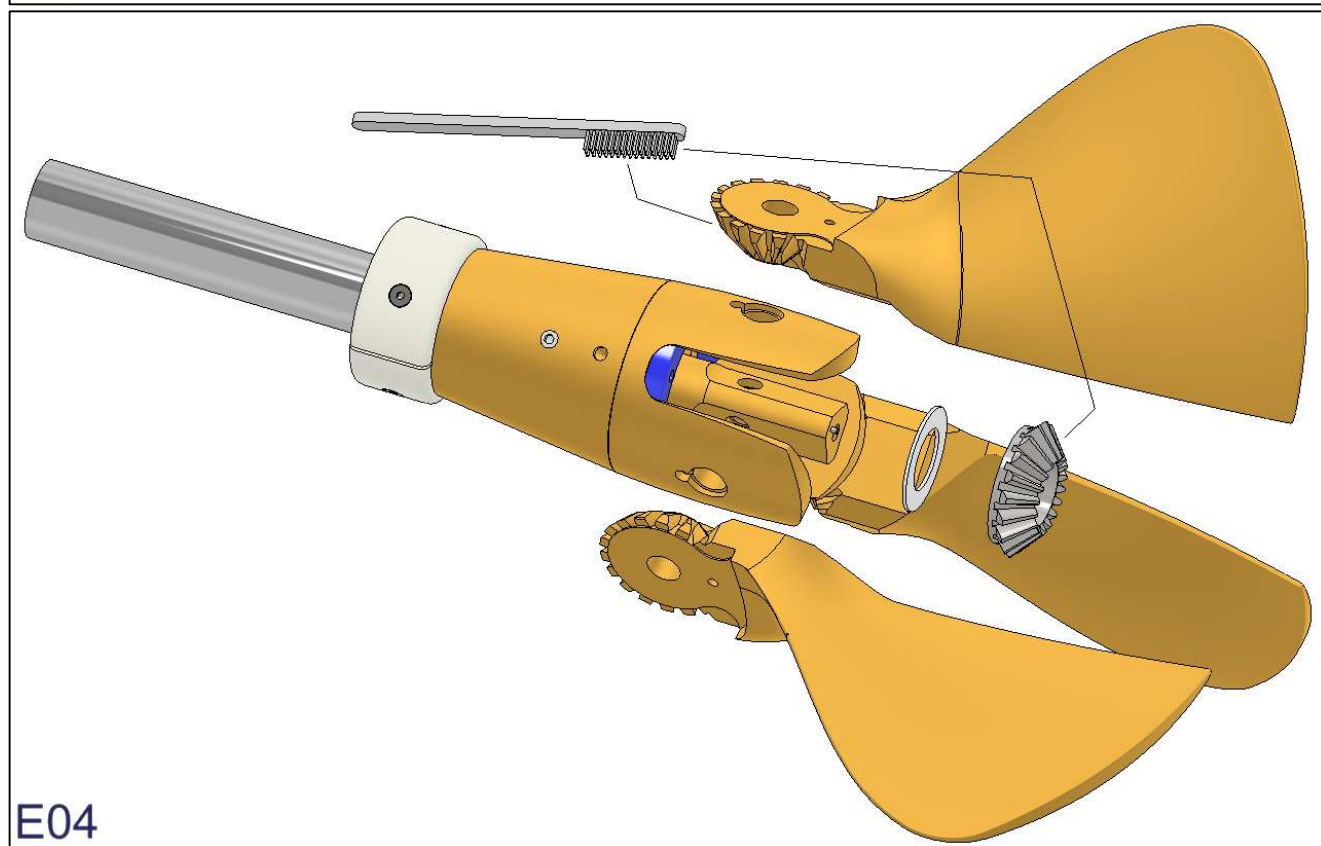
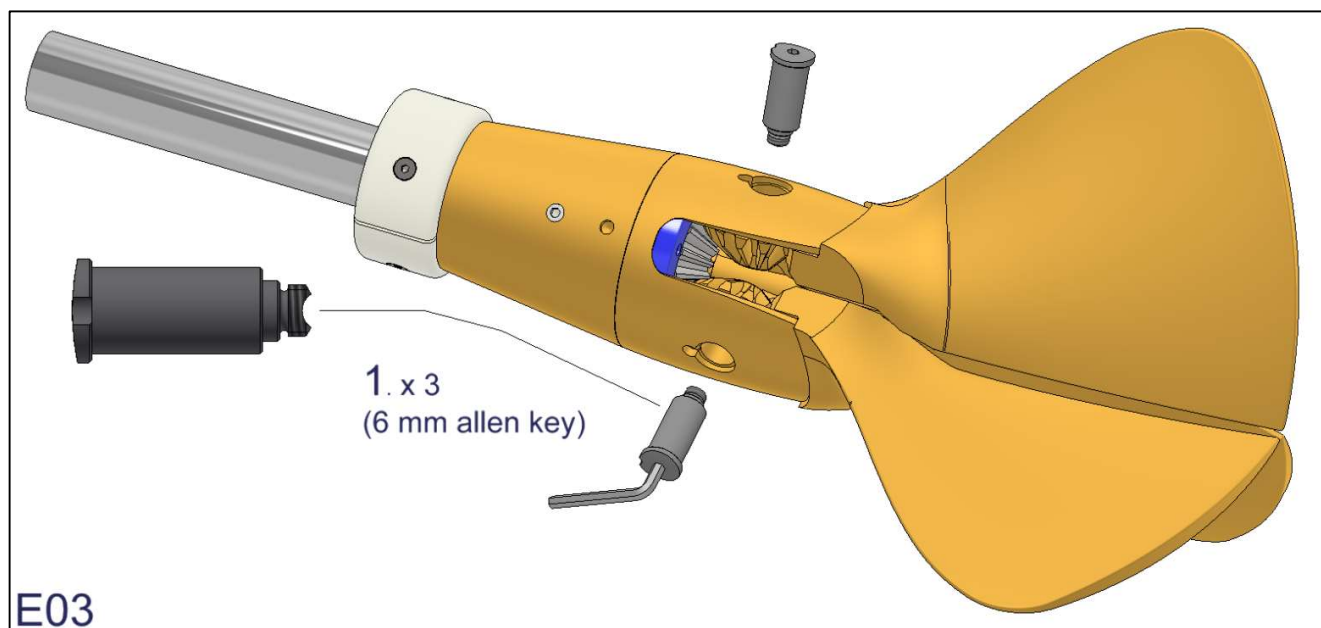

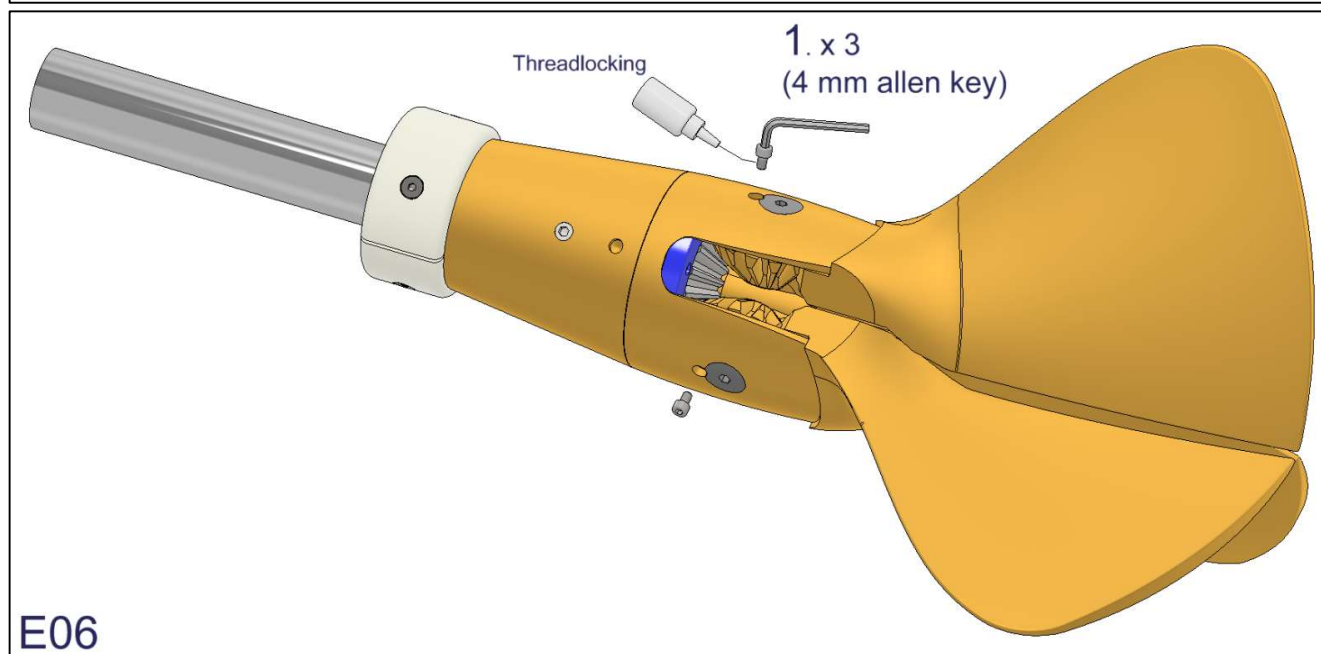
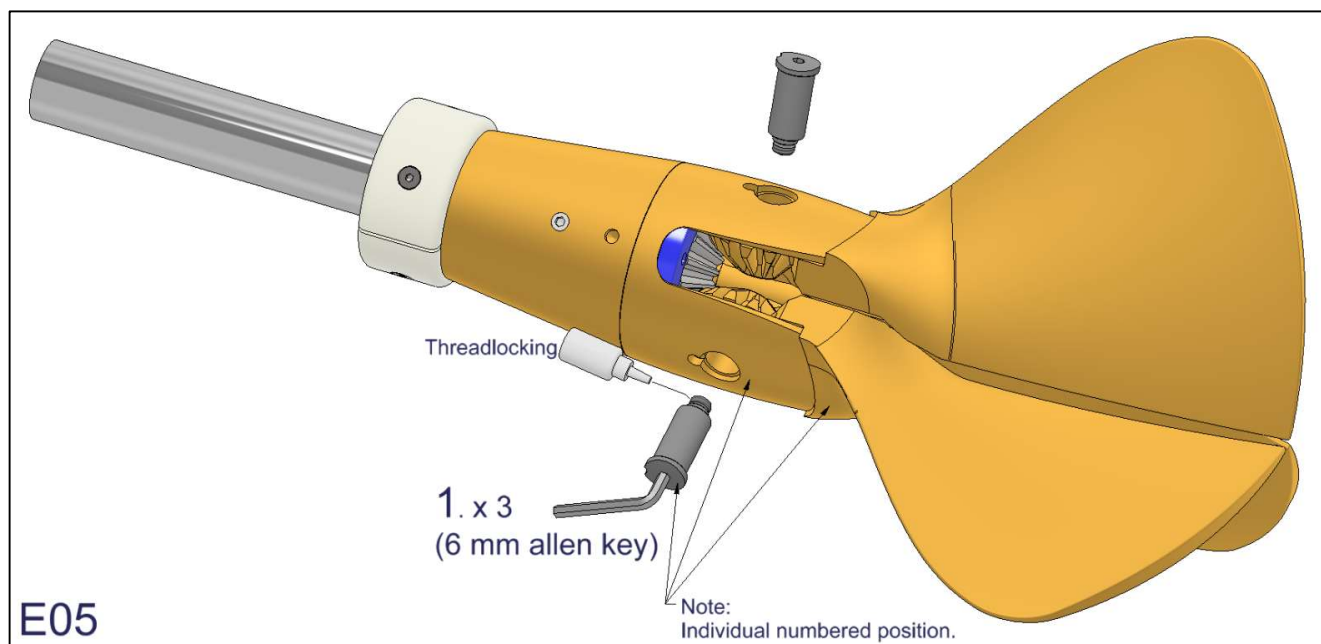

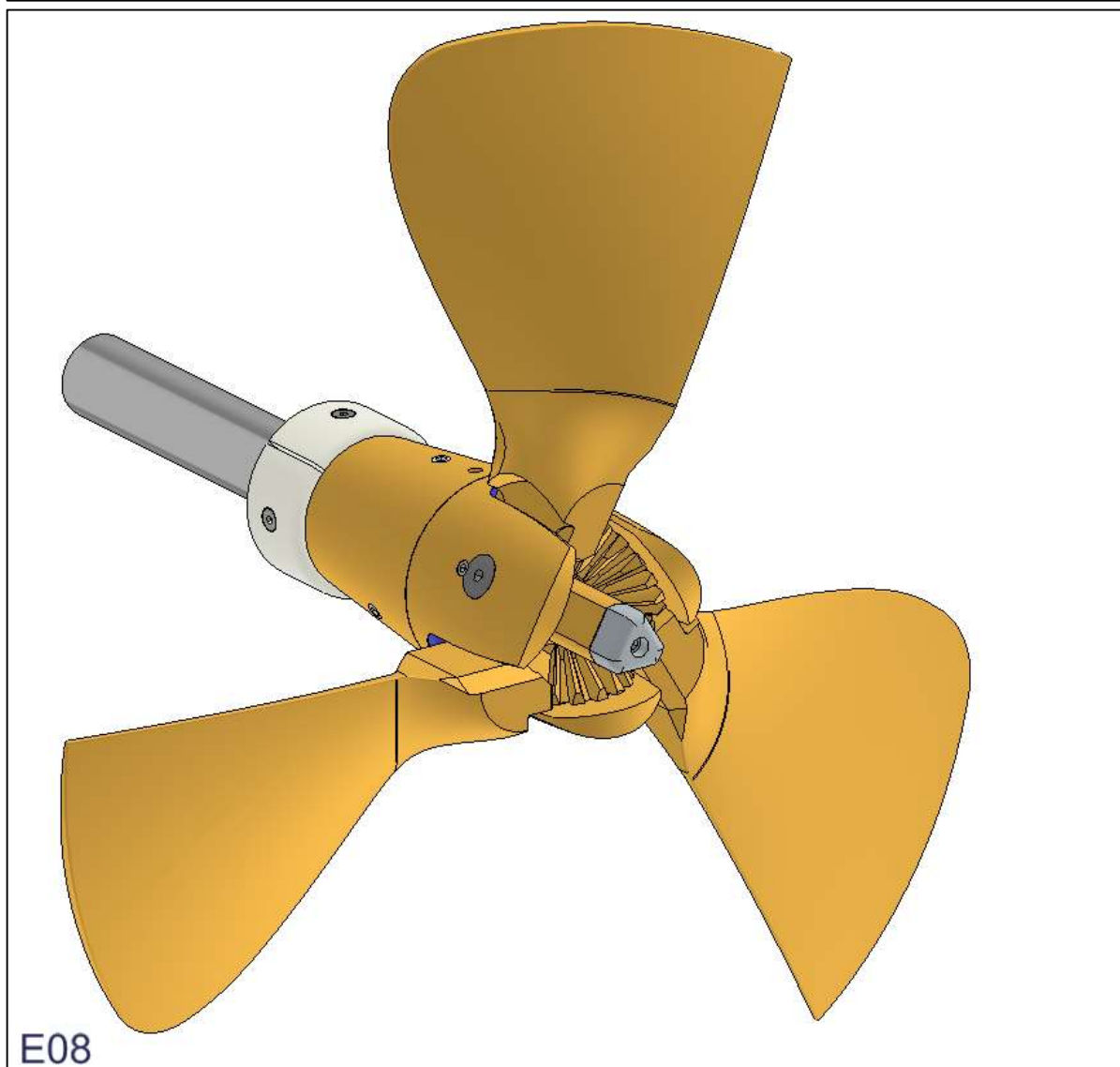
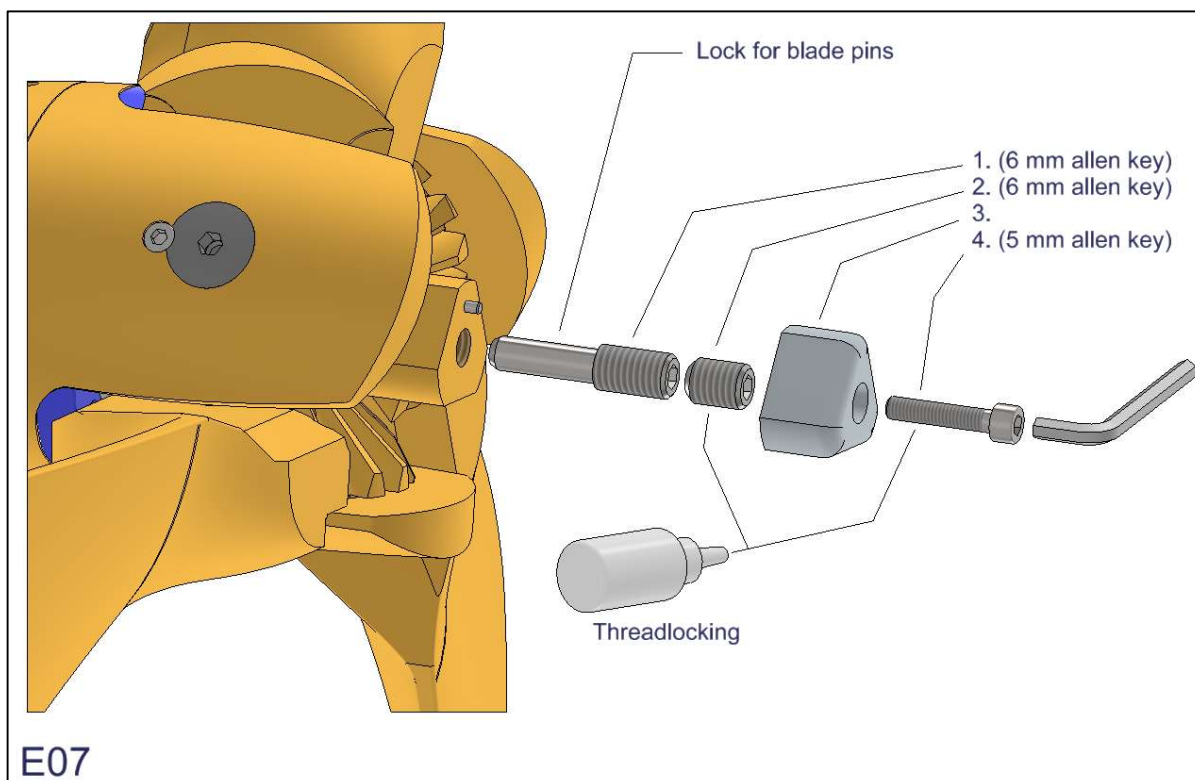

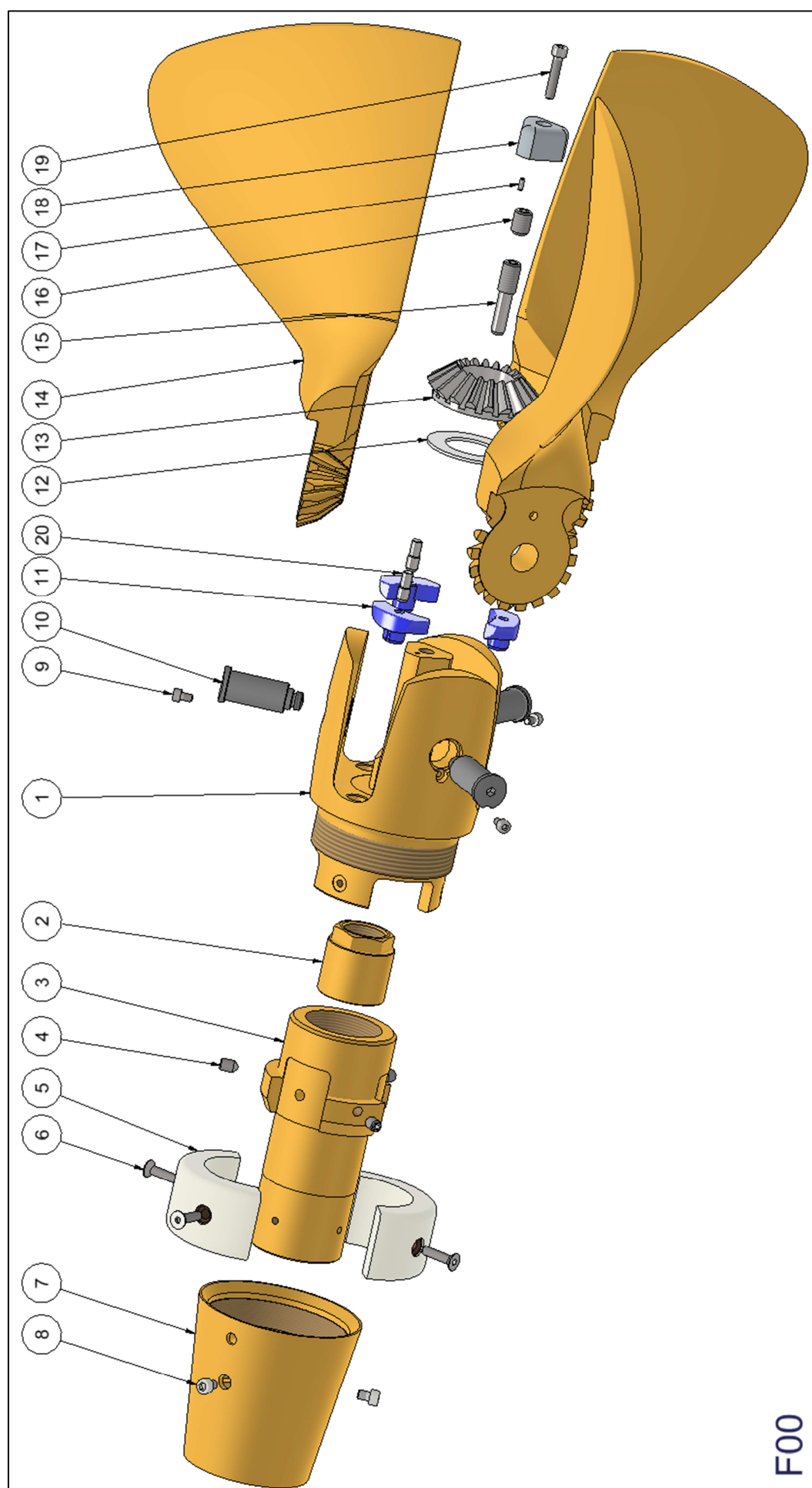

Size: 22" – 24" – 26"**Service set 1407410000**

ITEM	DK	GB	DE	STOCK NUMBER	QTY
18	Zinkanode - top	Zinc anode	Zink anode	1407400000	1
19	Skrue - Unbrako	Hex Socket Head Screw	Zylinderscherube mit Innensechskant	1509120630	1
104	Gevindsikring	Threadlocking	Schraubensicherung	1410000000	1
102	Unbrakonøgle - 5 mm	Allen key - 5 mm	Inbusschlüssel - 5 mm	1402100000	1

Service set 14746100SP

ITEM	DK	GB	DE	STOCK NUMBER	QTY
18	Zinkanode - top	Zinc anode	Zink anode	1407400000	1
19	Skrue - Unbrako	Hex Socket Head Screw	Zylinderscherube mit Innensechskant	1509120630	1
104	Gevindsikring	Threadlocking	Schraubensicherung	1410000000	1
102	Unbrakonøgle - 5 mm	Allen key - 5 mm	Inbusschlüssel - 5 mm	1402100000	1
11	Gummistopper	Rubber stop	Gummianschläge	14076000SP-2	3
20	Stift for gummistopper	Pin for rubber stop	Stift für gummianschläge	14076000SP2	3

Service set 14076100SP

ITEM	DK	GB	DE	STOCK NUMBER	QTY
11	Gummistopper	Rubber stop	Gummianschläge	14076000SP-2	3
20	Stift for gummistopper	Pin for rubber stop	Stift für gummianschläge	14076000SP2	3

Service set 1554000000

ITEM	DK	GB	DE	STOCK NUMBER	QTY
5	Zinkanode - ring	Zinc ring anode	Zinkring anode	1510560000	2
6	Undersænket skrue M6x25, A4	Flat Countersunk Head	Senkschraube	1179910625	4
104	Gevindsikring	Threadlocking	Schraubensicherung	1410000000	1
103	Unbrakonøgle - 4 mm	Allen key - 4 mm	Inbusschlüssel - 4 mm	1402000000	1

Size: 22" – 24" – 26"

ITEM	DK	GB	DE	STOCK NUMBER	QTY
1	Navtop	Blade housing	Nabenoberteil	3500000110	1
2	Møtrik*	Nut*	Mütter*	---	1
3	Konusdel	Tapered part	Kegel	3400000110	1
4	Pinol skrue M8x12 DIN914	Hex Socket Set Screw	Gewindestift	1401300000	3
5	Zinkanode	Zinc ring anode	Zinkring anode	1510560000	2
6	Undersænket skrue M6x25, A4	Flat Countersunk Head	Senkschraube	1179910625	4
7	Nav kappe	Hub shell	Nabenschale	3300000110z	1
8	Skrue M6x8 DIN912	Hex Socket Head	Cylinderschraube	1406800000	3
9	Skrue M5x8 DIN912	Hex Socket Head	Cylinderschraube	1406900000	3
10	Aksel til propelblade	Blade pins	Führungsbolzen	1513000000	3
11	Gummistopper	Rubber stop	Gummianschläge	14076000SP-2	3
12	Afstandsskive	Spacer	Abstandshalter	1403500000	1
13	Tandhjul	Gear-wheel	Zahnrad	1407200000	1
14	Propelblade 22" x 15" RH SP	Propeller blades 22" x 15" RH SP	Propellerblätter 22" x 15" RH SP	3122015001SP	3
14	Propelblade 22" x 16" RH SP	Propeller blades 22" x 16" RH SP	Propellerblätter 22" x 16" RH SP	3122016001SP	3
14	Propelblade 22" x 16" LH SP	Propeller blades 22" x 16" LH SP	Propellerblätter 22" x 16" LH SP	3122016002SP	3
14	Propelblade 22" x 17" RH SP	Propeller blades 22" x 17" RH SP	Propellerblätter 22" x 17" RH SP	3122017001SP	3
14	Propelblade 22" x 17" LH SP	Propeller blades 22" x 17" LH SP	Propellerblätter 22" x 17" LH SP	3122017002SP	3
14	Propelblade 22" x 18" RH SP	Propeller blades 22" x 18" RH SP	Propellerblätter 22" x 18" RH SP	3122018001SP	3
14	Propelblade 24" x 14" RH SP	Propeller blades 24" x 14" RH SP	Propellerblätter 24" x 14" RH SP	3124014001SP	3
14	Propelblade 24" x 15" RH SP	Propeller blades 24" x 15" RH SP	Propellerblätter 24" x 15" RH SP	3124015001SP	3
14	Propelblade 24" x 15" LH SP	Propeller blades 24" x 15" LH SP	Propellerblätter 24" x 15" LH SP	3124015002SP	3
14	Propelblade 24" x 16" RH SP	Propeller blades 24" x 16" RH SP	Propellerblätter 24" x 16" RH SP	3124016001SP	3
14	Propelblade 24" x 16" LH SP	Propeller blades 24" x 16" LH SP	Propellerblätter 24" x 16" LH SP	3124016002SP	3
14	Propelblade 24" x 17" RH SP	Propeller blades 24" x 17" RH SP	Propellerblätter 24" x 17" RH SP	3124017001SP	3
14	Propelblade 24" x 17" LH SP	Propeller blades 24" x 17" LH SP	Propellerblätter 24" x 17" LH SP	3124017002SP	3
14	Propelblade 24" x 18" RH SP	Propeller blades 24" x 18" RH SP	Propellerblätter 24" x 18" RH SP	3124018001SP	3
14	Propelblade 24" x 19" RH SP	Propeller blades 24" x 19" RH SP	Propellerblätter 24" x 19" RH SP	3124019001SP	3
14	Propelblade 24" x 20" RH SP	Propeller blades 24" x 20" RH SP	Propellerblätter 24" x 20" RH SP	3124020001SP	3
14	Propelblade 24" x 20" LH SP	Propeller blades 24" x 20" LH SP	Propellerblätter 24" x 20" LH SP	3124020002SP	3
14	Propelblade 24" x 21" RH SP	Propeller blades 24" x 21" RH SP	Propellerblätter 24" x 21" RH SP	3124021001SP	3
14	Propelblade 24" x 21" LH SP	Propeller blades 24" x 21" LH SP	Propellerblätter 24" x 21" LH SP	3124021002SP	3
14	Propelblade 26" x 16" RH SP	Propeller blades 26" x 16" RH SP	Propellerblätter 26" x 16" RH SP	3126016001SP	3
14	Propelblade 26" x 17" RH SP	Propeller blades 26" x 17" RH SP	Propellerblätter 26" x 17" RH SP	3126017001SP	3
14	Propelblade 26" x 18" RH SP	Propeller blades 26" x 18" RH SP	Propellerblätter 26" x 18" RH SP	3126018001SP	3
14	Propelblade 26" x 19" RH SP	Propeller blades 26" x 19" RH SP	Propellerblätter 26" x 19" RH SP	3126019001SP	3
14	Propelblade 26" x 21" RH SP	Propeller blades 26" x 21" RH SP	Propellerblätter 26" x 21" RH SP	3126021001SP	3
15	Låsebolt for aksel	Locking pin	Haltebolzen	1454000000	1
16	Pinolskrue M12 / M6	Hex Socket set screw M12 / M6	Gewindestift M12 / M6	1400600000	1
17	Cylinderstift ø3x8	Parallel Pin	Zylinderstift	1406600000	1
18	Zinkanode - top	Zinc anode	Zink anode	1407400000	1
19	Skrue M6x30 DIN912	Hex Socket Head Screw	Zylinderscherube mit Innensechskant	1509120630	1
20	Stift for gummistopper	Pin for rubber stop	Stift für gummianschläge	14076000SP2	3

*: Møtrik – bestilles kunde specifik; Nut – ordered cuttom specific; Mütter – kundenspezifisch bestellt

Propeller: 22" - 24" - 26"			
Torque settings for Gori shaft nuts in Nm			
	Norm Thread		Torque
	Diameter	Pitch	
	mm	mm	Nm
M20 x 2.5	19.6	2.5	91
M20 x 2	19.7	2	96
M20 x 1.5	19.7	1.5	102
7/8"-9 UNC	21,8	2.82	118
M24 x 3	23.6	3	135
M24 x 2	23.7	2	144
1"-8 UNC	25.0	3.18	151
1"-12 UNF	25.1	2.12	160
M27 x 2	26.7	2	198
1 1/8"-7 UNC	28,1	3,63	200
M30 x 2	29.7	2	245
1 1/4"-7 UNC	31,3	3,63	260
M33 x 2	32,7	2	305
M36 x 3	35.6	3	335
1 1/2"-6 UNC	37,6	4,23	335

Thread has to be greased

No grease on taper on shaft

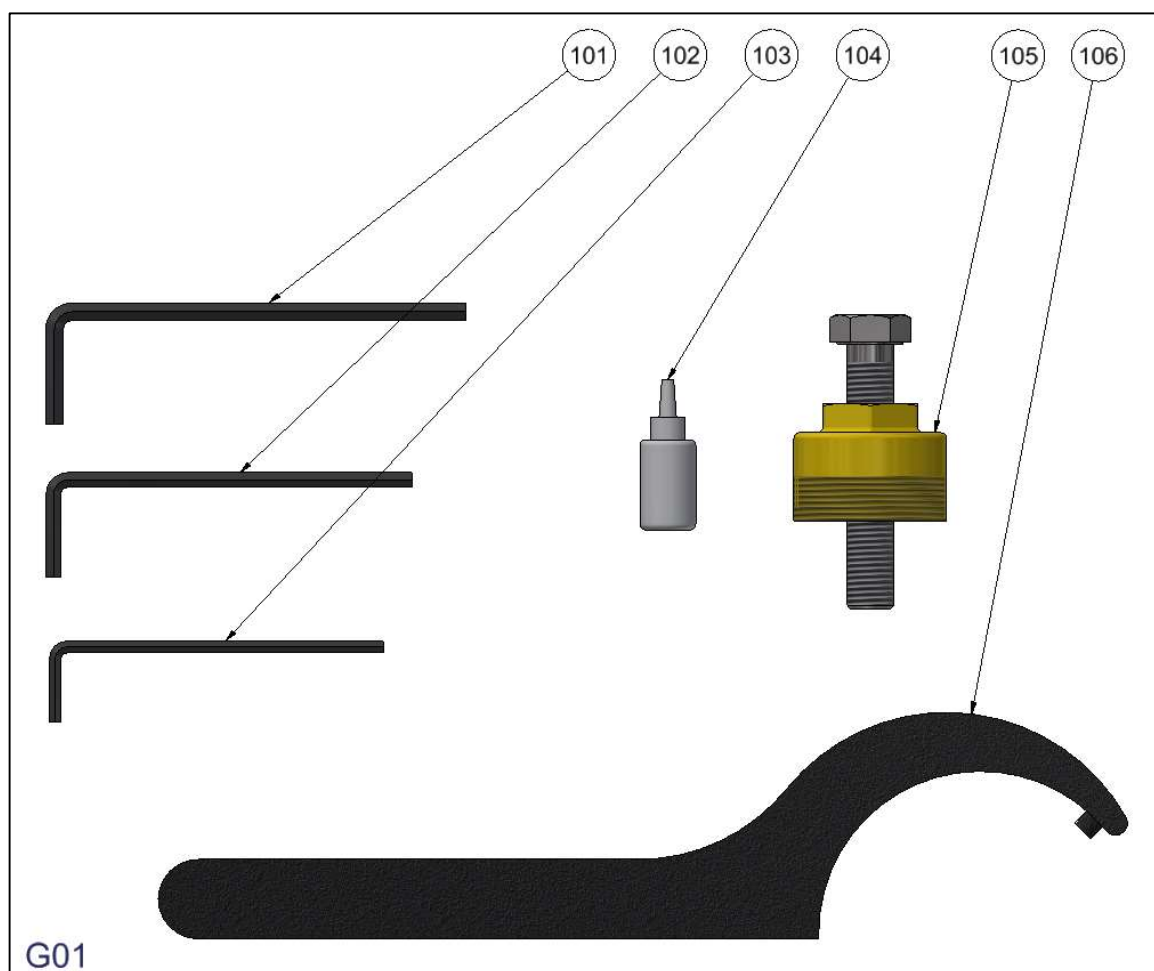

Size: 22" – 24" – 26"

ITEM	DK	GB	DE	STOCK NUMBER
101	Unbrakonøgle - 6 mm	Allen key - 6 mm	Inbusschlüssel - 6 mm	1402100000
102	Unbrakonøgle - 5 mm	Allen key - 5 mm	Inbusschlüssel - 5 mm	1402100000
103	Unbrakonøgle - 4 mm	Allen key - 4 mm	Inbusschlüssel - 4 mm	1402000000
104	Gevindsikring	Threadlocking	Schraubensicherung	1410000000
105	Aftrækker med bolt	Puller	Abzieher	1528000000
106	Hagenøgle -110	C-Spanner	Hagenschüssel	1406300000

23052024

Gori propeller A/S

Fjordagervej 34-36

DK-6100 Haderslev

www.bsidk.com/gori-propeller/