

Propeller 15" – 16,5" Overdrive for shaft

- 1) OPERATING INSTRUCTIONS 3-blade Gori Folding Overdrive Propeller
- A) Disassemble complete propeller hub for mounting
- B) Assemble hub on shaft
- C) Exchange of "rubber blade stop"
- D) Exchange of "zinc anodes"
- E) Cleaning of "Gearwheel"
- F) Service sets & Spare Parts List
- G) Supplied Tools

DK

Læs instruktionen før der arbejdes med propellen.

Vigtigt!

Udskift zink hvis de er korroderet mere end 50%.

Advarsel!

Pas på skarpe kanter.

GB

Read the Instructions before any work on the propeller.

Important!

Replace Zinc if eroded more than 50%.

Warning!

Beware of sharp edges.

D

Bitte die Anweisung lesen, bevor Sie mit dem Propeller arbeiten.

Wichtig!

Zinkteile auswechseln, wenn sie mehr als 50% korrodiert sind.

Warnung!

Achten Sie auf die scharfe Kanten.

F

Lire les instructions avant toute intervention sur l'hélice

Important!

Remplacer l'anode zinc si elle est corrodé à plus de 50%

Attention!

Attention aux bords coupants

IT

Leggere attentamente le Istruzioni prima di qualsiasi operazione sull'elica.

Importante!

Sostituire l'anodo di zinco se usurato più del 50%

Avvertenza!

Prestare attenzione alle parti taglienti

ESP

Lea las instrucciones antes de efectuar cualquier trabajo en la hélice.

¡ Importante !

Reemplazar el ánodo si observa mas de un 50 % de corrosión.

¡ Advertencia !

Tenga cuidado con las esquinas afiladas.

OPERATING INSTRUCTIONS 3-blade Gori Folding Overdrive Propeller

CONGRATULATIONS on choosing the 3-blade Gori Folding Propeller.

The 3-blade Gori folding overdrive propeller has been designed in such a way that if the propeller is in "overdrive" position, the boat will attain approximately the same speed at lower engine revolutions.

Do not press the engine to the utmost as this will result in overloading.

Do only use the overdrive function when motoring in calm weather and when using the engine under sail.

Gori Propeller disclaim the responsibility for any damage caused by overloading the engine. In case of doubt about the loading of the engine, you should contact the authorised engine service organisation and Gori Propeller.

Under sail

When sailing under sail the blades usually fold, however, you should put the lever in reverse if the engine is not turned on. This will lock the shaft and ensure that the propeller folds and does not spin.

Ahead

The propeller usually opens in forward position unless the boat has just been in reverse.

If you want to shift from "overdrive" to forward position, the lever will have to be put into neutral when the boat does more than 1 knot ahead, until the blades have folded again. Then in forward position again.

In case of harbour manoeuvres the propeller might get into "overdrive" position. Therefore, before leaving the harbour, please always check the position of the propeller by means of the tachometer so that the propeller is in the wanted position.

Astern

In the reverse position the blades swing 180° opposite the forward position which ensures the same blade leading edge and profile – resulting in high efficiency. If the boat has not been used for some time, you should shift cautiously between forward and reverse a few times before sailing in order to clean the teeth of the blades and the gears from fouling.

Ahead "Overdrive"

In order to position the propeller in forward "overdrive" it is necessary to move the boat astern so that the blades are kept in reverse position when the lever is put into forward. Do not try to make the propeller go from forward to "overdrive" position by quick shifts with the lever when the boat is sailing ahead in the water.

Before going sailing, check that the propeller works in both forward and reverse.

WARNING !

- **Do not start the engine when the boat is out of the water.**
- **The propeller has sharp edges. Be careful not to cut your fingers !**
- **Make sure that the propeller blades do not suddenly open or close and trap your fingers for example.**
- **Do not turn the propeller/engine shaft until the boat is in the water.**
- **Stop the engine before diving or swimming in the vicinity of the boat.**
- **The propeller blades are like knives and can cause considerable damage when rotating. Be careful!**
- **Do not attempt to remove fishing net or ropes from the propeller when the engine is in motion.**
- **Check that the propeller works in both forward and reverse before starting each trip.**
- **If any strange sounds or vibration are noticed coming from the propeller, stop the engine immediately and solve the problem.**
- **In case of problems in connection with the mounting, use or function of the propeller, contact Gori Propeller or the importer in your country.**

Disassemble complete propeller hub for mounting – (A)

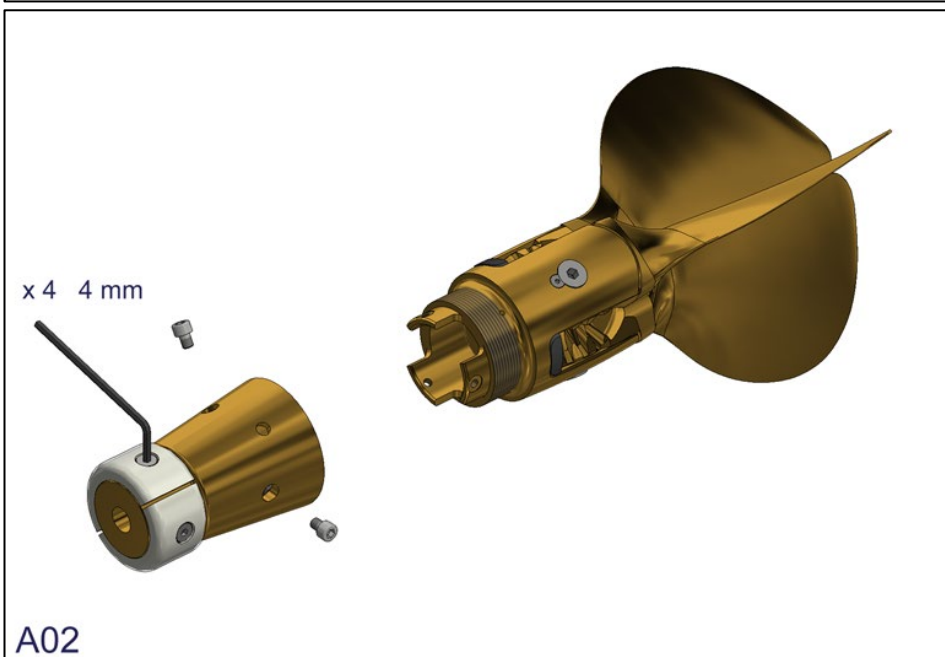
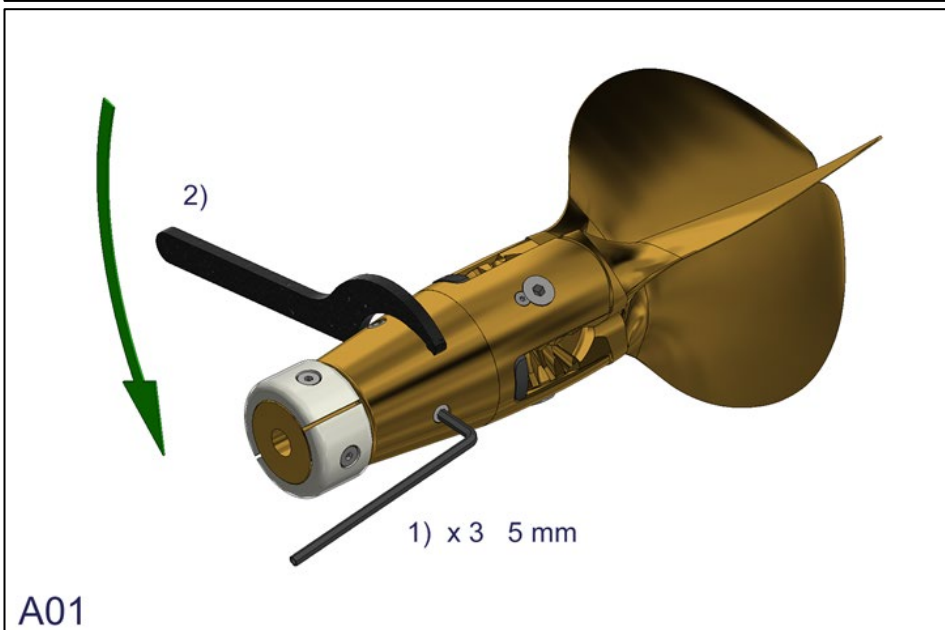
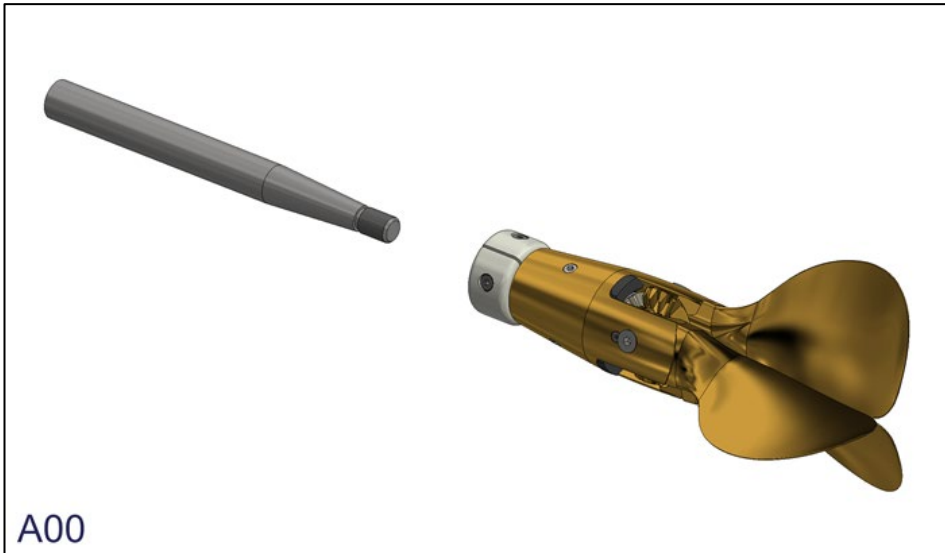

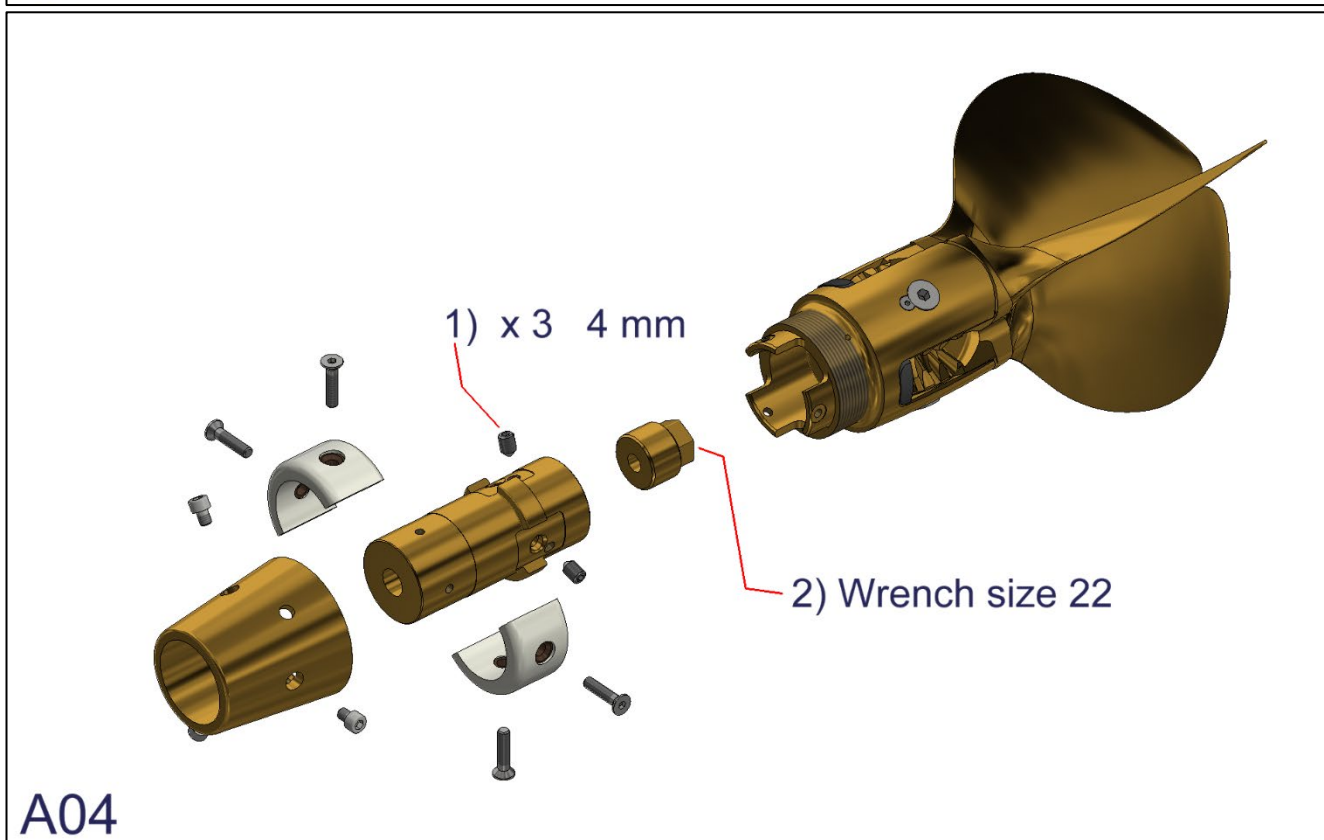
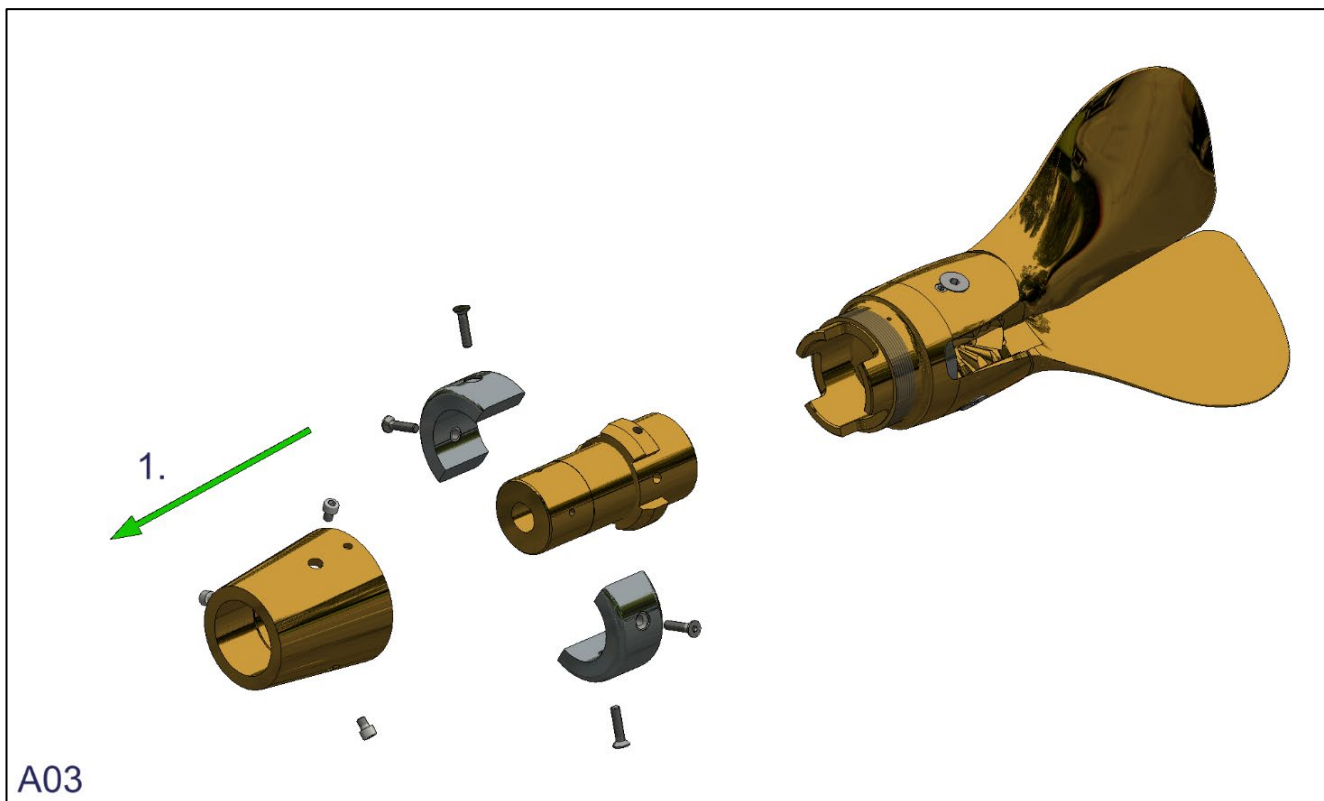

Assemble hub on shaft – (B)

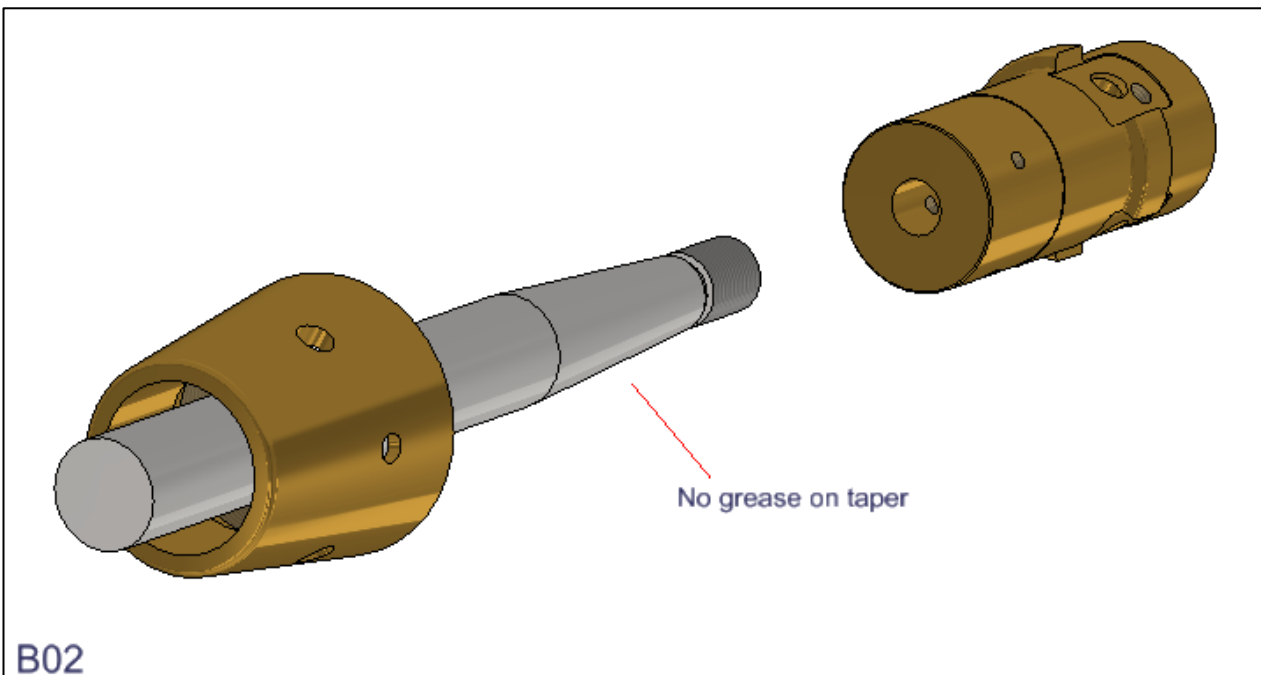
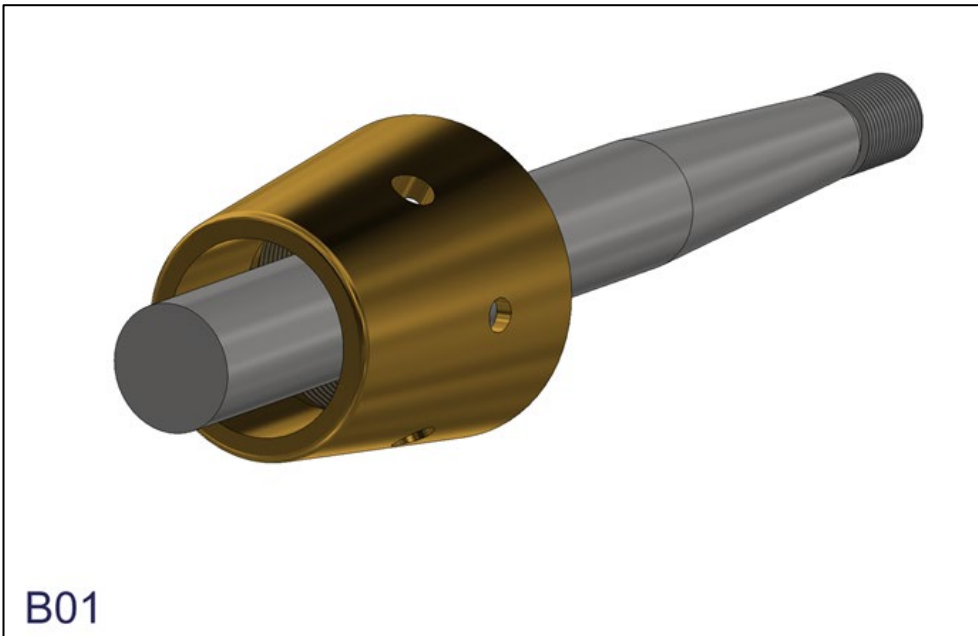
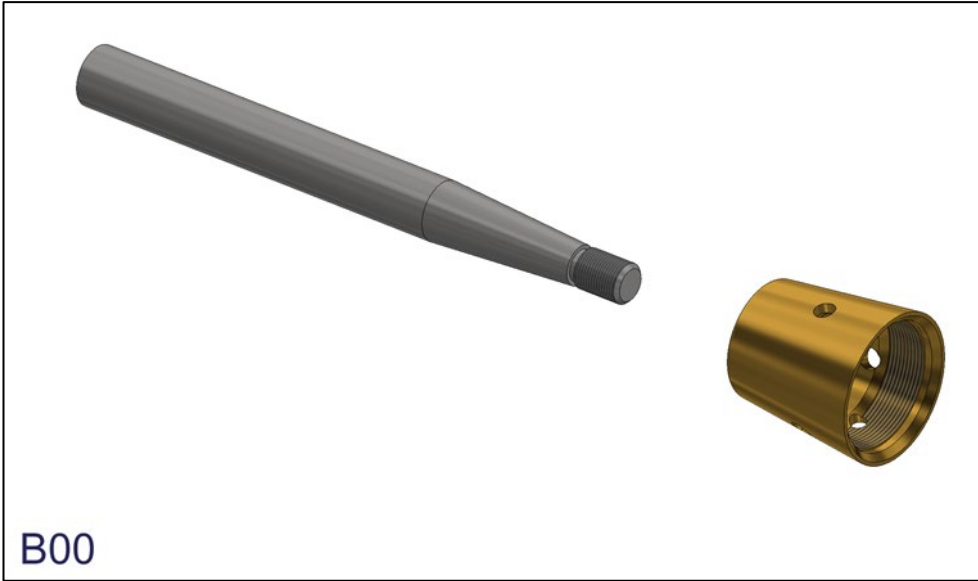

Assemble hub on shaft – (B)

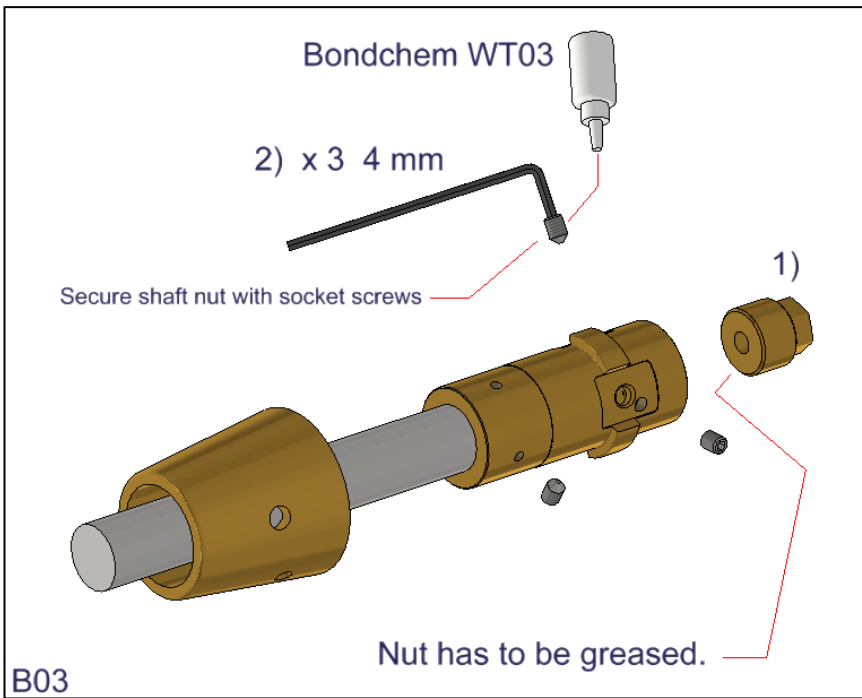

Propeller: 15" - 16,5"

Torque settings for Gori shaft nuts in Nm

	Norm Thread		Torque
	Diameter	Pitch	
	mm	mm	Nm
5/8"-11 UNC	15.5	2.31	52
M16 x 2	15.7	2	53
M16 x 1.5	15.7	1.5	57
3/4"-10 UNC	18.7	2.54	81
M20 x 2.5	19.6	2.5	91
M20 x 2	19.7	2	96

Thread has to be greased

No grease on taper on shaft

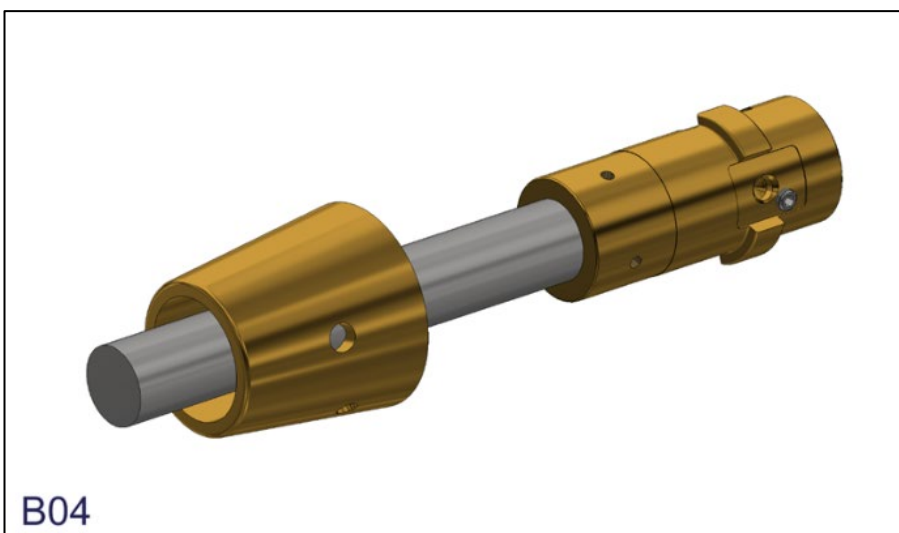

Assemble hub on shaft – (B)

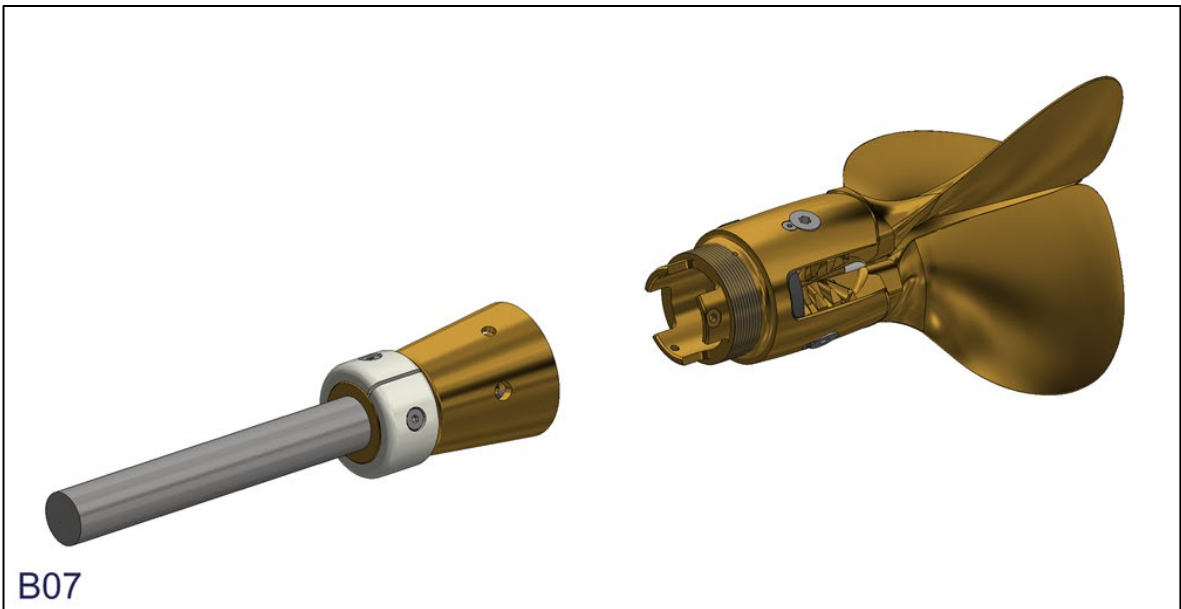
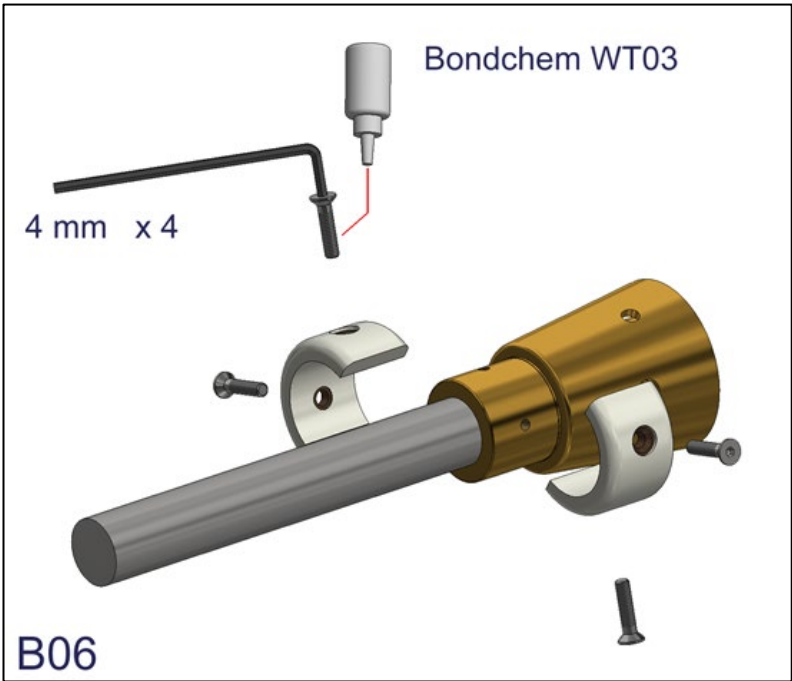
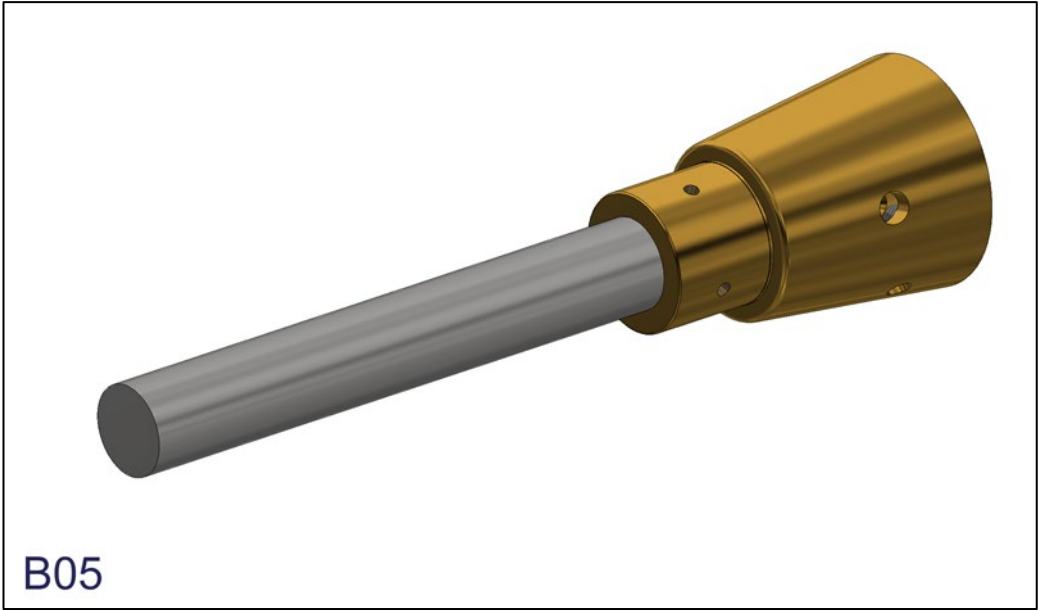

Assemble hub on shaft – (B)

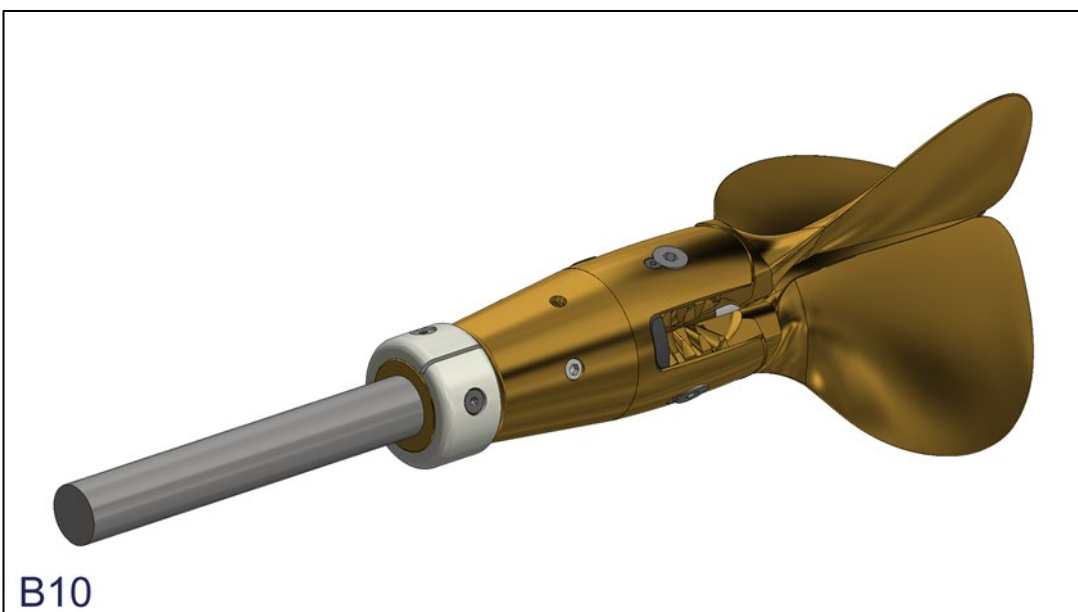
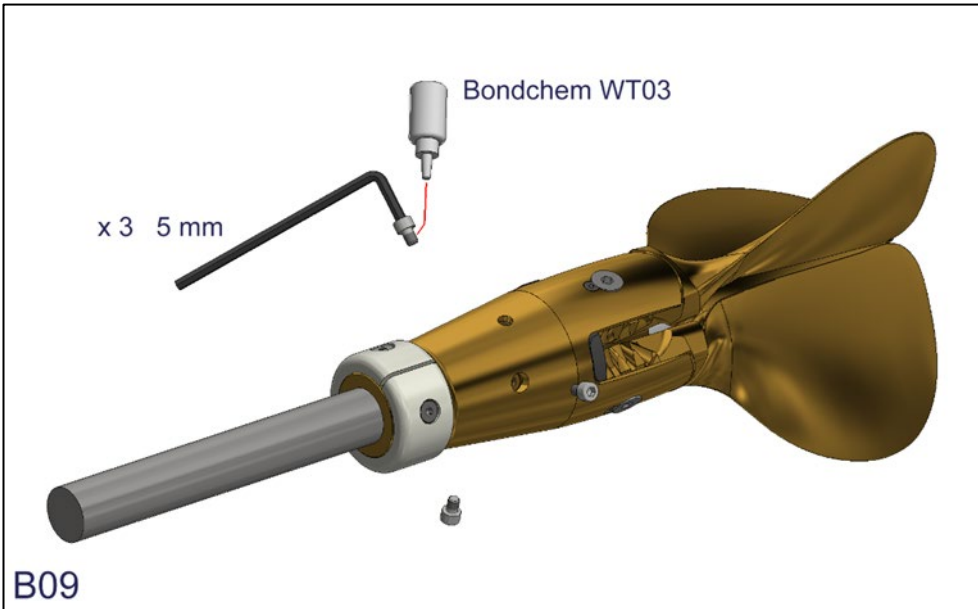
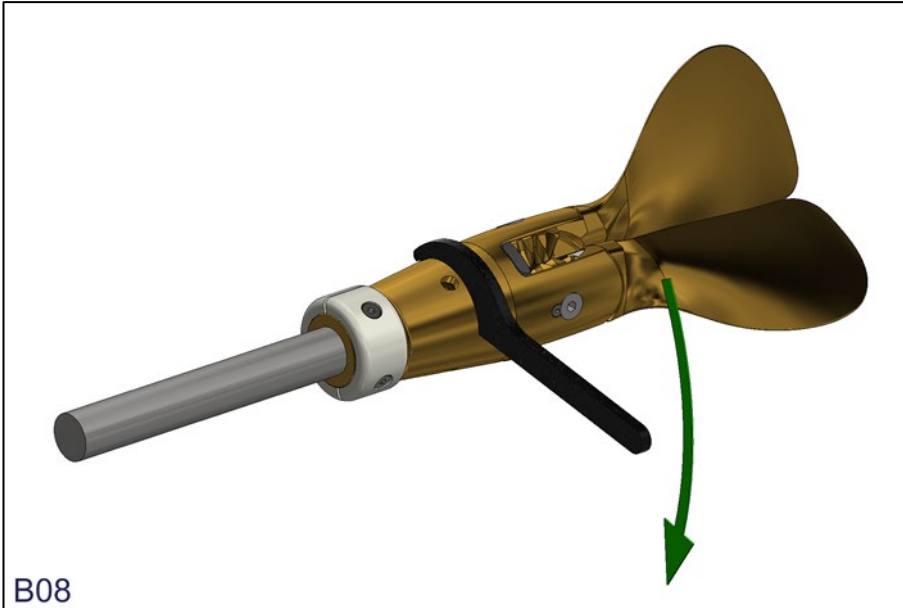

Exchange of "rubber blade stop" – (C)

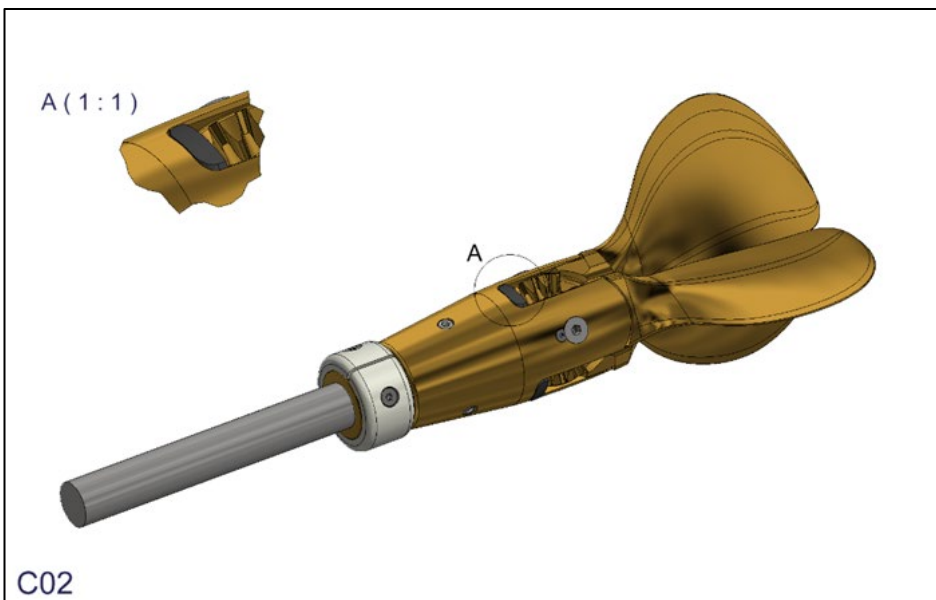
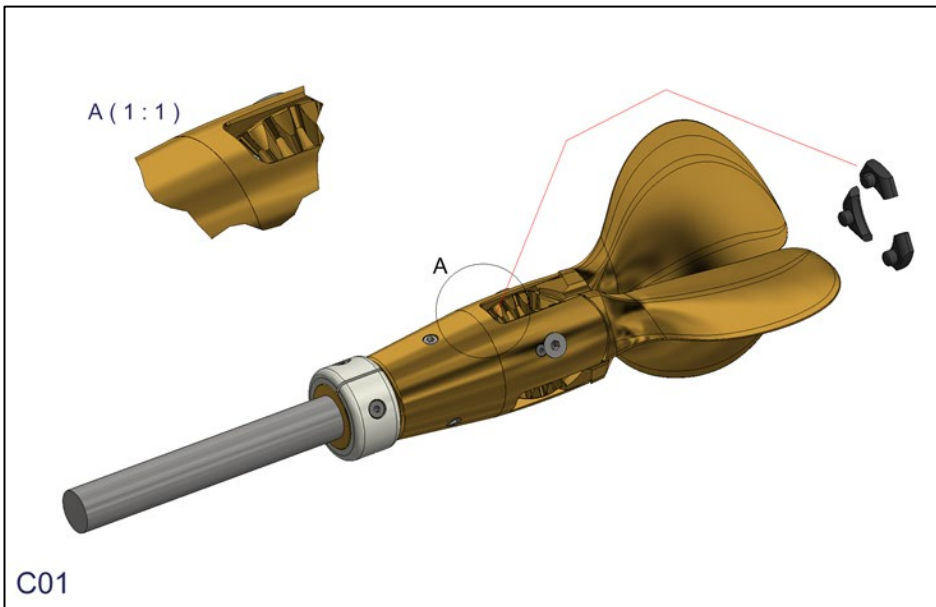
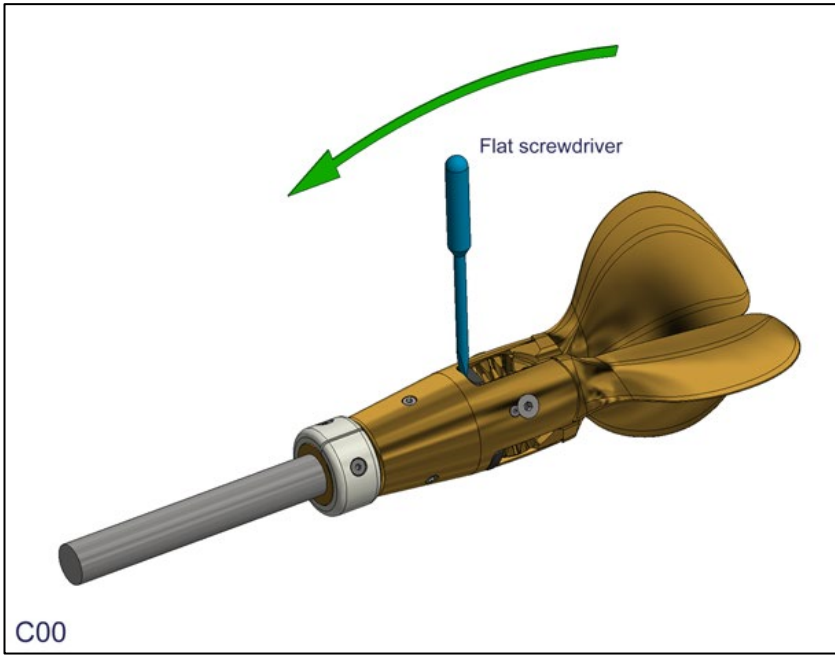

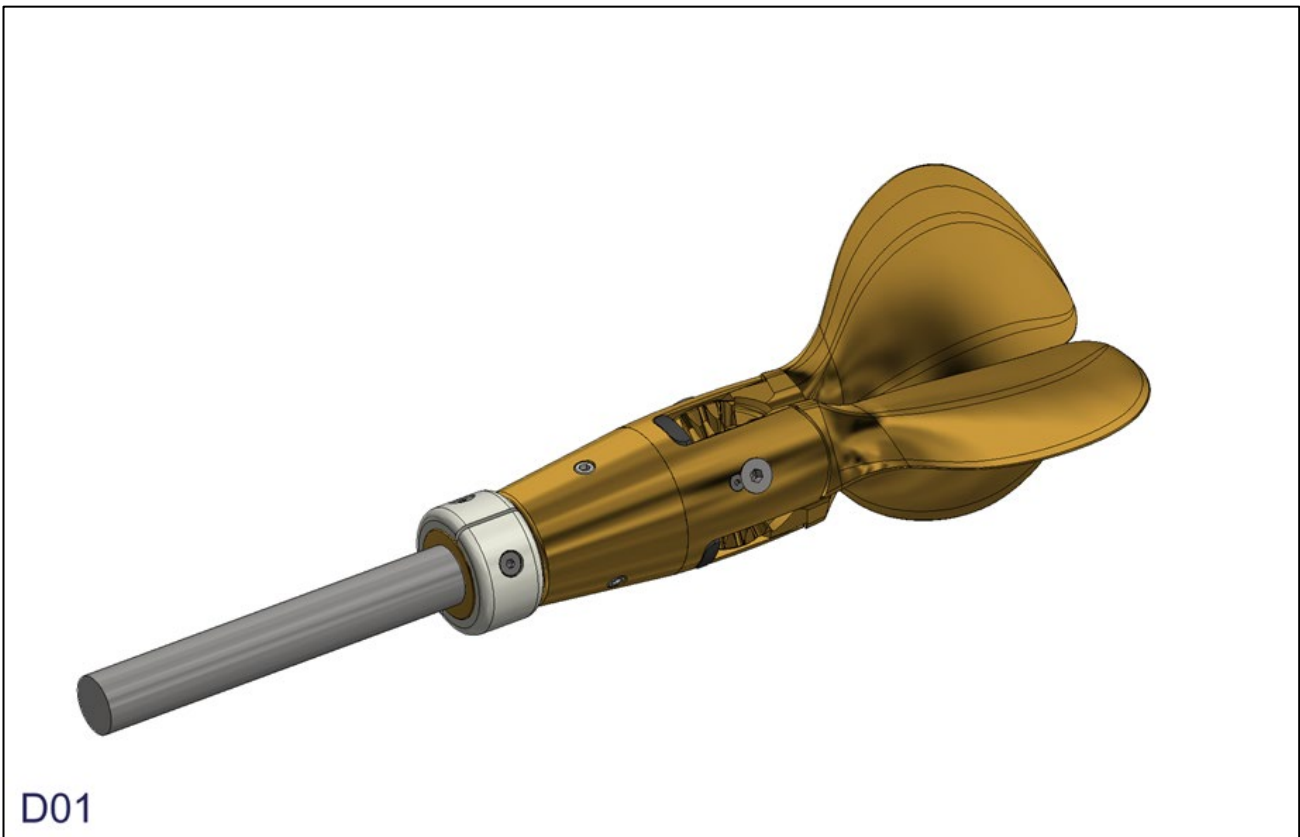
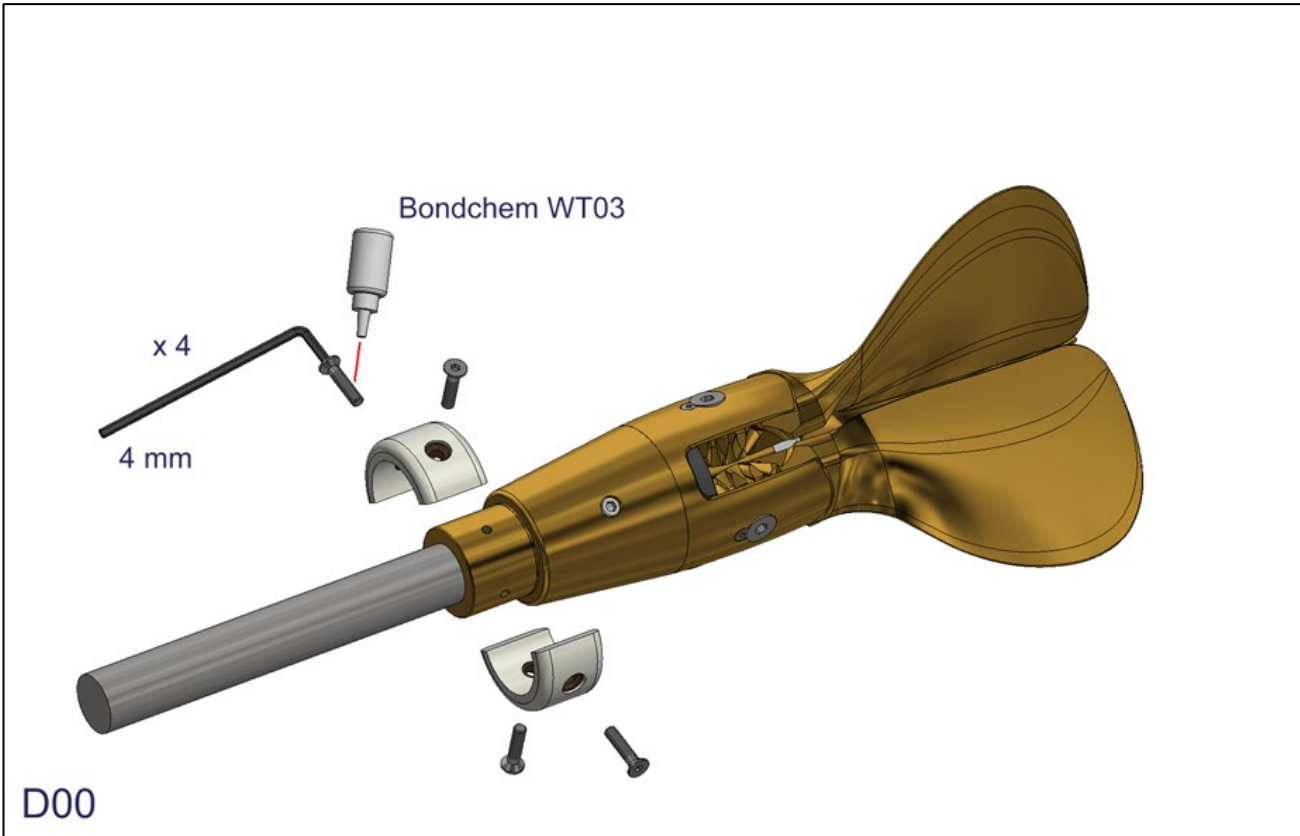

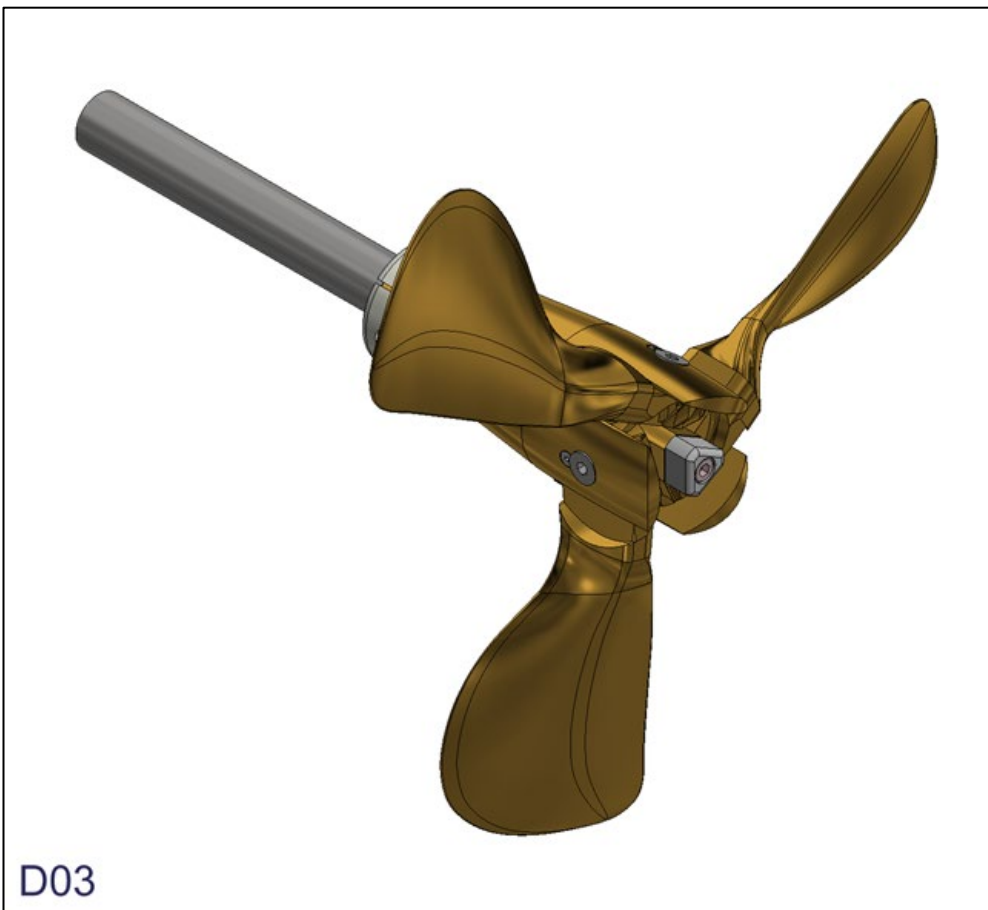
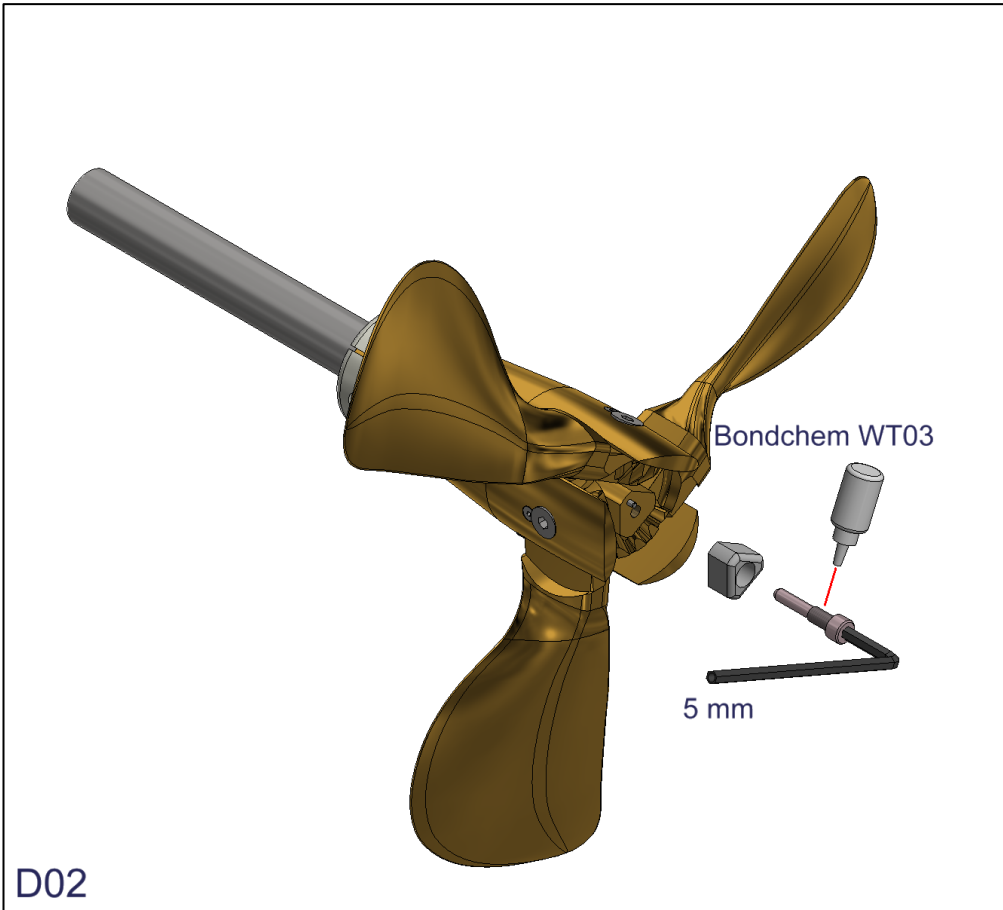

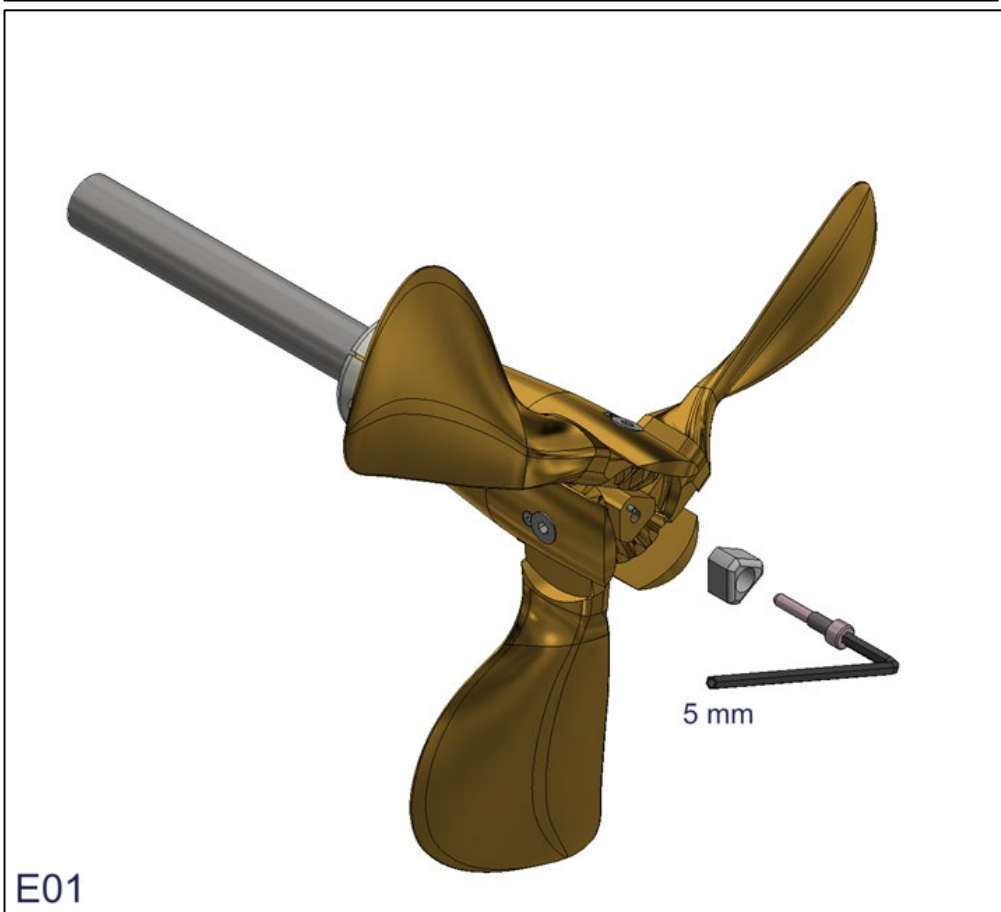
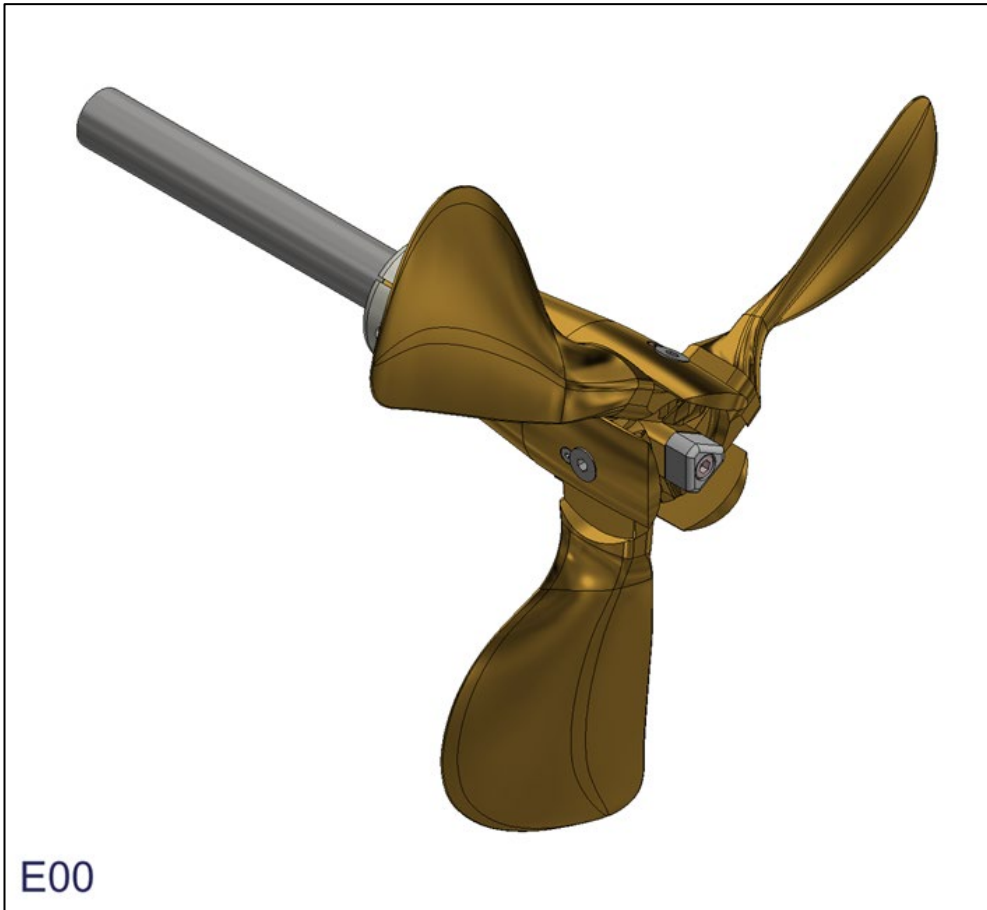

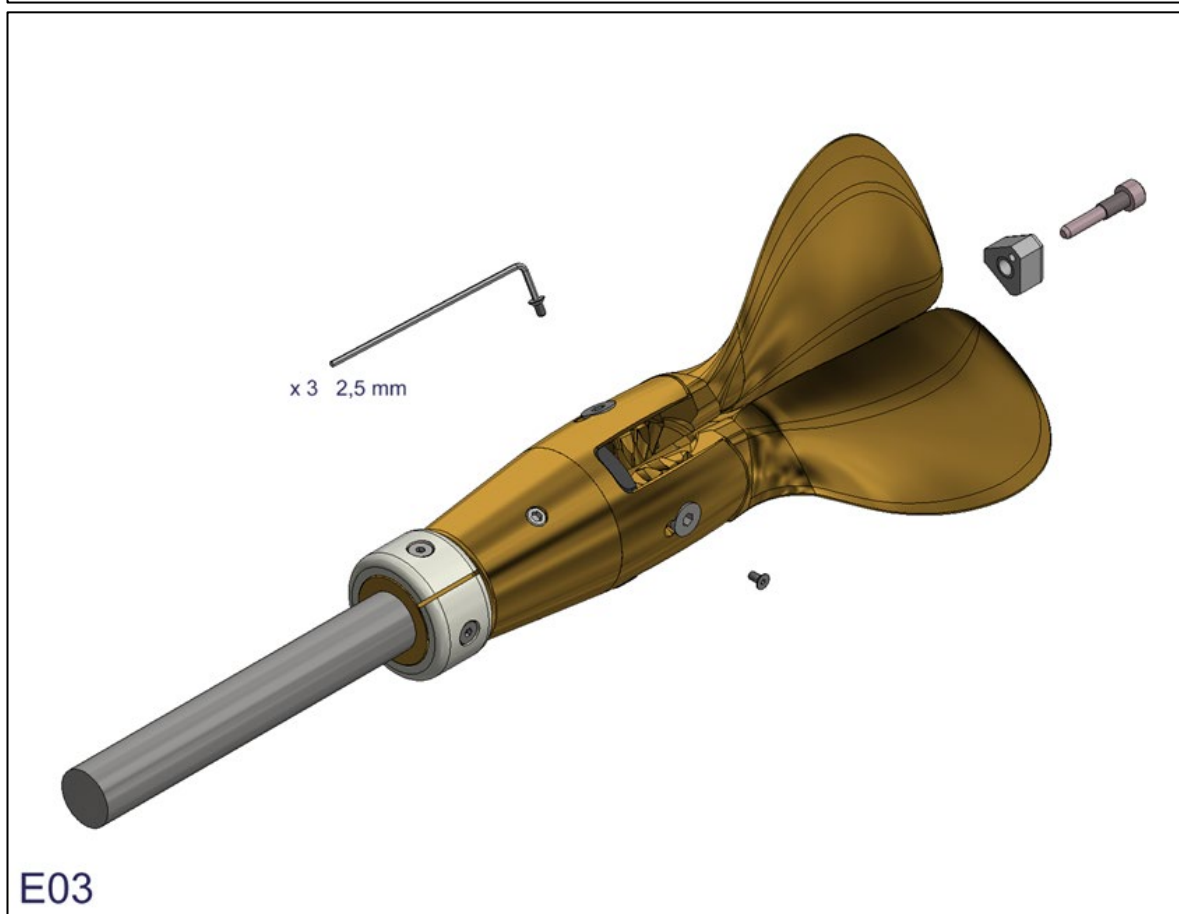
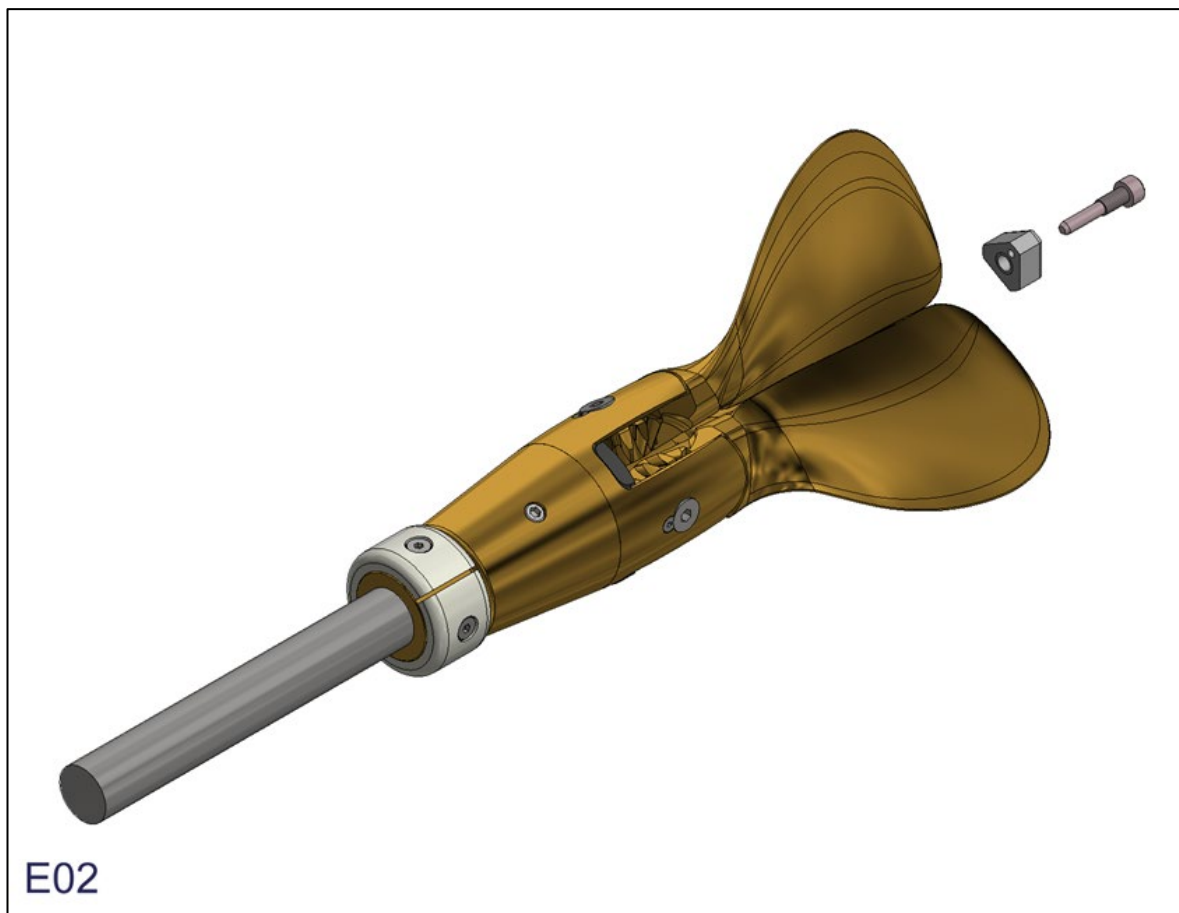

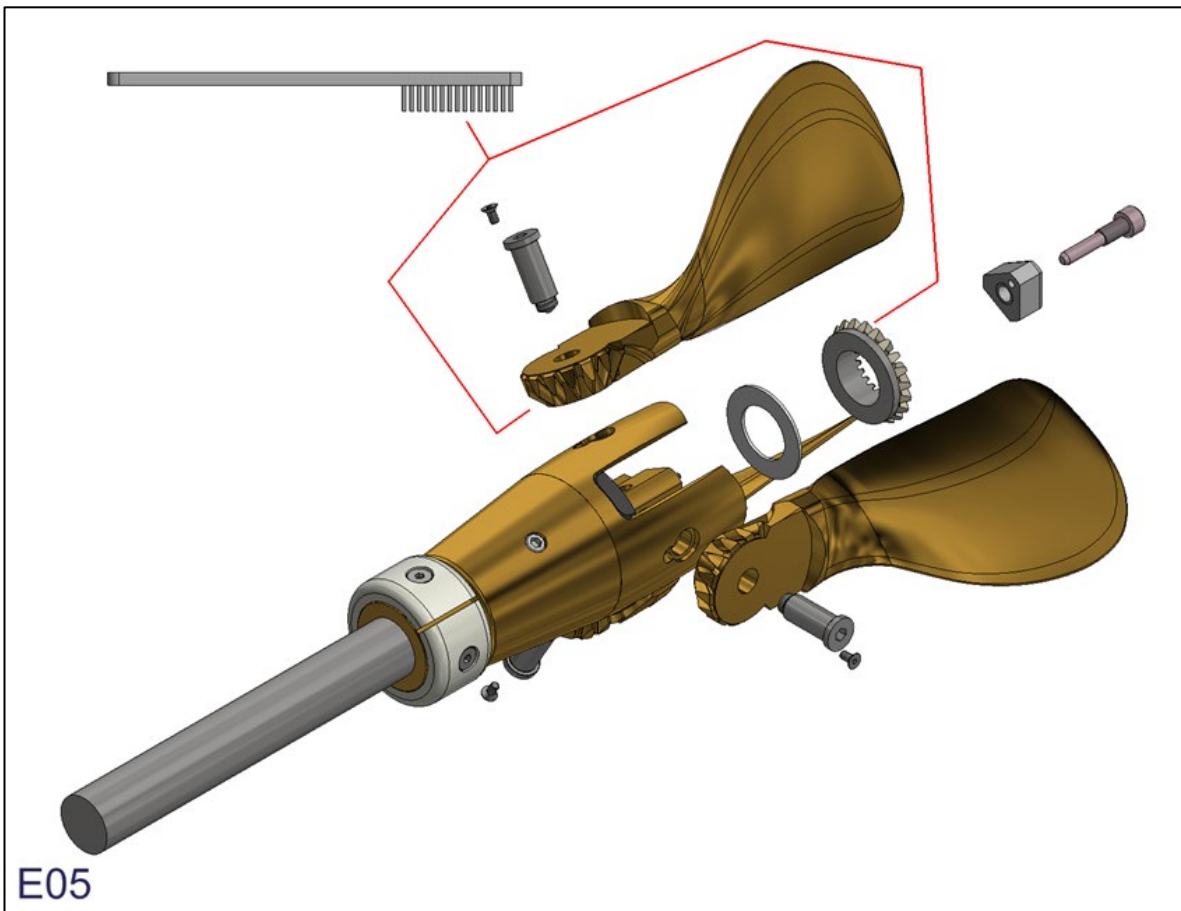
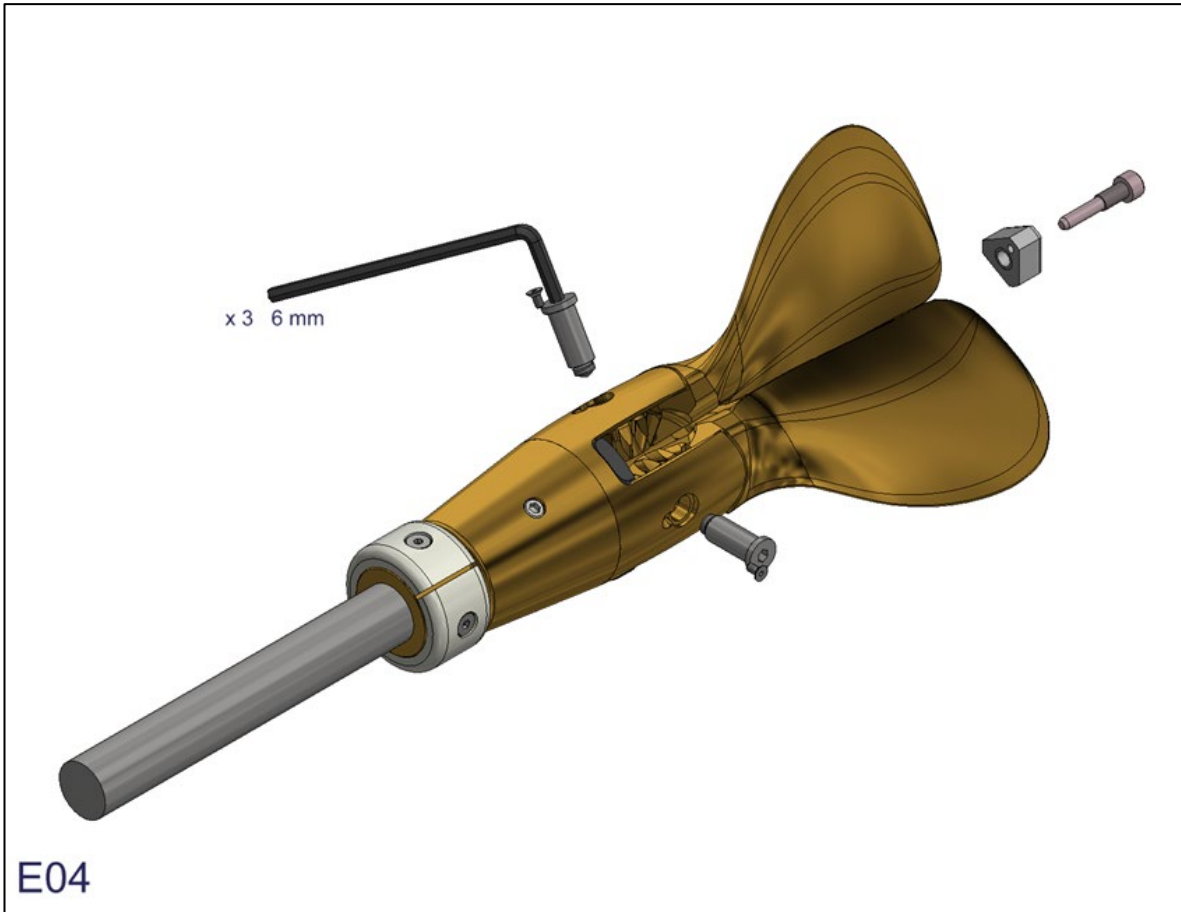

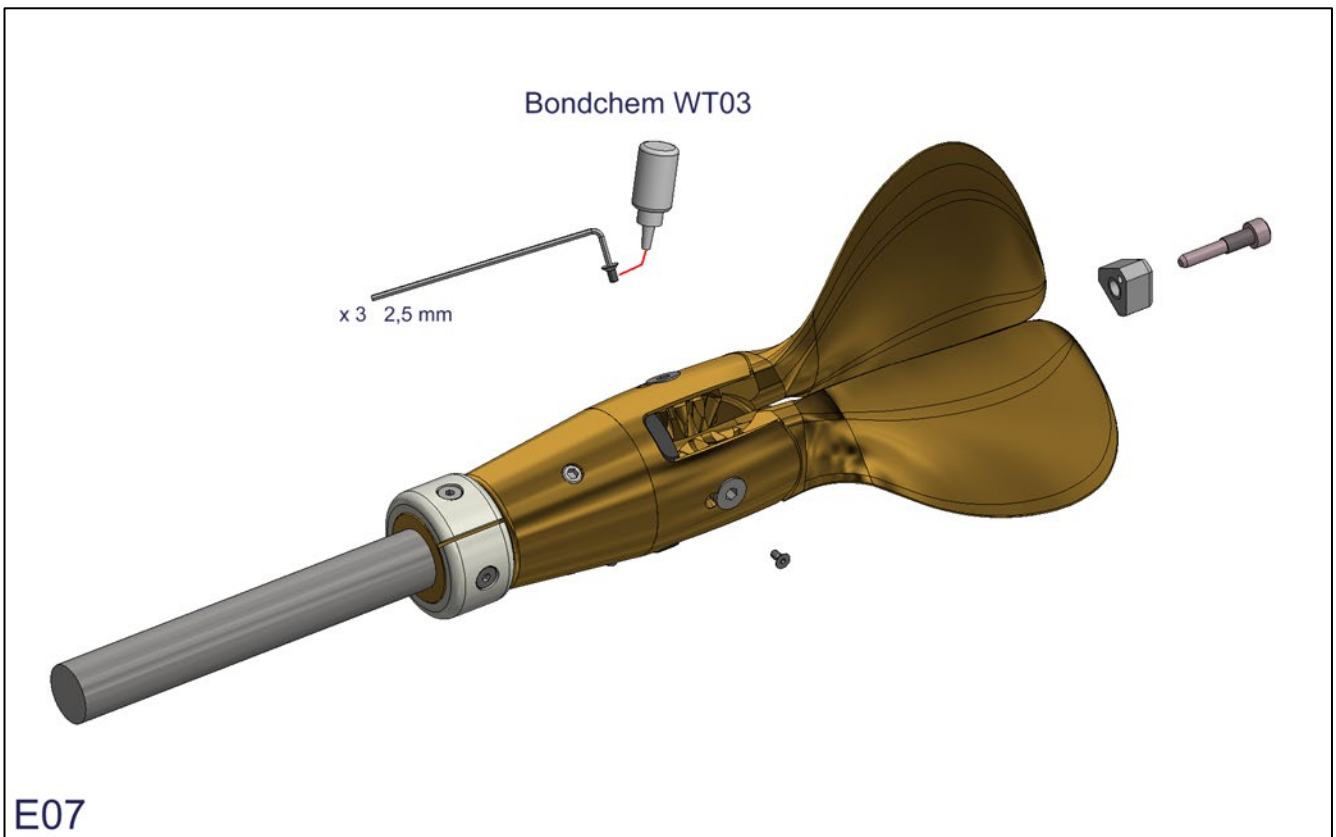
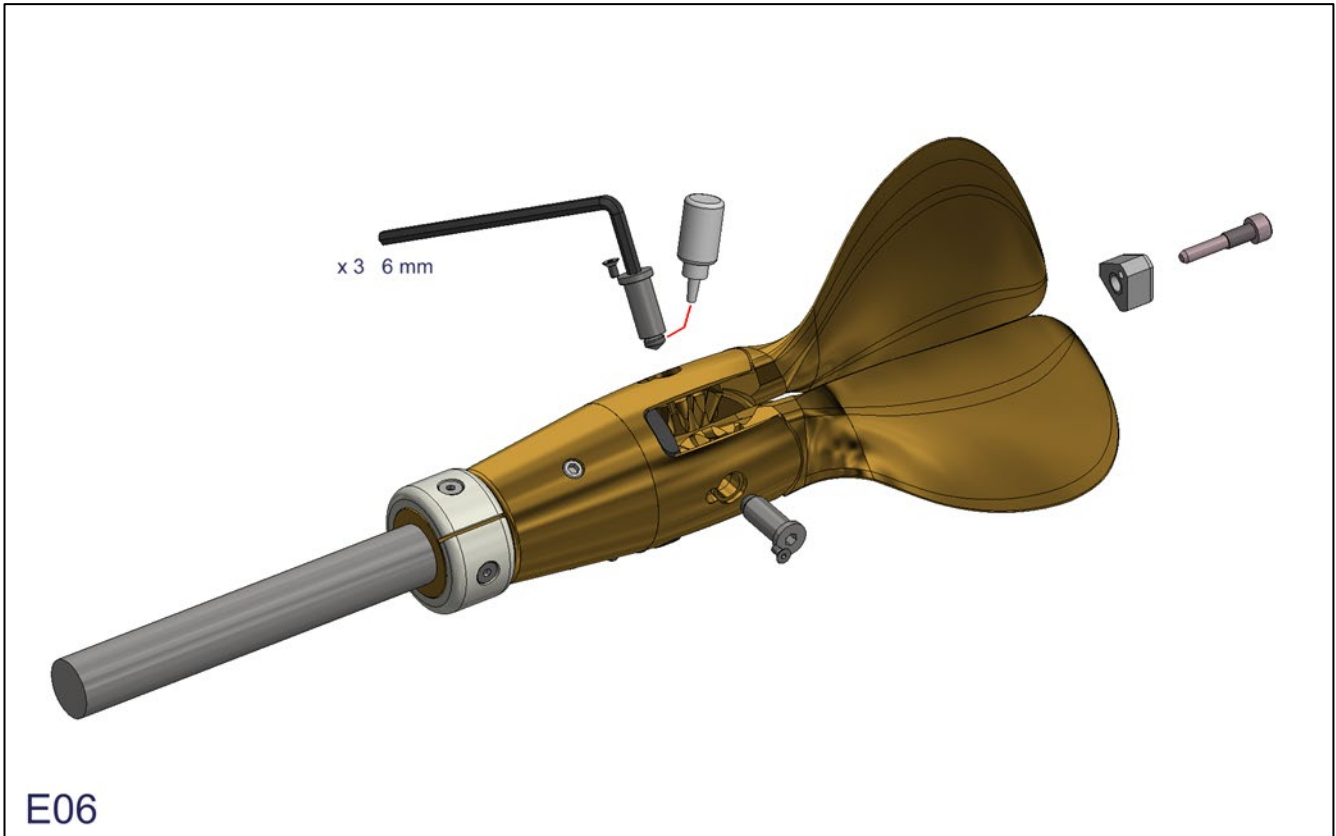

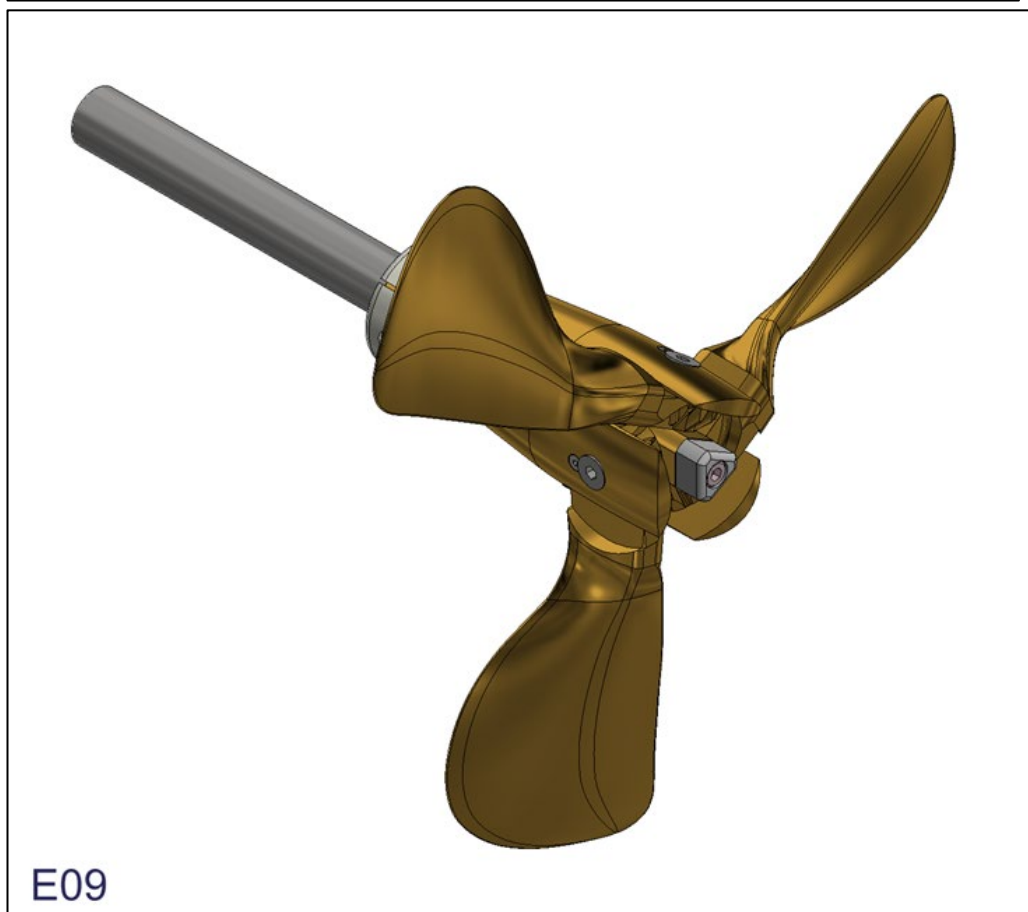
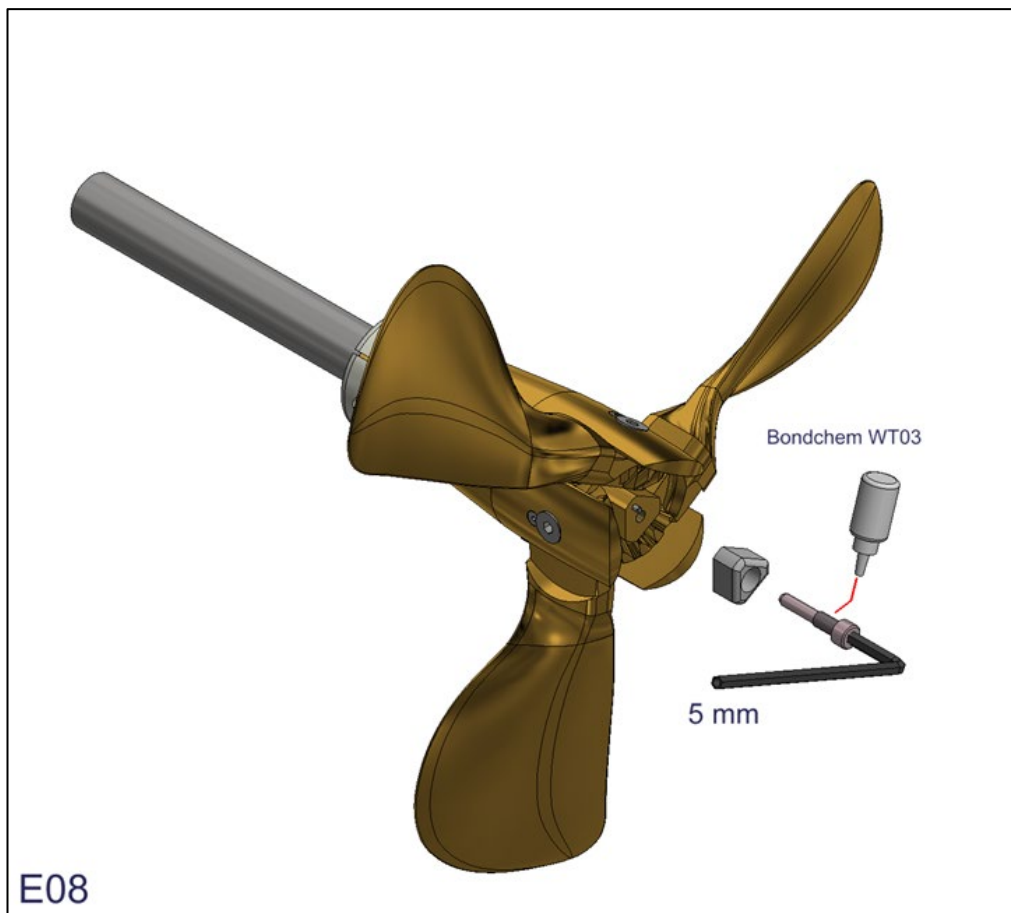

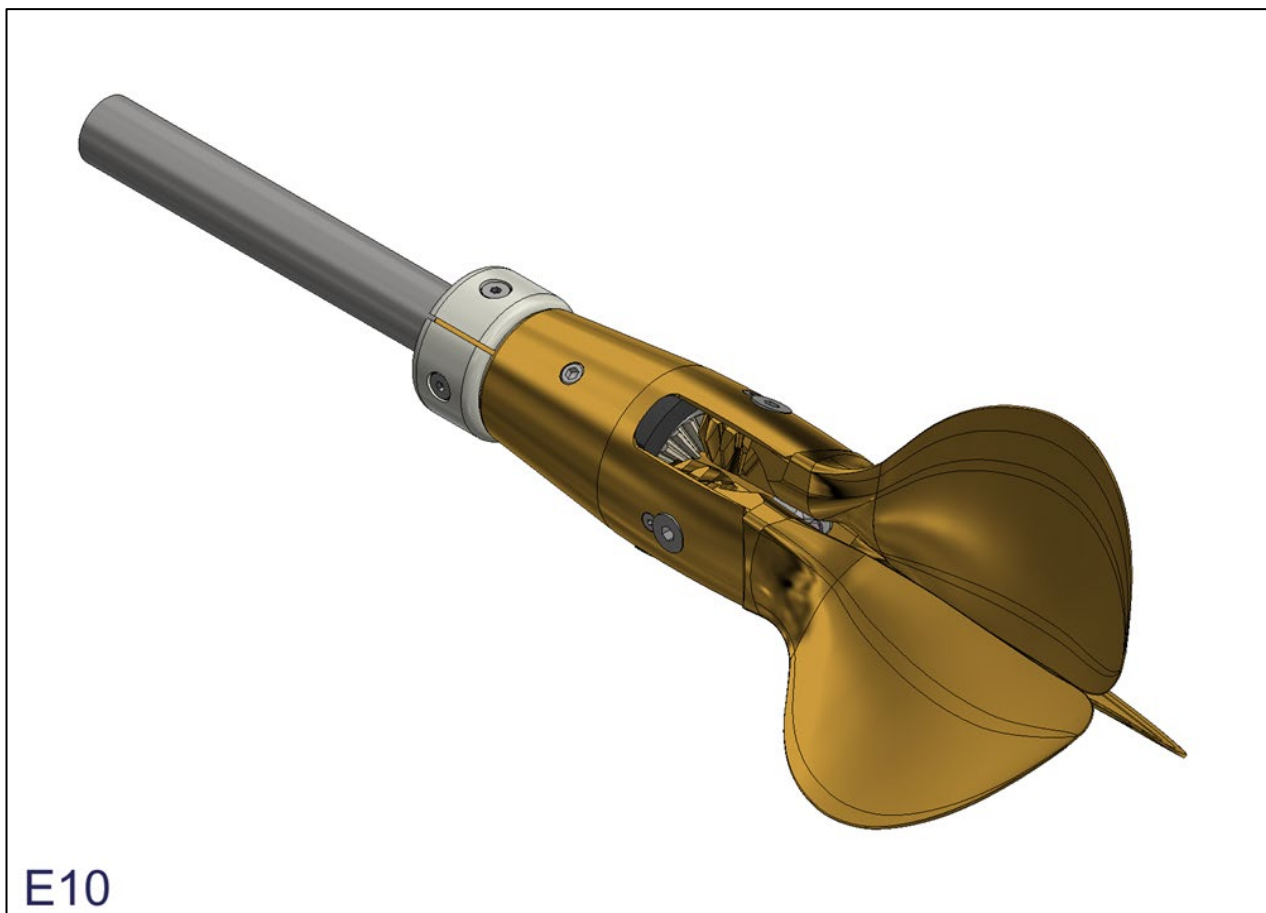

E10

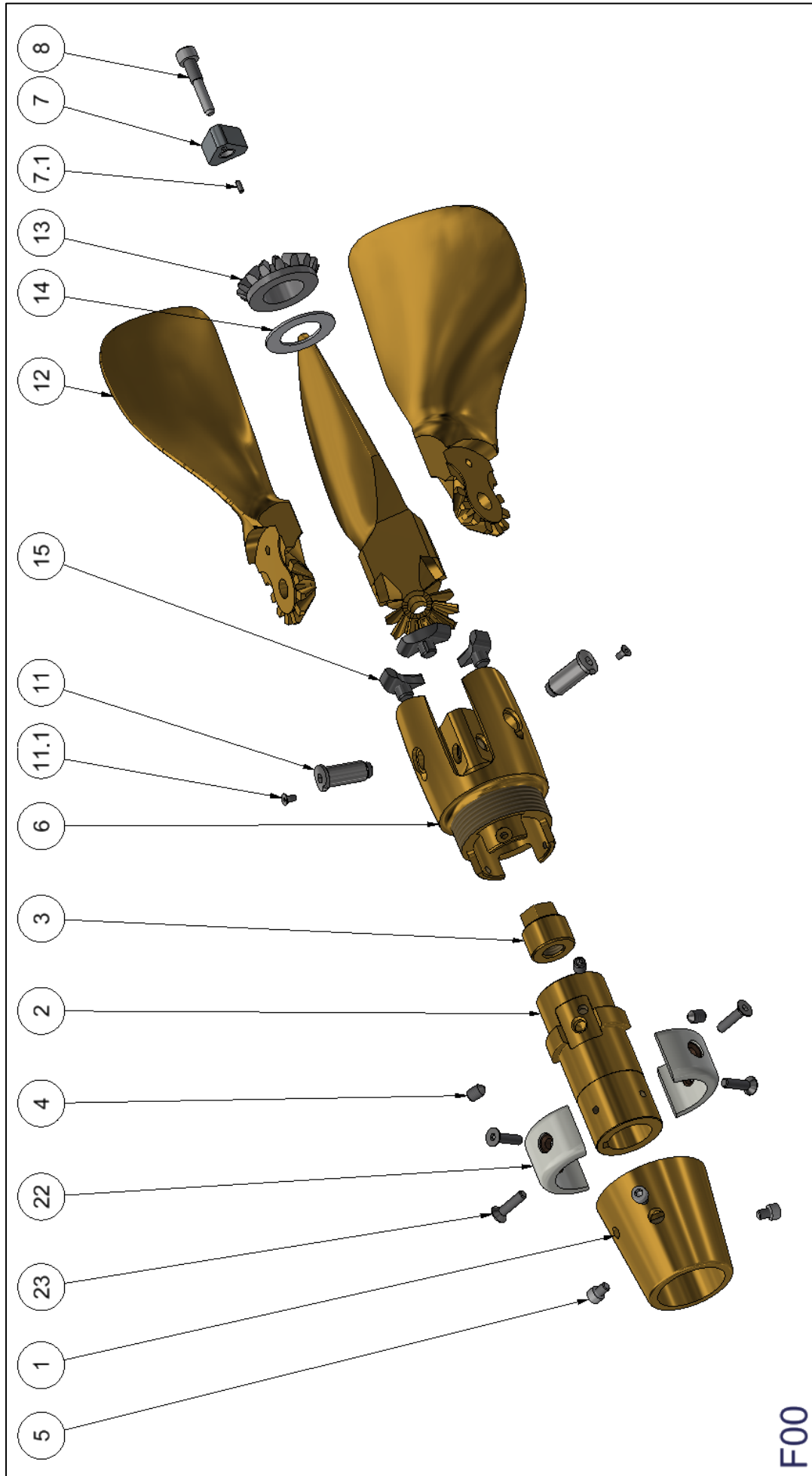

Service sets & Spare Parts List – (F)

Size: 15" – 16,5"

Service set 1407210000

ITEM	DK	GB	DE	STOCK NUMBER	QTY
7	Zinkanode - top	Aft Zinc anode	Zink anode	-	1
8	Låsebolt for zink og akselpinde - 75	Locking bolt for zinc and blade pins	Haltebolzen für zink und blätter Führungsbolzen	-	1
21	Gevindsikring	Threadlocking	Schraubensicherung	-	1
20	Unbrakonøgle - 6 mm	Allen key - 6 mm	Inbusschlüssel - 6 mm	-	1

Service set 1472100000

ITEM	DK	GB	DE	STOCK NUMBER	QTY
15	Gummistopper	Rubber stop	Gummianschläge	-	3
7	Zinkanode - top	Aft Zinc anode	Zink anode	-	1
8	Låsebolt for zink og akselpinde - 75	Locking bolt for zinc and blade pins	Haltebolzen für zink und blätter Führungsbolzen	-	1
21	Gevindsikring	Threadlocking	Schraubensicherung	-	1
20	Unbrakonøgle - 6 mm	Allen key - 6 mm	Inbusschlüssel - 6 mm	-	1

Service set 1407710000

ITEM	DK	GB	DE	STOCK NUMBER	QTY
15	Gummistopper	Rubber stop	Gummianschläge	-	3

Service set 1552000000

ITEM	DK	GB	DE	STOCK NUMBER	QTY
22	Zinkanode - ring	Forward collar zinc	Zinkring anode	-	2
23	Montage skrue for zinkanode - ring	Collar zinc fixing bolt	Befestigungsschraube für Zinkring anode	-	4
21	Gevindsikring	Threadlocking	Schraubensicherung	-	1
18	Unbrakonøgle - 4 mm	Allen key - 4 mm	Inbusschlüssel - 4 mm	-	1

ITEM	DK	GB	DE	STOCK NUMBER	QTY
1	Nav kappe	Jacket	Mantel	3300000075z	1
2	Konusdel	Hub cone	Konusteil	3400000075	1
3	Aksel Møtrik*	Shaft Nut*	Mütter propellerwelle*	---	1
4	Pinol skruer, for låsning af aksel møtrik	Allen screw for locking of shaft nut	Inbusschrauben zur sicherung der mutter für propellerwelle	145600000	3
5	Låsebolte for nav kappe	Lock bolts for jacket	Verschlussbolzen für Mantel	1406800000	3
6	Navtop	Blade housing	Nabenoberteil	3500000075	1
7	Zinkanode - top	Aft Zinc anode	Zink anode	-	1
7.1	Cylinderstift ø3x8 A4	Parallel Pin	Zylinderstift	1406600000	1
8	Låsebolt for zink og akselpinde - 75	Locking bolt for zinc and blade pins	Haltebolzen für zink und blätter Führungsbolzen	-	1
11	Aksel til propelblade	Blade pins	Führungsbolzen	1505000000	3
11.1	Låsebolt for aksel til propelblade	Locking bolt for blade pins	Verschlussbolzen für Führungsbolzen	1179910408	3
12	Propelblade / 15" x 9" RH	Propeller blades / 15" x 9" RH	Propellerblätter / 15" x 9" RH	3115009001	3
12	Propelblade / 15" x 9" LH	Propeller blades / 15" x 9" LH	Propellerblätter / 15" x 9" LH	3115009002	3
12	Propelblade / 15" x 10" RH	Propeller blades / 15" x 10" RH	Propellerblätter / 15" x 10" RH	3115010001	3
12	Propelblade / 15" x 10" LH	Propeller blades / 15" x 10" LH	Propellerblätter / 18" x 11" LH	3115010002	3
12	Propelblade / 15" x 11" RH	Propeller blades / 15" x 11" RH	Propellerblätter / 15" x 11" RH	3115011001	3
12	Propelblade / 15" x 11" LH	Propeller blades / 15" x 11" LH	Propellerblätter / 15" x 11" LH	3115011002	3
12	Propelblade / 15" x 12" RH	Propeller blades / 15" x 12" RH	Propellerblätter / 15" x 12" RH	3115012001	3
12	Propelblade / 15" x 12" LH	Propeller blades / 15" x 12" LH	Propellerblätter / 15" x 12" LH	3115012002	3
12	Propelblade / 16,5" x 10" RH	Propeller blades / 16,5" x 10" RH	Propellerblätter / 16,5" x 10" RH	3116501001	3
12	Propelblade / 16,5" x 10" LH	Propeller blades / 16,5" x 10" LH	Propellerblätter / 16,5" x 10" LH	3116510002	3
12	Propelblade / 16,5" x 11" RH	Propeller blades / 16,5" x 11" RH	Propellerblätter / 16,5" x 11" RH	3116511001	3
12	Propelblade / 16,5" x 11" LH	Propeller blades / 16,5" x 11" LH	Propellerblätter / 16,5" x 11" LH	3116511002	3
12	Propelblade / 16,5" x 12" RH	Propeller blades / 16,5" x 12" RH	Propellerblätter / 16,5" x 12" RH	3116512001	3
12	Propelblade / 16,5" x 12" LH	Propeller blades / 16,5" x 12" LH	Propellerblätter / 16,5" x 12" LH	3116512002	3
12	Propelblade / 16,5" x 13" RH	Propeller blades / 16,5" x 13" RH	Propellerblätter / 16,5" x 13" RH	3116513001	3
12	Propelblade / 16,5" x 13" LH	Propeller blades / 16,5" x 13" LH	Propellerblätter / 16,5" x 13" LH	3116513002	3
12	Propelblade / 16,5" x 14" RH	Propeller blades / 16,5" x 14" RH	Propellerblätter / 16,5" x 14" RH	3116514001	3
12	Propelblade / 16,5" x 14" LH	Propeller blades / 16,5" x 14" LH	Propellerblätter / 16,5" x 14" LH	3116514002	3
13	Tandhjul	Gear-wheel	Zahnrad	1433000000	1
14	Afstandsskive	Spacer	Abstandshalter	1404010000	1
15	Gummistopper	Flexible stop	Gummianschläge	1439000000	3
22	Zinkanode - ring	Forward collar zinc	Zinkring anode	-	2
23	Montage skrue for zinkanode - ring	Collar zinc fixing bolt	Befestigungsschraube für Zinkring anode	-	4

*: Møtrik – bestilles kunde specifik; Nut – ordered custom specific; Mütter – kundenspezifisch bestellt

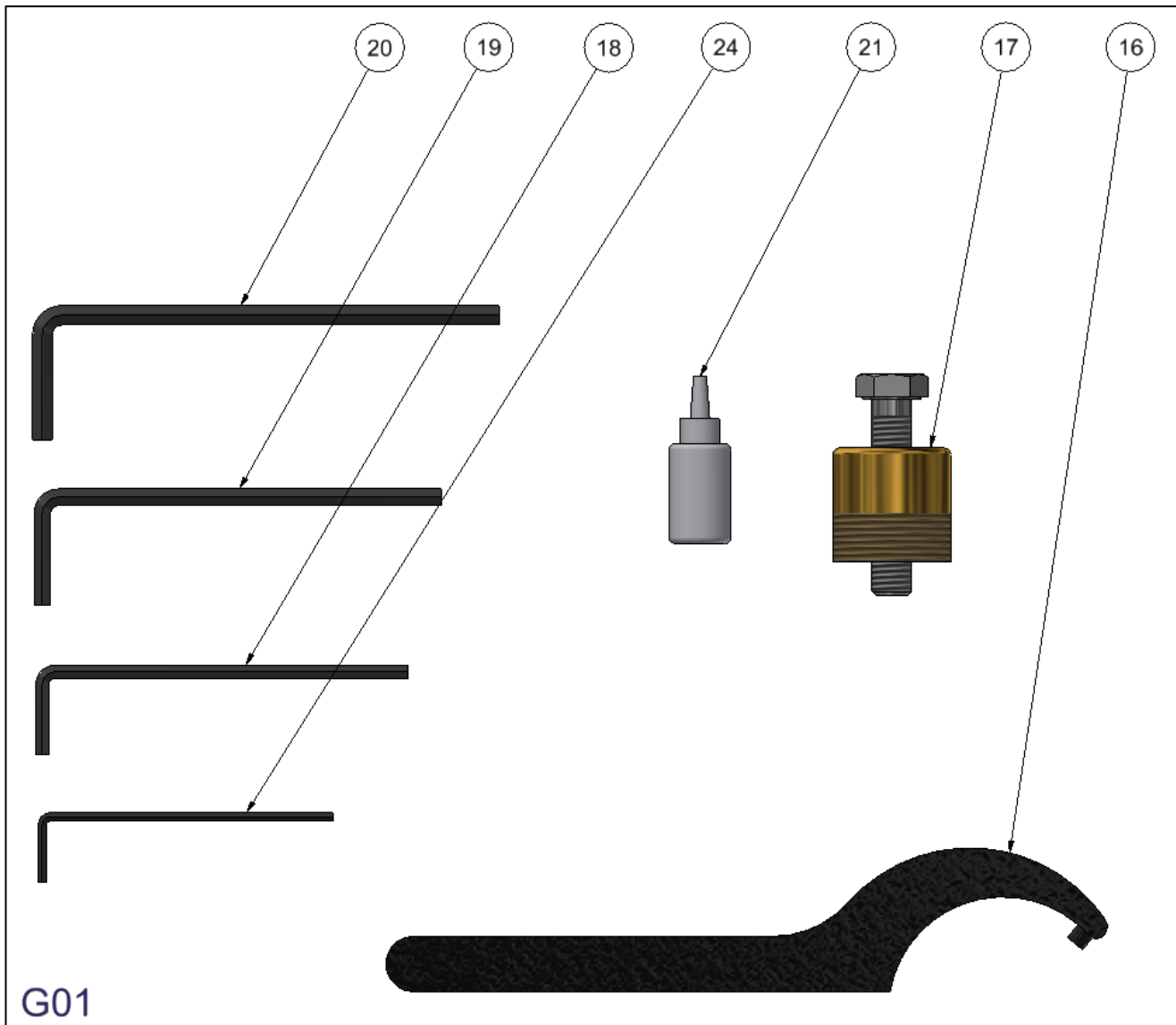

15" – 16,5"

ITEM	DK	GB	DE	STOCK NUMBER
20	Unbrakonøgle - 6 mm	Allen key - 6 mm	Inbusschlüssel - 6 mm	1402200000
19	Unbrakonøgle - 5 mm	Allen key - 5 mm	Inbusschlüssel - 5 mm	1402100000
18	Unbrakonøgle - 4 mm	Allen key - 4 mm	Inbusschlüssel - 4 mm	1402000000
24	Unbrakonøgle - 2,5 mm	Allen key - 2,5 mm	Inbusschlüssel - 2,5 mm	1401900025
21	Gevindsikring	Threadlocking	Schraubensicherung	1410000000
17	Aftrækker	Puller	Abzieher	1526000000
16	Hagenøgle	C-Spanner	Hagenschlüssel	1444000000

02052025