

Propeller 23" – 25" – 27" – 29" – 32" Overdrive for shaft

- A) Disassemble complete propeller hub for mounting
- B) Assemble hub on shaft
- C) Exchange of "rubber blade stop"
- D) Exchange of "zinc anodes"
- E) Cleaning of "Gearwheel"
- F) Spare Parts List
- G) Supplied Tools

DK

Læs instruktionen før der arbejdes med propellen.

Vigtigt!

Udskift zink hvis de er korroderet mere end 50%.

Advarsel!

Pas på skarpe kanter.

GB

Read the Instructions before any work on the propeller.

Important!

Replace Zinc if eroded more than 50%.

Warning!

Beware of sharp edges.

D

Bitte die Anweisung lesen, bevor Sie mit dem Propeller arbeiten.

Wichtig!

Zinkteile auswechseln, wenn sie mehr als 50% korrodiert sind.

Warnung!

Achten Sie auf die scharfe Kanten.

F

Lire les instructions avant toute intervention sur l'hélice

Important!

Remplacer l'anode zinc si elle est corrodé à plus de 50%

Attention!

Attention aux bords coupants

IT

Leggere attentamente le Istruzioni prima di qualsiasi operazione sull'elica.

Importante!

Sostituire l'anodo di zinco se usurato più del 50%

Avvertenza!

Prestare attenzione alle parti taglienti

ESP

Lea las instrucciones antes de efectuar cualquier trabajo en la hélice.

¡ Importante !

Reemplazar el ánodo si observa mas de un 50 % de corrosión.

¡ Advertencia !

Tenga cuidado con las esquinas afiladas.

Disassemble complete propeller hub for mounting – (A)

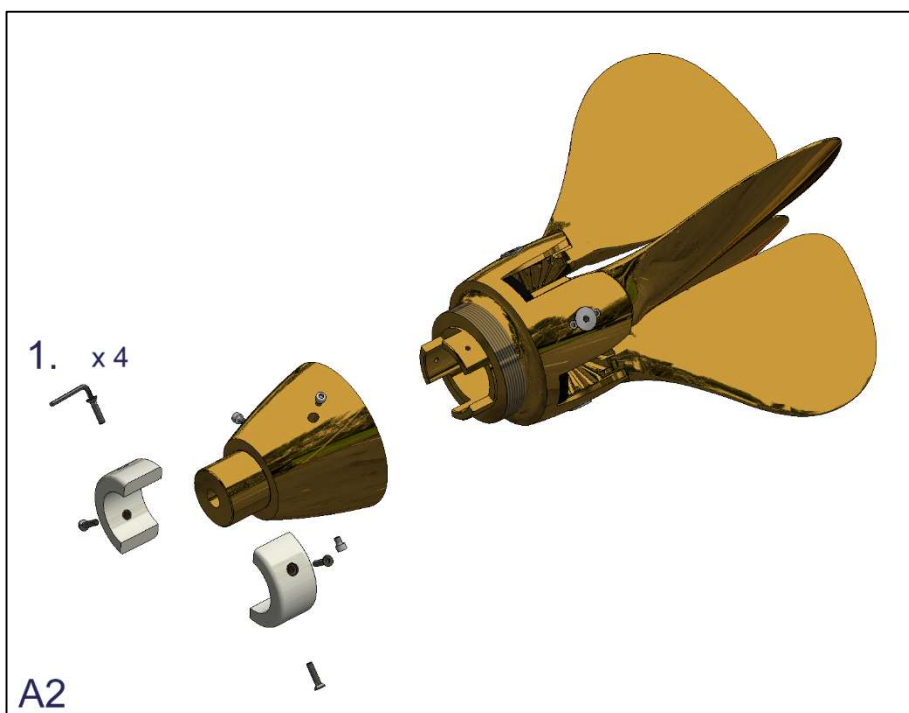
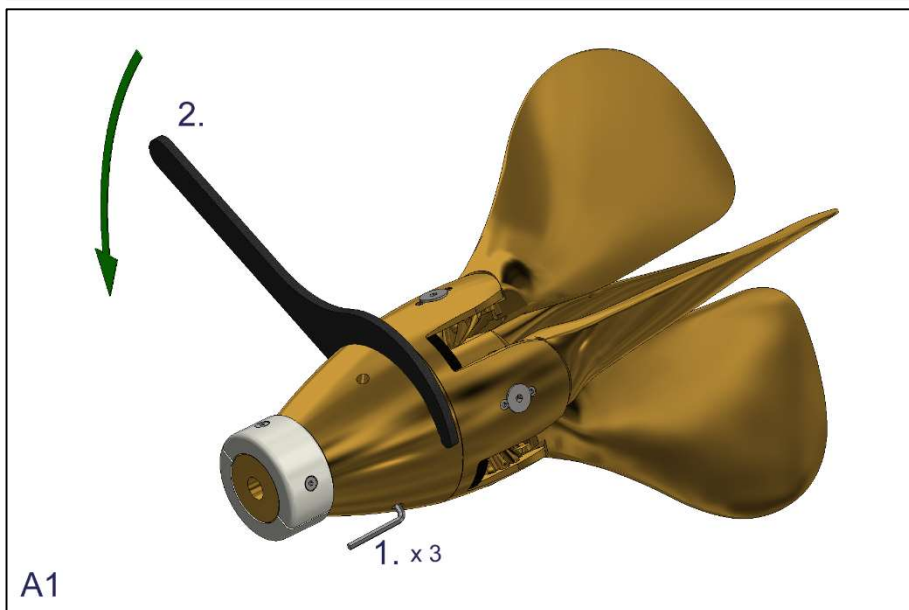
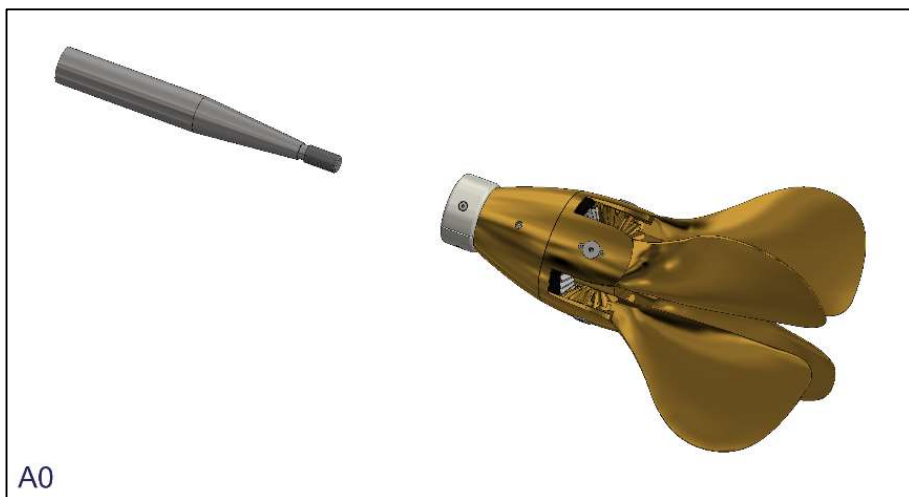

Disassemble complete propeller hub for mounting – (A)

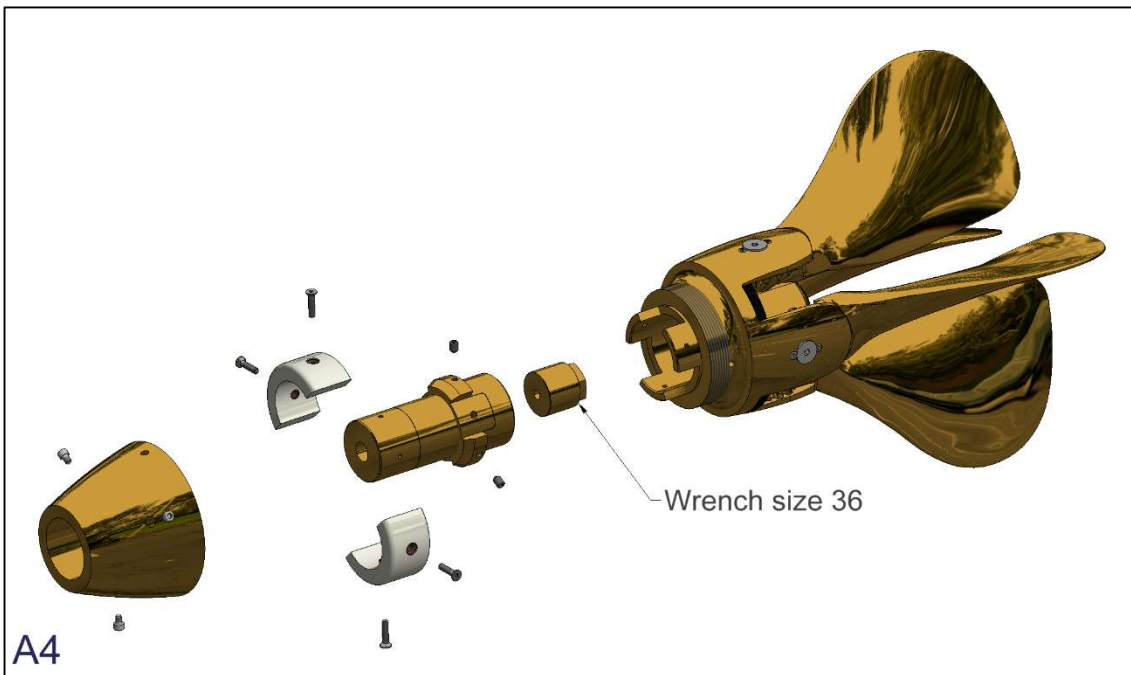
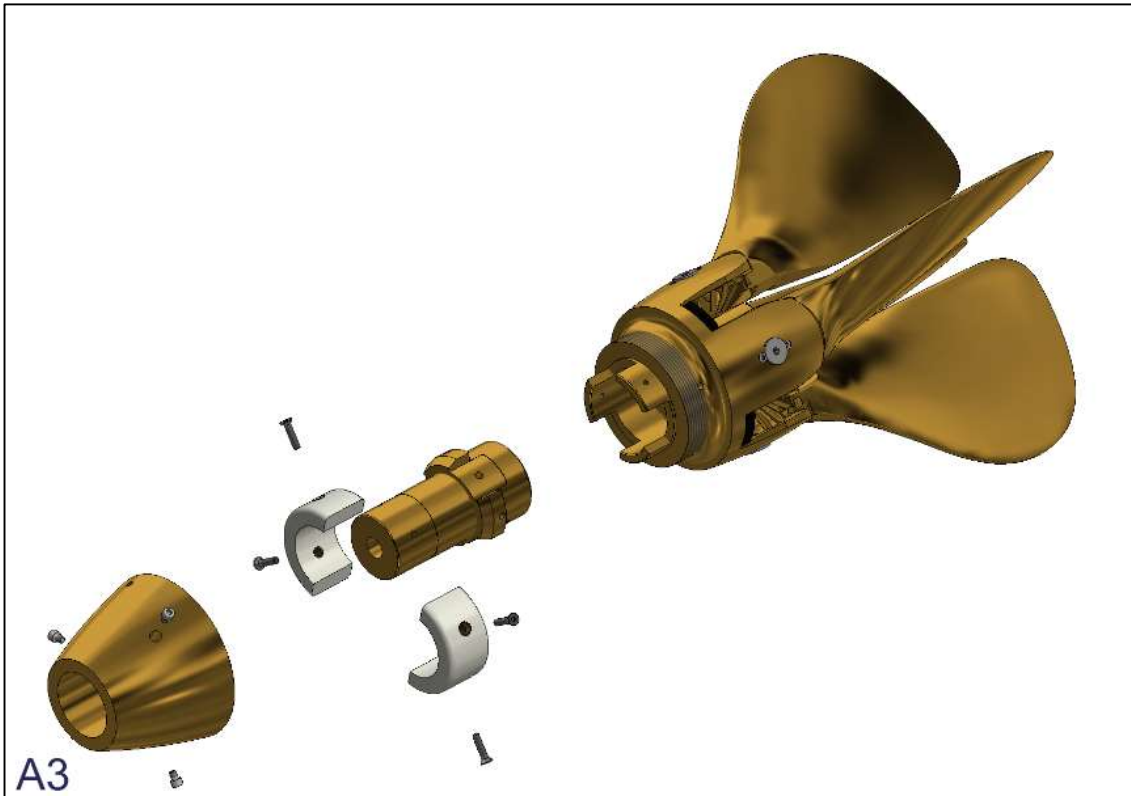

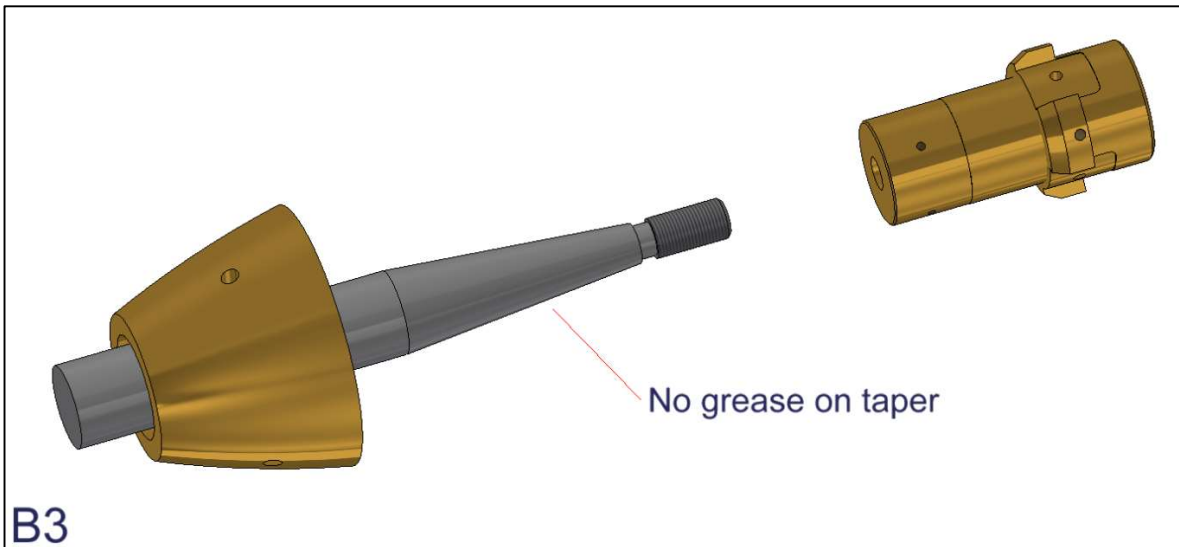
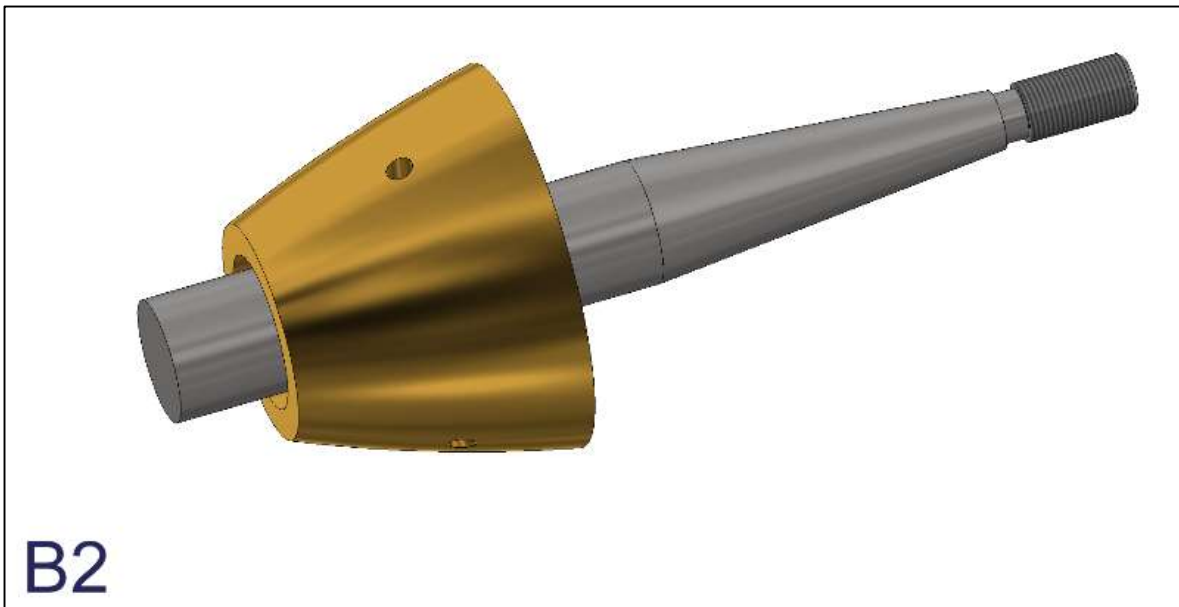

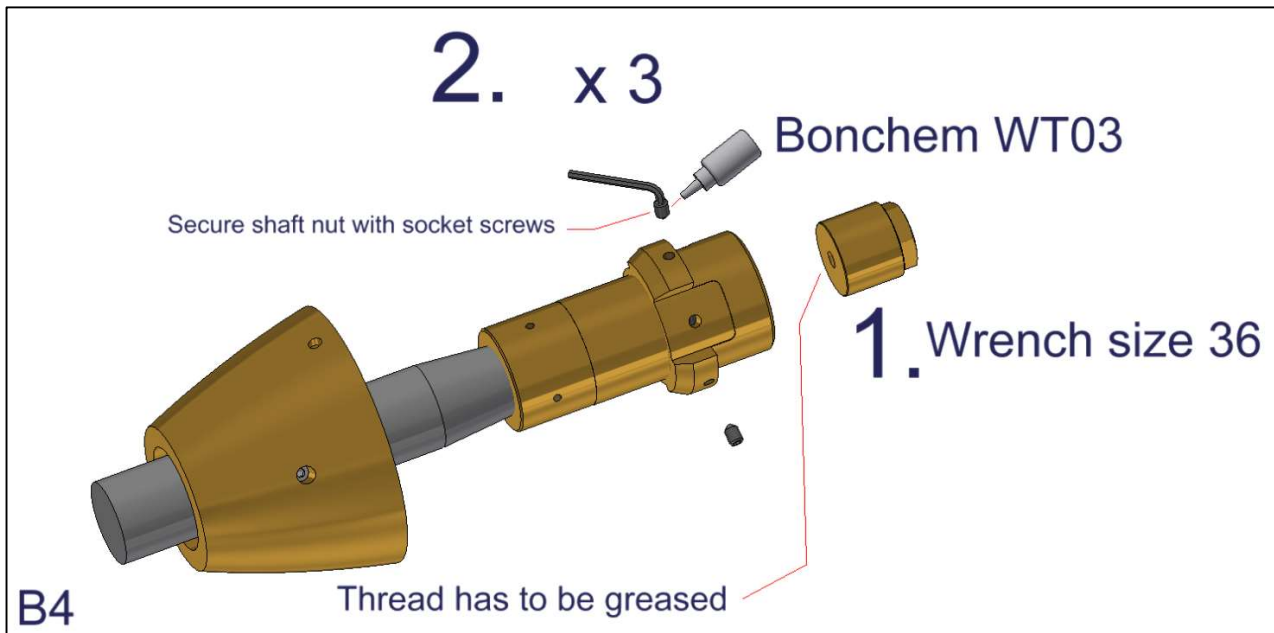

Propeller: 23" - 25" - 27" - 29" - 32"			
Torque settings for Gori shaft nuts in Nm			
	Norm Thread		Torque
	Diameter	Pitch	
	mm	mm	Nm
3/4"-10 UNC	18.7	2.54	81
M20 x 2.5	19.6	2.5	91
M20 x 2	19.7	2	96
7/8"-9 UNC	21,8	2.82	118
M24 x 2	23.7	2	144
1"-8 UNC	25.0	3.18	151
1"-12 UNF	25.1	2.12	160
M27 x 2	26.7	2	198
M30 x 2	29.7	2	245
M33 x 2	32,7	2	305
M36 x 3	35.6	3	335
M42 x 3	41,6	3	440

Thread has to be greased
No grease on taper on shaft

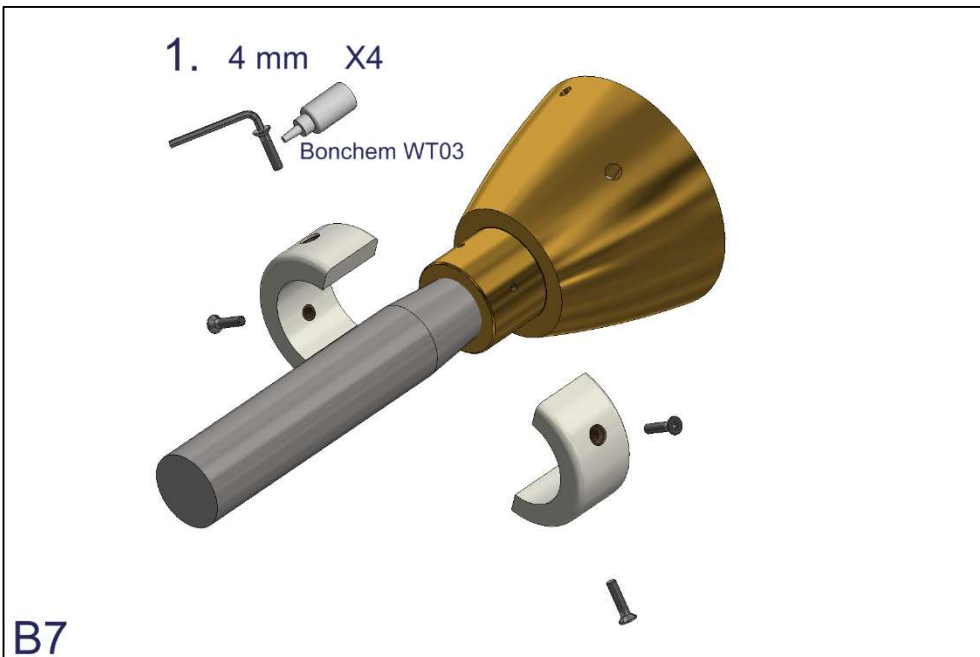
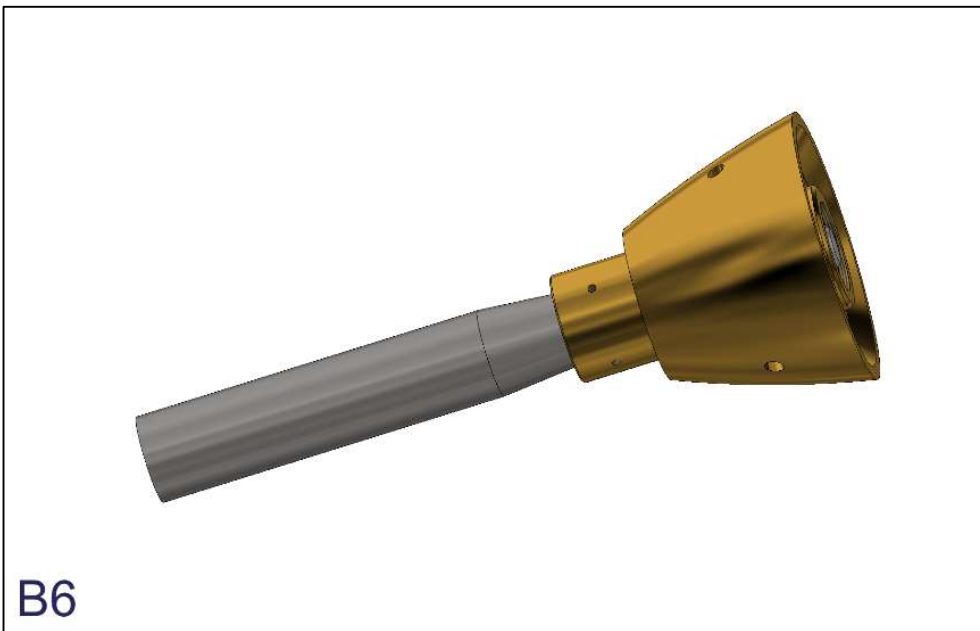
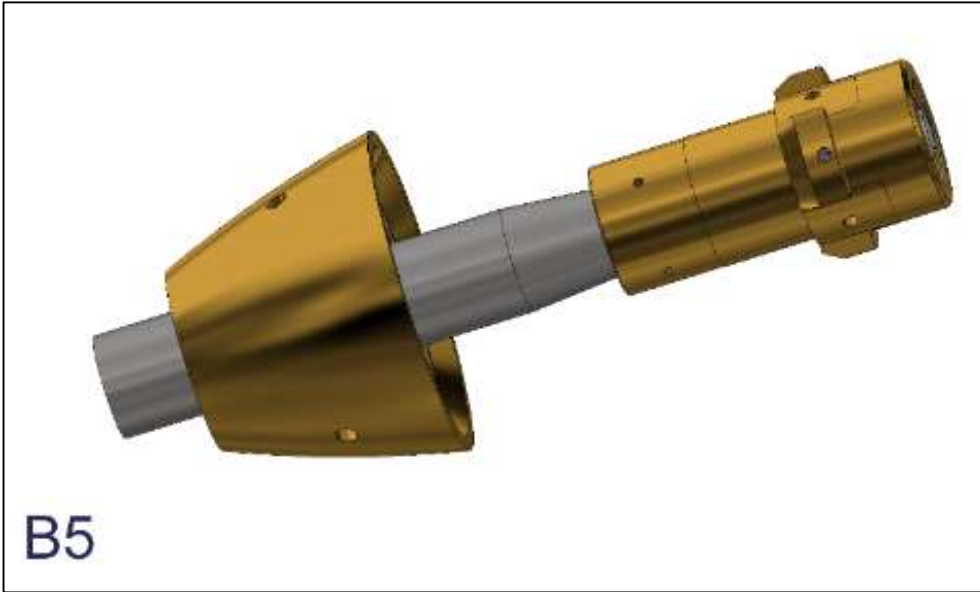

Assemble hub on shaft – (B)

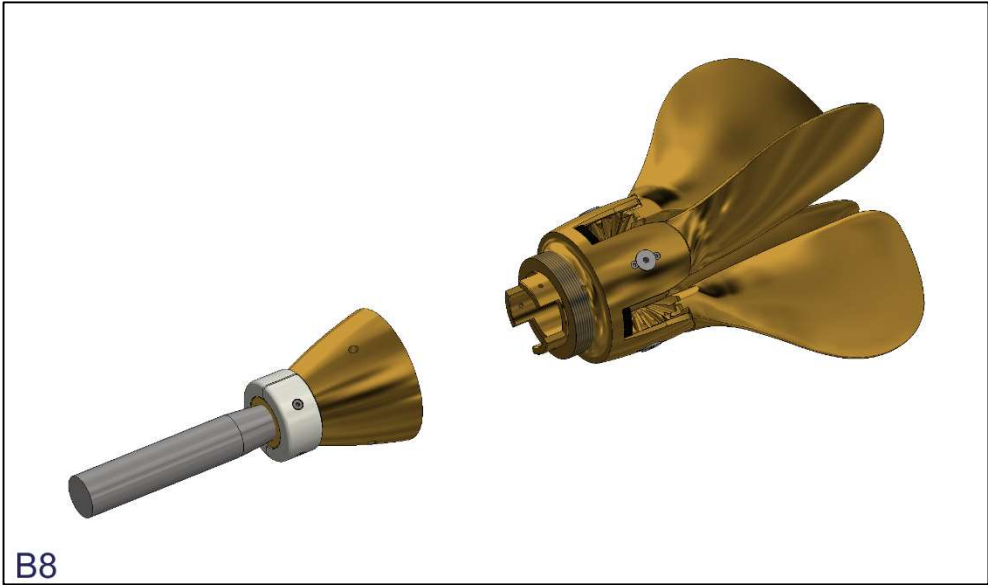

B8

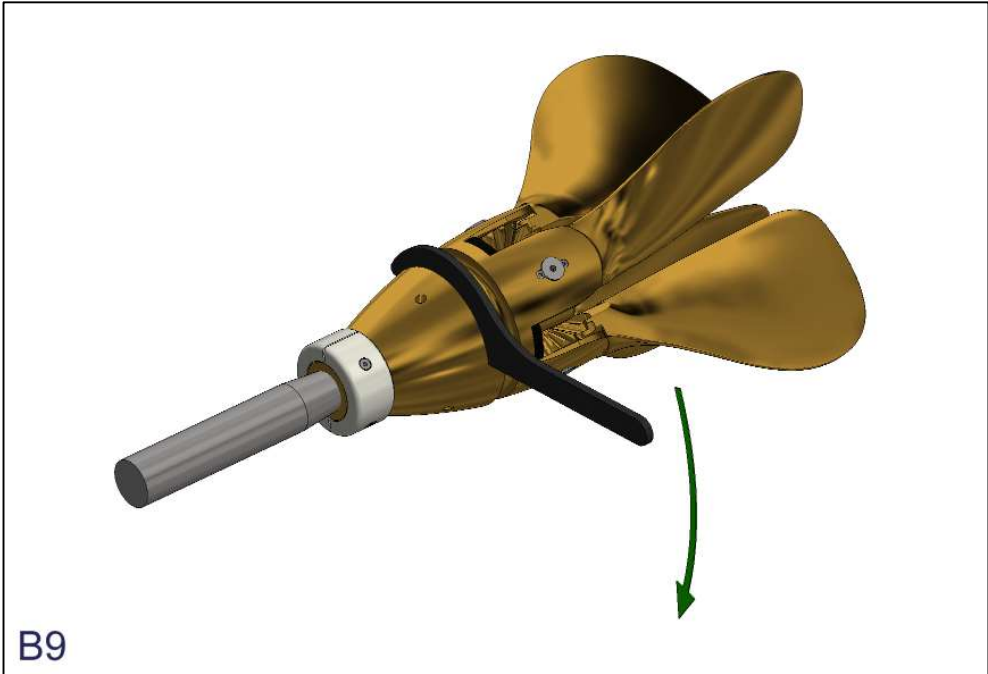

B9

Assemble hub on shaft – (B)

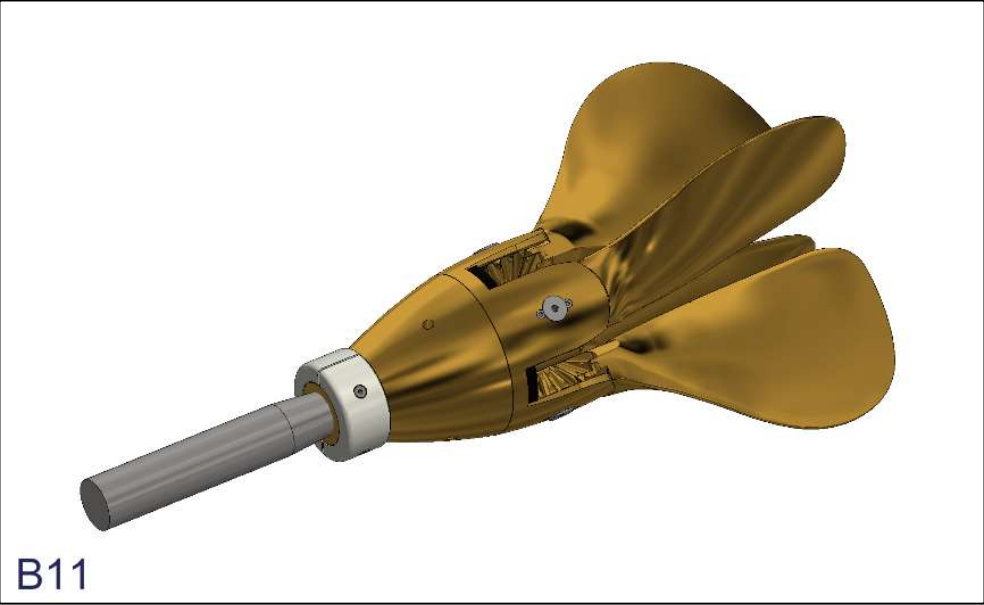
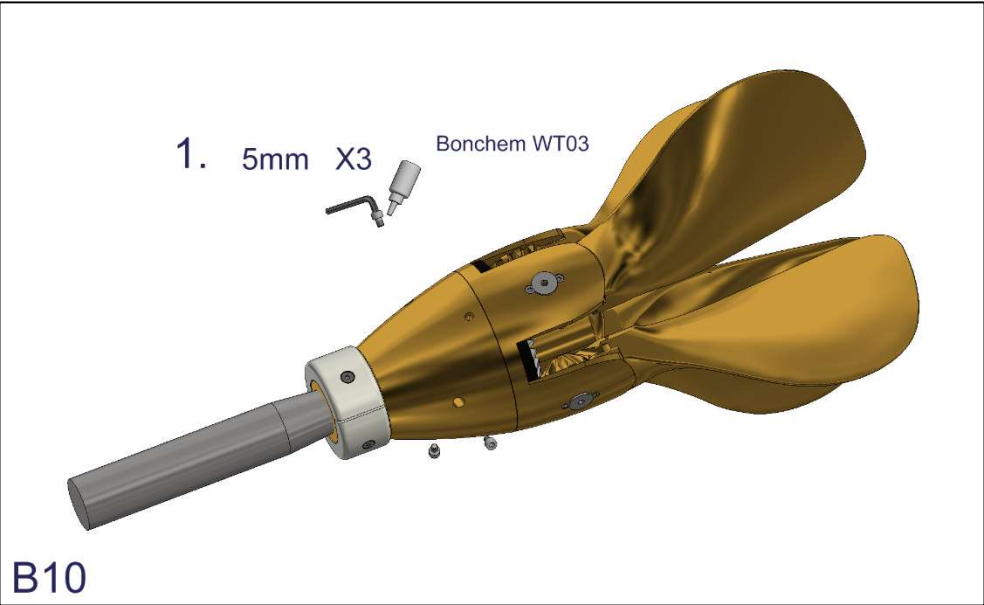

Exchange of “rubber blade stop” – (C)

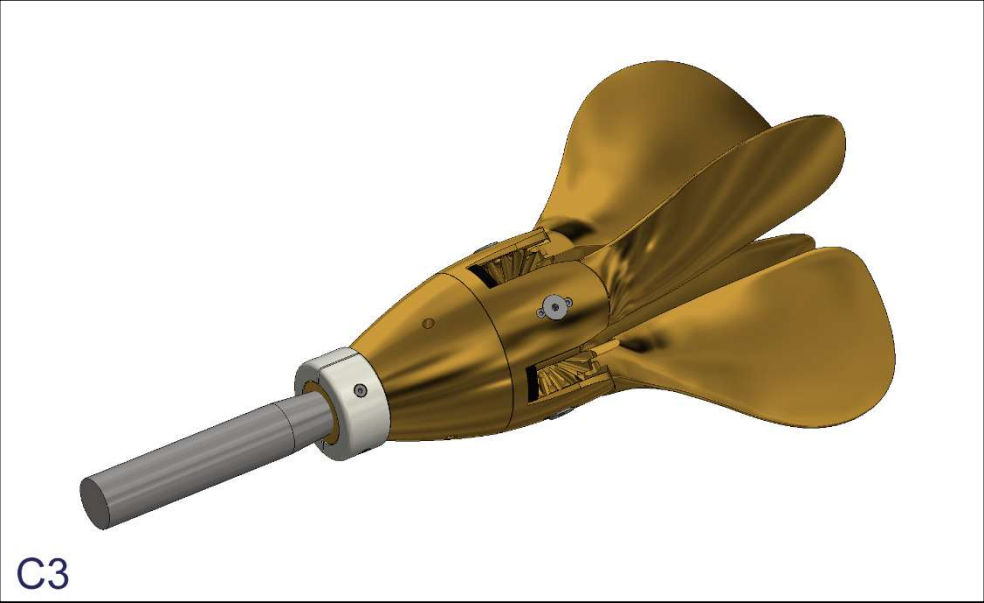
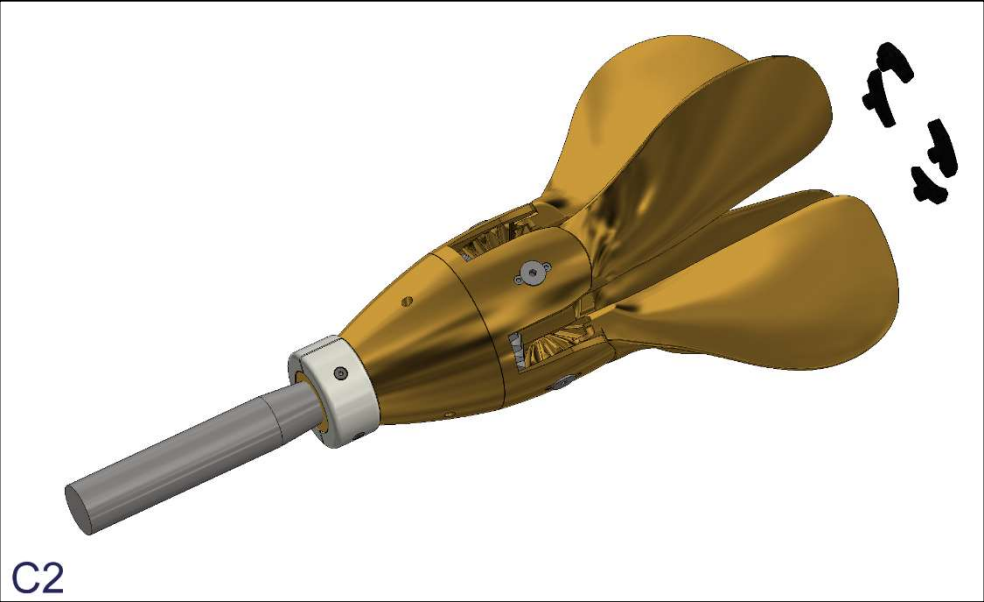
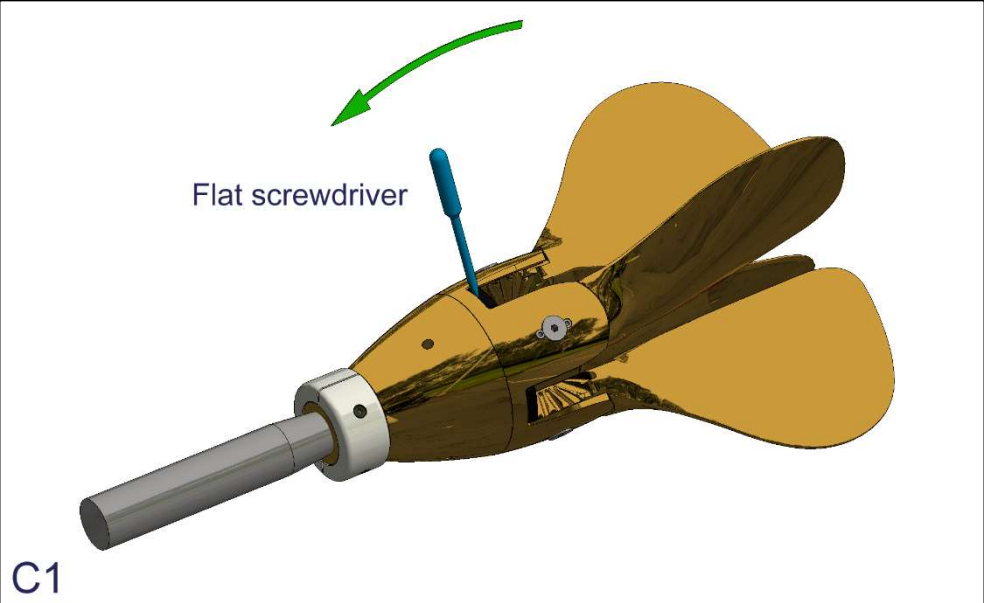

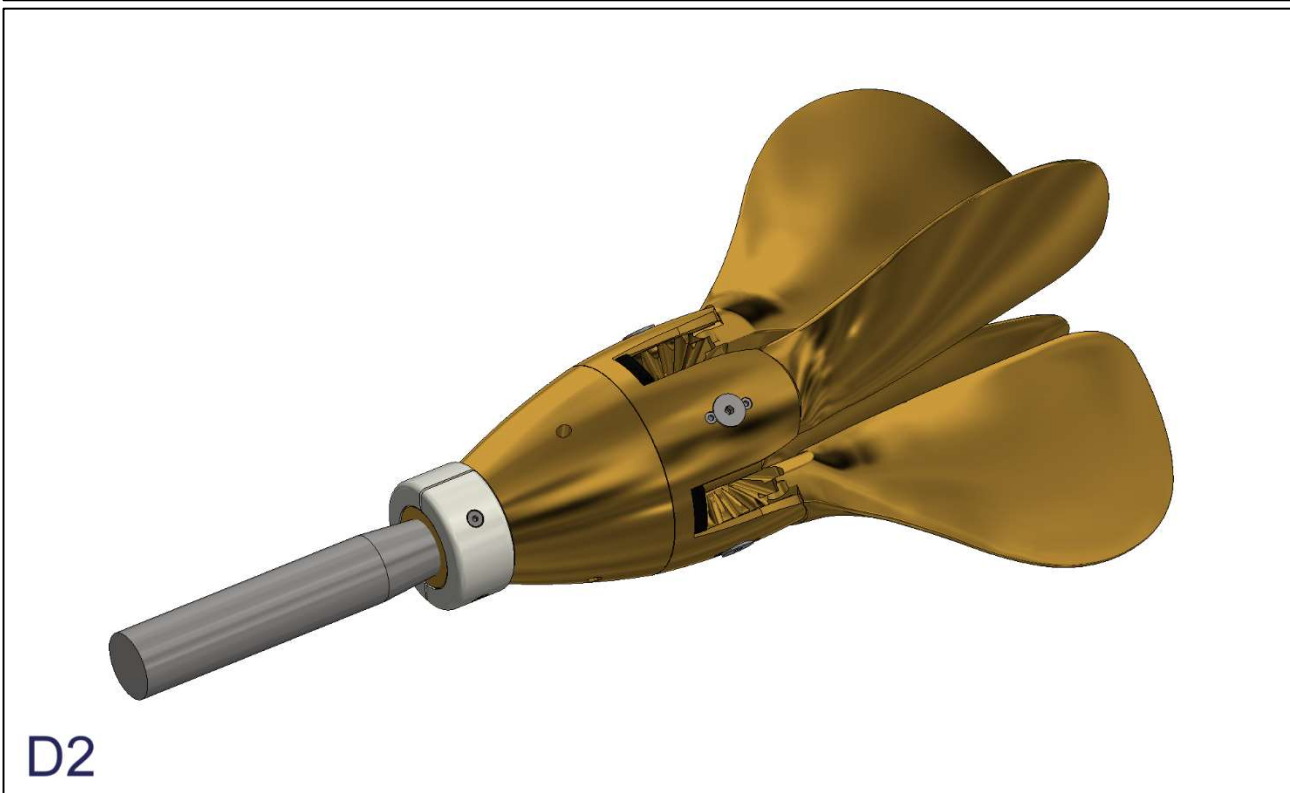
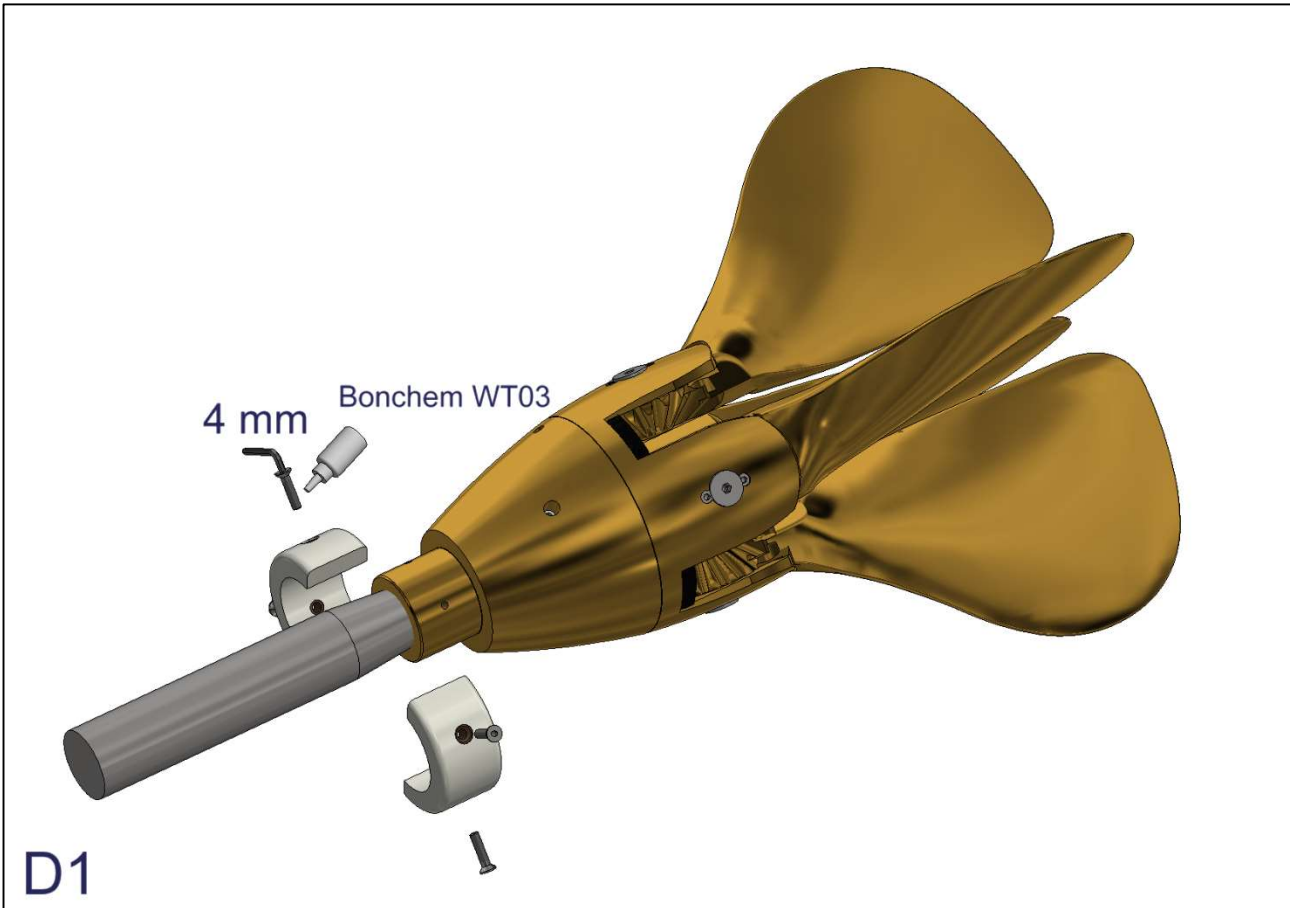

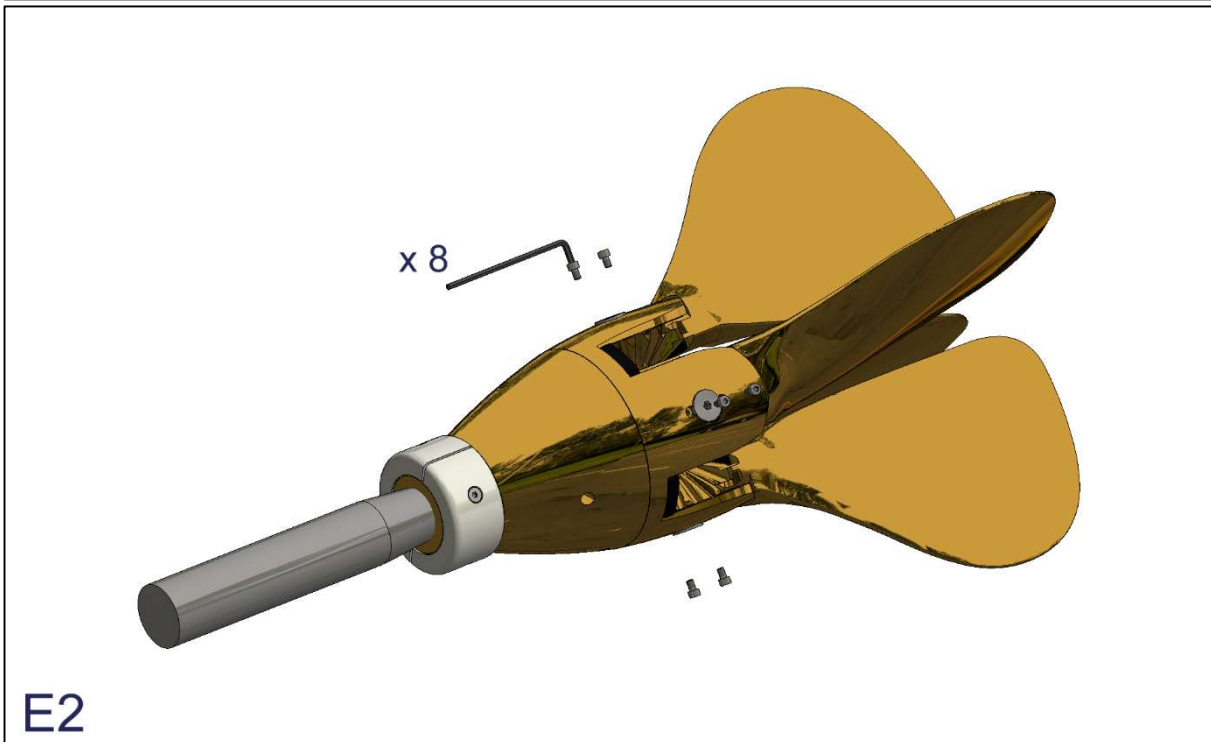
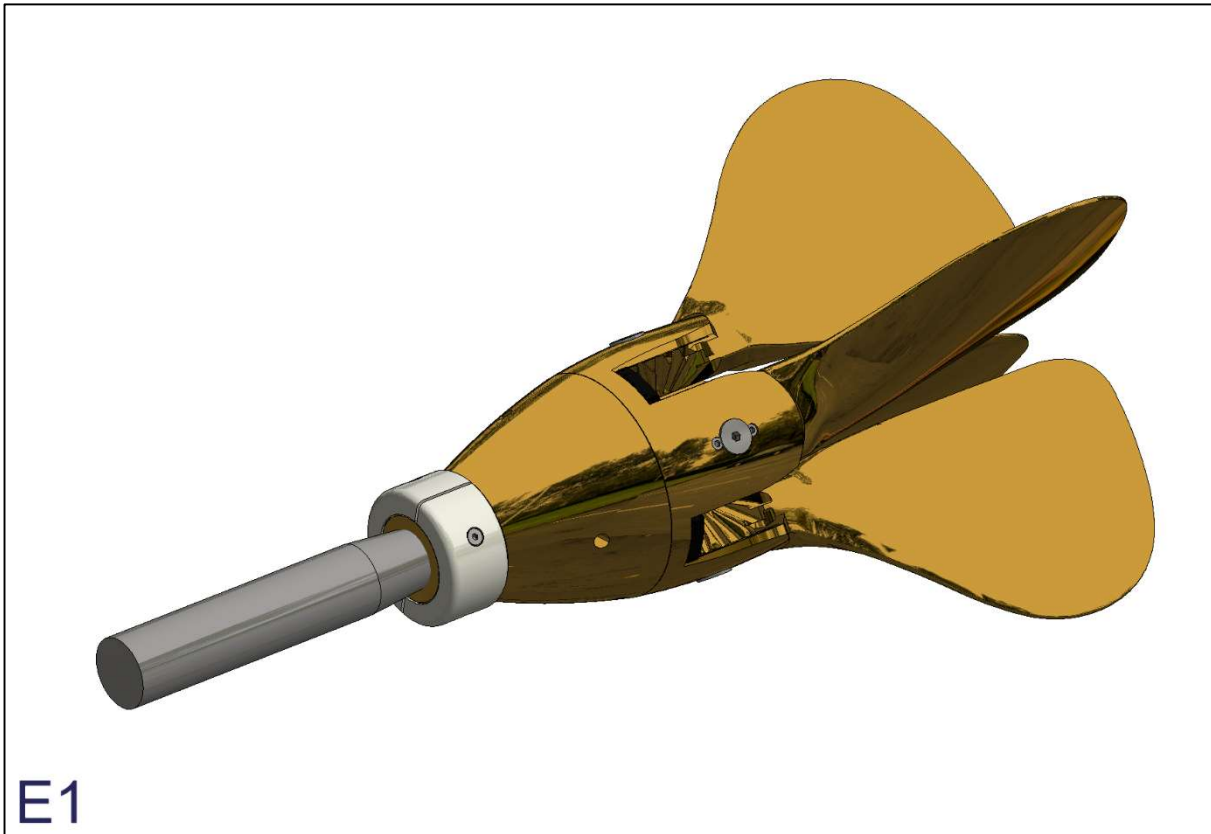

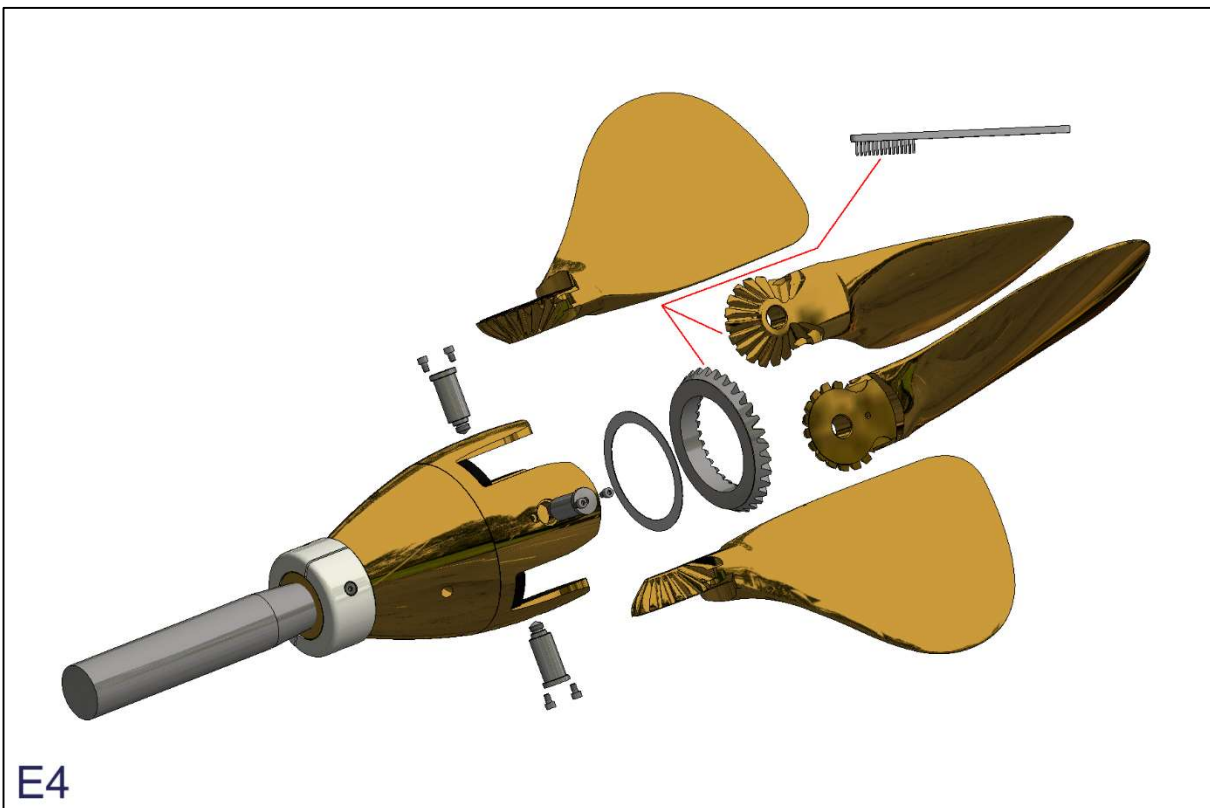
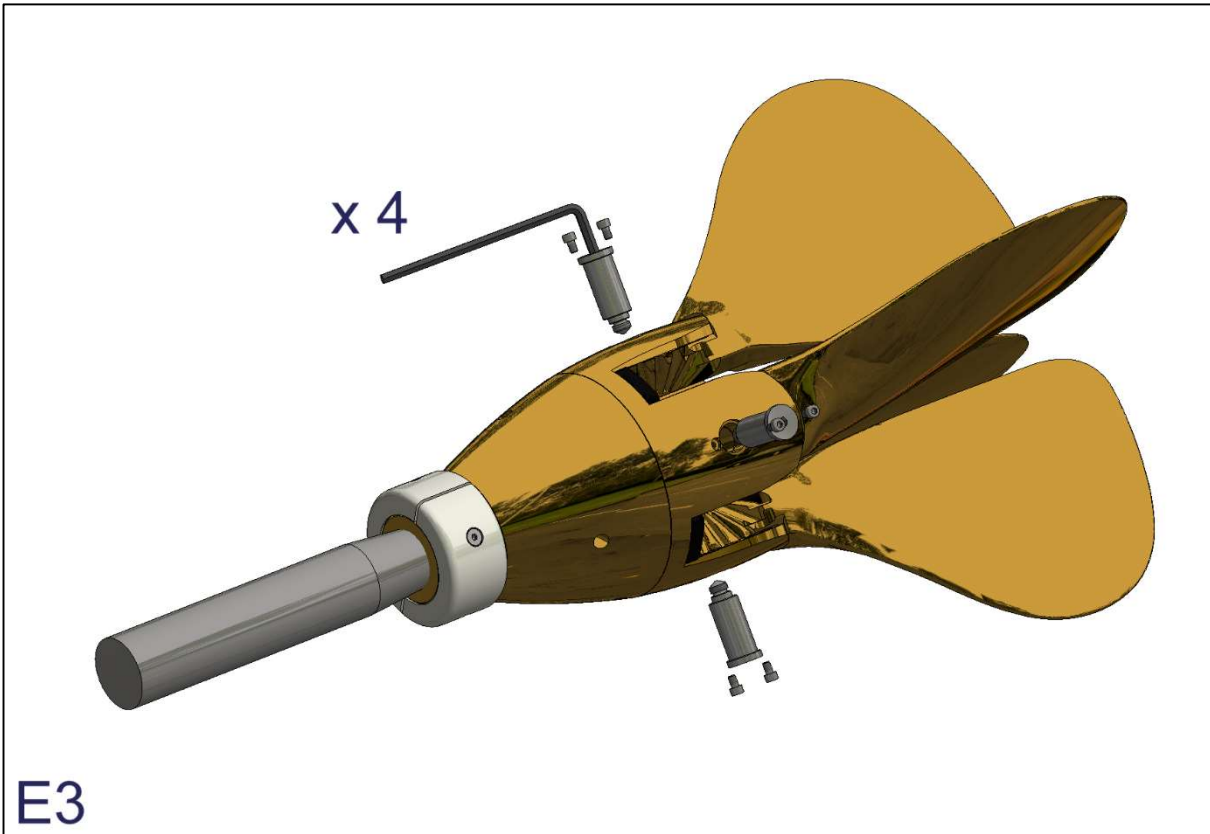

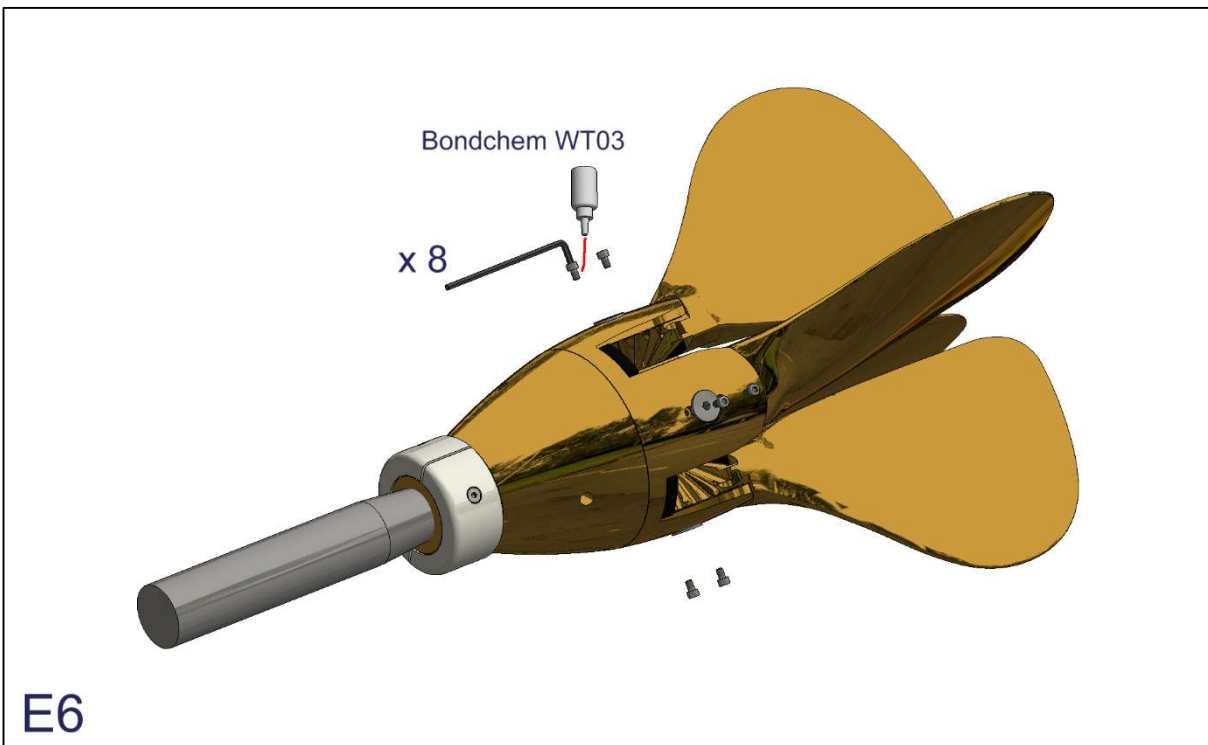
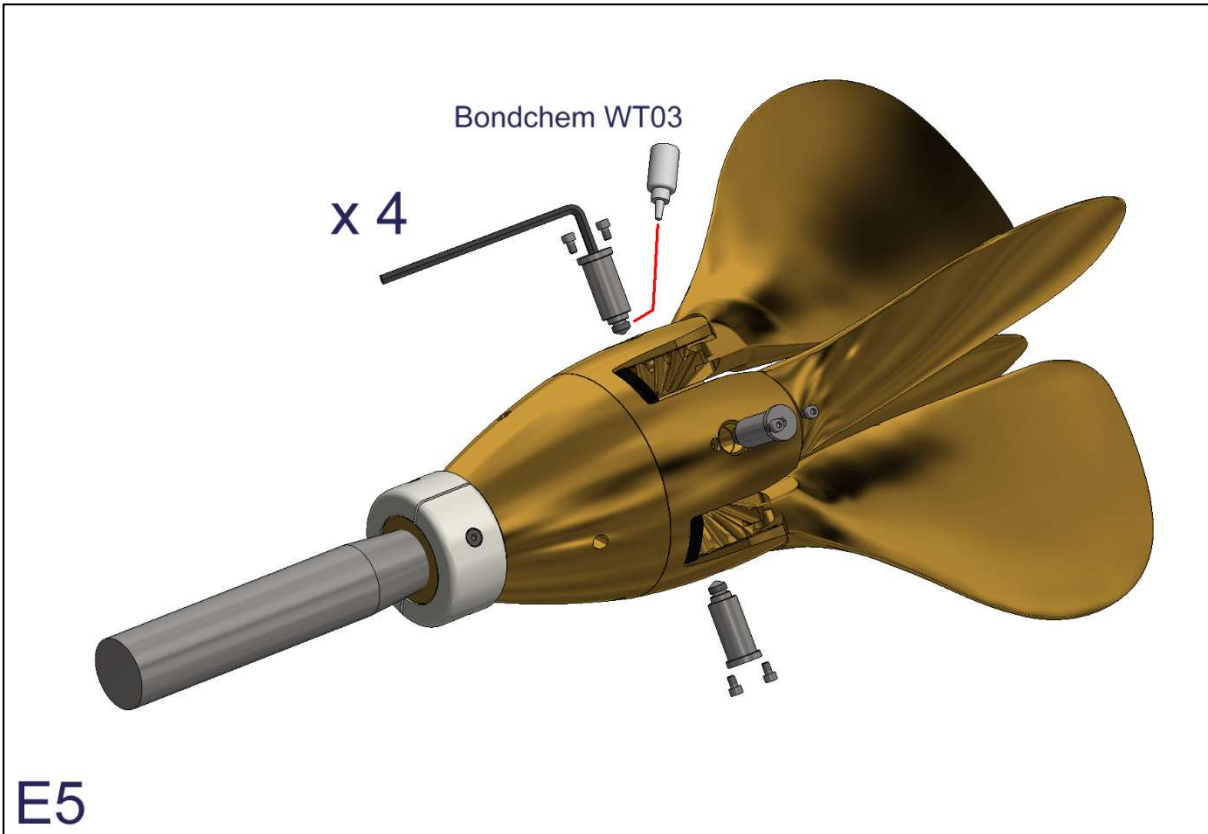

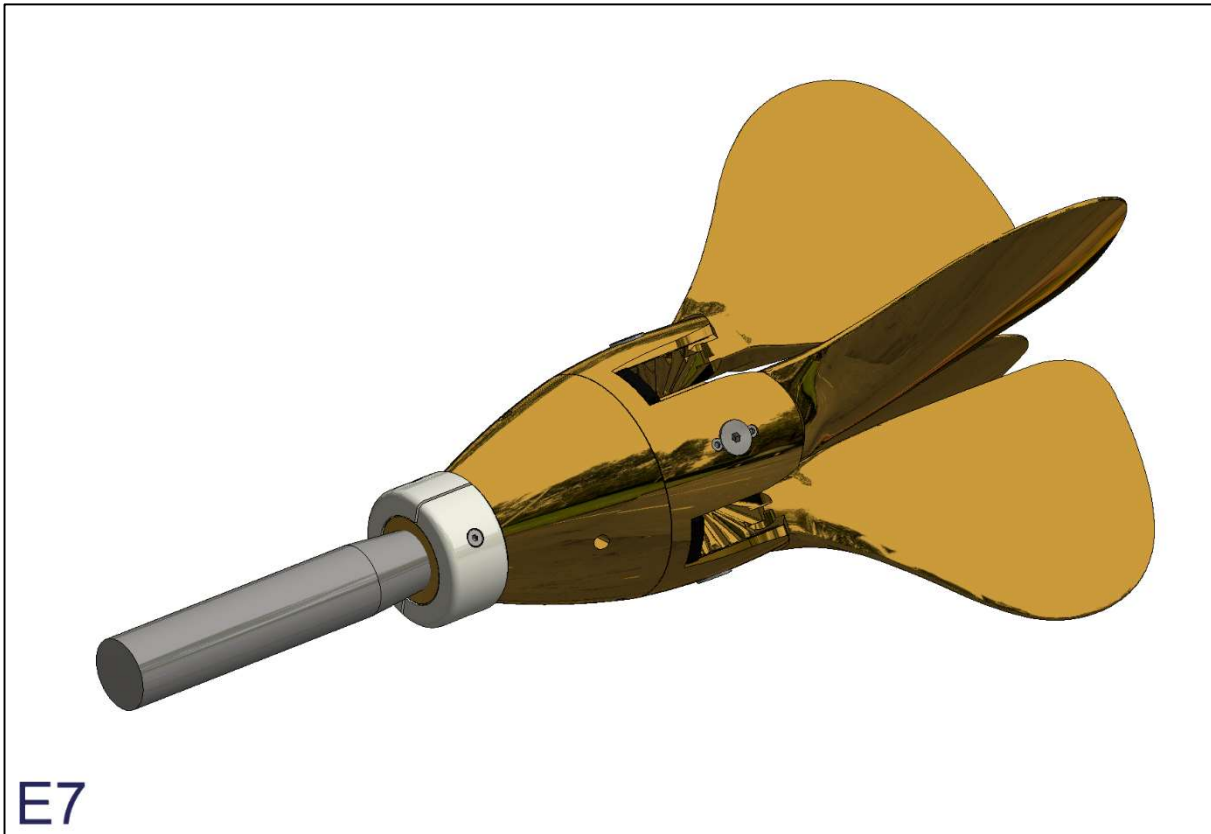

Spare Parts List – (F)

Size: 23" – 25" – 27"

ITEM	DK	GB	DE	STOCK NUMBER	QTY
1	Navtop	Blade housing	Nabenoberteil	5500084165	1
2	Konusdel	Tapered part	Kegel	3400000110	1
3	Nav kappe	Hub shell	Nabenschale	5300084165	1
4	Zinkanode	Zinc ring anode	Zinkring anode	1510560000	2
5	Gummistopper	Rubber stop;	Gummianschläge	1407604165	4
6	Propelblade / 23" x 17" RH	Propeller blades / 23" x 17" RH	Propellerblätter / 23" x 17" RH	5123017001	4
6	Propelblade / 23" x 17" LH	Propeller blades / 23" x 17" LH	Propellerblätter / 23" x 17" LH	5123017002	4
6	Propelblade / 25" x 14,5" RH	Propeller blades / 25" x 14,5" RH	Propellerblätter / 25" x 14,5" RH	5125014501	4
6	Propelblade / 25" x 14,5" LH	Propeller blades / 25" x 14,5" LH	Propellerblätter / 25" x 14,5" LH	5125014502	4
6	Propelblade / 25" x 15" RH	Propeller blades / 25" x 15" RH	Propellerblätter / 25" x 15" RH	5125015001	4
6	Propelblade / 25" x 16" RH	Propeller blades / 25" x 16" RH	Propellerblätter / 25" x 16" RH	5125016001	4
6	Propelblade / 25" x 17" RH	Propeller blades / 25" x 17" RH	Propellerblätter / 25" x 17" RH	5125017001	4
6	Propelblade / 25" x 17" LH	Propeller blades / 25" x 17" LH	Propellerblätter / 25" x 17" LH	5125017002	4
6	Propelblade / 25" x 18" LH	Propeller blades / 25" x 18" LH	Propellerblätter / 25" x 18" LH	5125018002	4
6	Propelblade / 25" x 19" RH	Propeller blades / 25" x 19" RH	Propellerblätter / 25" x 19" RH	5125019001	4
6	Propelblade / 25" x 19" LH	Propeller blades / 25" x 19" LH	Propellerblätter / 25" x 19" LH	5125019002	4
6	Propelblade / 27" x 17" LH	Propeller blades / 27" x 17" LH	Propellerblätter / 27" x 17" LH	5127017002	4
6	Propelblade / 27" x 18" RH	Propeller blades / 27" x 18" RH	Propellerblätter / 27" x 18" RH	5127018001	4
6	Propelblade / 27" x 18" LH	Propeller blades / 27" x 18" LH	Propellerblätter / 27" x 18" LH	5127018002	4
6	Propelblade / 27" x 19" LH	Propeller blades / 27" x 19" LH	Propellerblätter / 27" x 19" LH	5127019002	4
6	Propelblade / 27" x 20" RH	Propeller blades / 27" x 20" RH	Propellerblätter / 27" x 20" RH	5127020001	4
6	Propelblade / 27" x 20" LH	Propeller blades / 27" x 20" LH	Propellerblätter / 27" x 20" LH	5127020002	4
6	Propelblade / 27" x 21" RH	Propeller blades / 27" x 21" RH	Propellerblätter / 27" x 21" RH	5127021001	4
6	Propelblade / 27" x 21" LH	Propeller blades / 27" x 21" LH	Propellerblätter / 27" x 21" LH	5127021002	4
7	Tandhjul	Gear-wheel	Zahnrad	1407204165	1
8	Afstandsskive	Spacer	Abstandshalter	1404090000	1
9	Aksel til propelblade	Blade pins	Führungsbolzen	1513000000	4
10	Møtrik*	Nut*	Mütter*	---	1
11	Undersænket skrue	Flat Countersunk Head	Senkschraube	1179910625	4
12	Skrue - cylindrisk hoved	Hex Socket Head	Cylinderschraube	1406800000	3
13	Pinol skrue	Hex Socket Set Screw	Gewindestift	1401300000	3
14	Skrue - cylindrisk hoved	Hex Socket Head	Cylinderschraube	1406900000	8

Size: 29" – 32"

ITEM	DK	GB	DE	STOCK NUMBER	QTY
1	Navtop	Blade housing	Nabenoberteil	5500084220	1
2	Konusdel	Tapered part	Kegel	3400000140-1	1
3	Nav kappe	Hub shell	Nabenschale	5300084220	1
4	Zinkanode	Zinc ring anode	Zinkring anode	1549000000	2
5	Gummistopper	Rubber stop;	Gummianschläge	1407604165	4
6	Propelblade / 29" x 17" LH	Propeller blades / 29" x 17" LH	Propellerblätter / 29" x 17" LH	5130017002	4
6	Propelblade / 29" x 20" RH	Propeller blades / 29" x 20" RH	Propellerblätter / 29" x 20" RH	5130020001	4
6	Propelblade / 29" x 20" LH	Propeller blades / 29" x 20" LH	Propellerblätter / 29" x 20" LH	5130020002	4
6	Propelblade / 29" x 21" RH	Propeller blades / 29" x 21" RH	Propellerblätter / 29" x 21" RH	5130021001	4
6	Propelblade / 29" x 22" LH	Propeller blades / 29" x 22" LH	Propellerblätter / 29" x 22" LH	5130022002	4
6	Propelblade / 29" x 24" RH	Propeller blades / 29" x 24" RH	Propellerblätter / 29" x 24" RH	5130024001	4
6	Propelblade / 29" x 24" LH	Propeller blades / 29" x 24" LH	Propellerblätter / 29" x 24" LH	5130024002	4
6	Propelblade / 32" x 18" RH	Propeller blades / 32" x 18" RH	Propellerblätter / 32" x 18" RH	5132018001	4
6	Propelblade / 32" x 20" RH	Propeller blades / 32" x 20" RH	Propellerblätter / 32" x 20" RH	5132020001	4
6	Propelblade / 32" x 22" LH	Propeller blades / 32" x 22" LH	Propellerblätter / 32" x 22" LH	5130022002	4
6	Propelblade / 32" x 23" RH	Propeller blades / 32" x 23" RH	Propellerblätter / 32" x 23" RH	5132023001	4
6	Propelblade / 32" x 23" LH	Propeller blades / 32" x 23" LH	Propellerblätter / 32" x 23" LH	5132023002	4
6	Propelblade / 32" x 24" RH	Propeller blades / 32" x 24" RH	Propellerblätter / 32" x 24" RH	5132024001	4
6	Propelblade / 32" x 24" LH	Propeller blades / 32" x 24" LH	Propellerblätter / 32" x 24" LH	5132024002	4
6	Propelblade / 32" x 25" RH	Propeller blades / 32" x 25" RH	Propellerblätter / 32" x 25" RH	5132025001	4
7	Tandhjul	Gear-wheel	Zahnrad	1407284220	1
8	Afstandsskive	Spacer	Abstandshalter	1404600150	1
9	Aksel til propelblade	Blade pins	Führungsbolzen	1514084220	4
10	Møtrik*	Nut*	Mütter*	---	1
11	Undersænket skrue	Flat Countersunk Head	Senkschraube	1179910625	4
12	Skrue - cylindrisk hoved	Hex Socket Head	Cylinderschraube	1406800000	3
13	Pinol skrue	Hex Socket Set Screw	Gewindestift	1401300000	3
14	Skrue - cylindrisk hoved	Hex Socket Head	Cylinderschraube	1406900000	8

*: Møtrik – bestilles kunde specifik; Nut – ordered cuttom specific; Mütter – kundenspezifisch bestellt

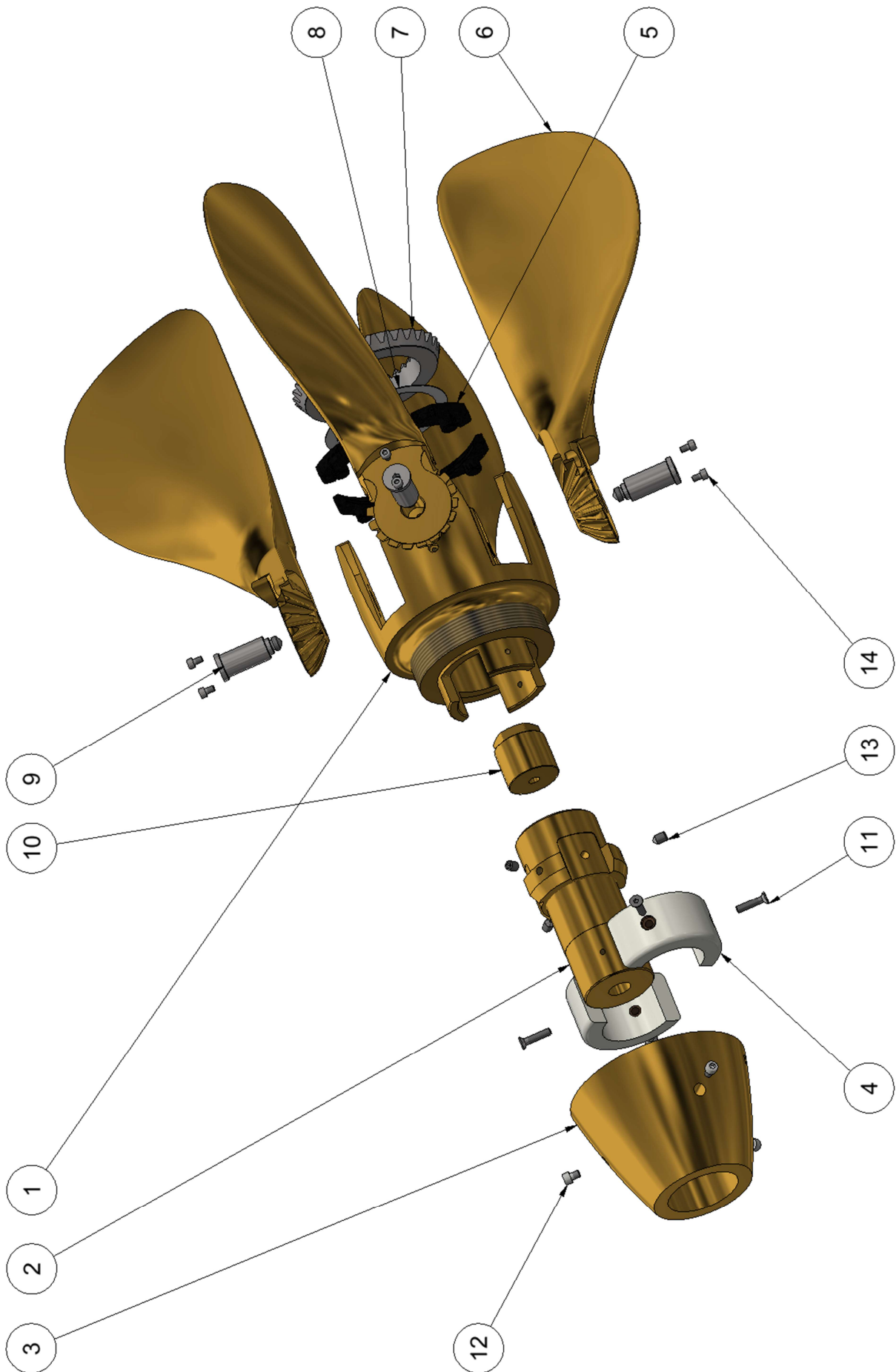

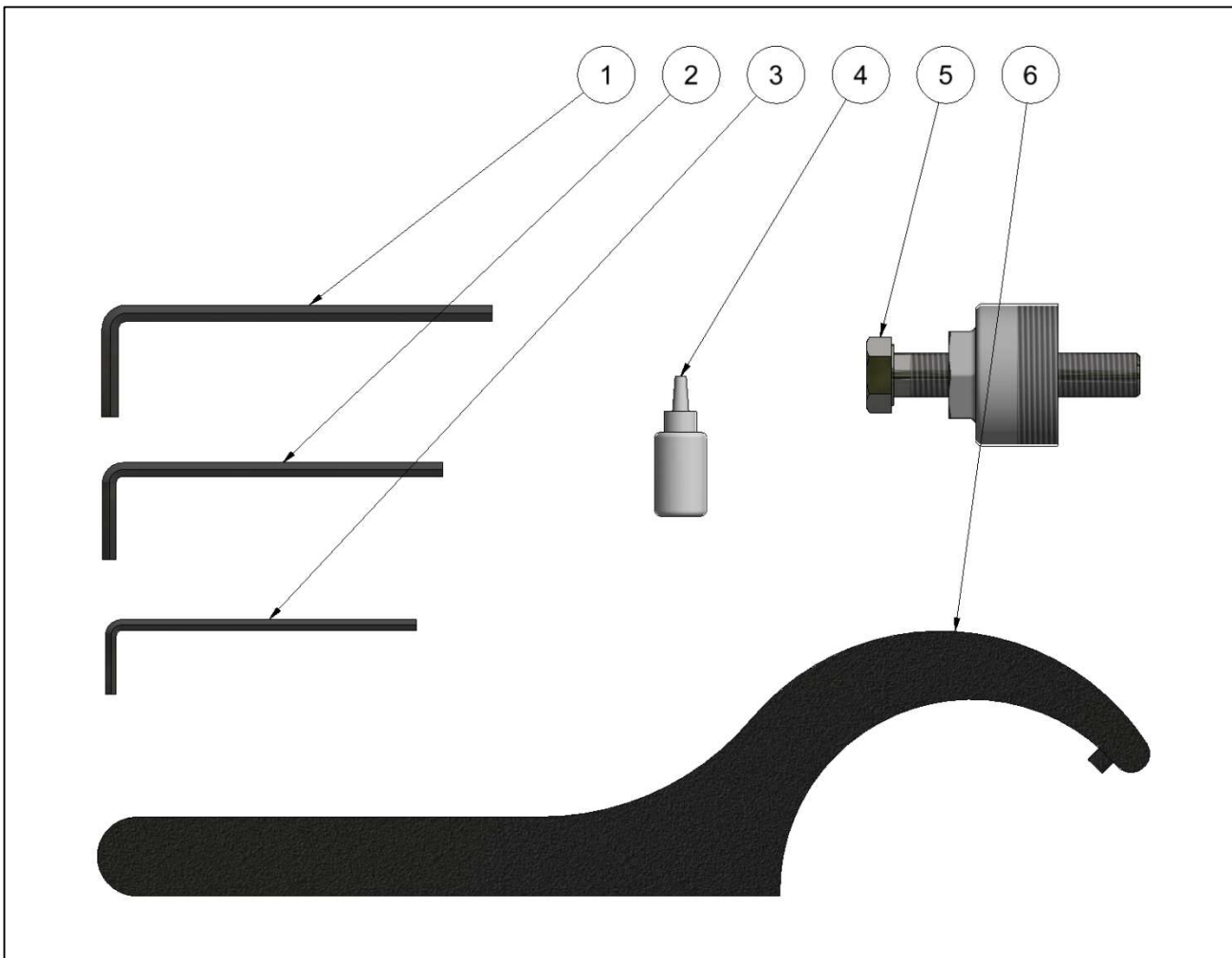

23" – 25" – 27"

ITEM	DK	GB	DE	STOCK NUMBER
1	Umbracnøgle - 6 mm	Allen key - 6 mm	Inbusschlüssel - 6 mm	1402200000
2	Umbracnøgle - 5 mm	Allen key - 5 mm	Inbusschlüssel - 5 mm	1402100000
3	Umbracnøgle - 4 mm	Allen key - 4 mm	Inbusschlüssel - 4 mm	1402000000
4	Låselim - Bondchem WT03	Locking glue - Bondchem WT03	Leim - Bondchem WT03	1410000000
5	Aftrækker	Puller	Abzieher	1528000000
6	Hagenøgle	C-Spanner	Hagenschlüssel	1409800165

29" – 32"

ITEM	DK	GB	DE	STOCK NUMBER
1	Umbracnøgle - 6 mm	Allen key - 6 mm	Inbusschlüssel - 6 mm	1402200000
2	Umbracnøgle - 5 mm	Allen key - 5 mm	Inbusschlüssel - 5 mm	1402100000
3	Umbracnøgle - 4 mm	Allen key - 4 mm	Inbusschlüssel - 4 mm	1402000000
4	Låselim - Bondchem WT03	Locking glue - Bondchem WT03	Leim - Bondchem WT03	1410000000
5	Aftrækker	Puller	Abzieher	1529000000
6	Hagenøgle	C-Spanner	Hagenschlüssel	1409800220

14102022

Gori propeller ApS

Fjordagervej 34-36

DK-6100 Haderslev

www.gori-propeller.dk