

SIZE -0091  
 LENGTH 1481 mm  
 ROD THREAD 1 1/4-12 UNF  
 BORE DIA 105 mm  
 ROD DIA 35 mm  
 STROKE 425 mm  
 WEIGHT 33.745 Kg  
 ANNULUS AREA (PULLING/RETRACTING) 7697 mm<sup>2</sup>  
 OIL DISPLACEMENT 6.54 ltrs  
 PULL FORCE @ 150 BAR 11769 Kg (115454 N)  
 PULL FORCE @ 250 BAR 19615 Kg (192423 N)  
 MAX PULL FORCE @ 350 BAR (RELIEF) 27461 Kg (269392 N)

**NOTE:**

1. CUSTOM VARIATIONS AND ROD THREADS ARE AVAIBALE ON REQUEST
2. ATTACHMENT METHOD CUSTOMISABLE ON REQUEST

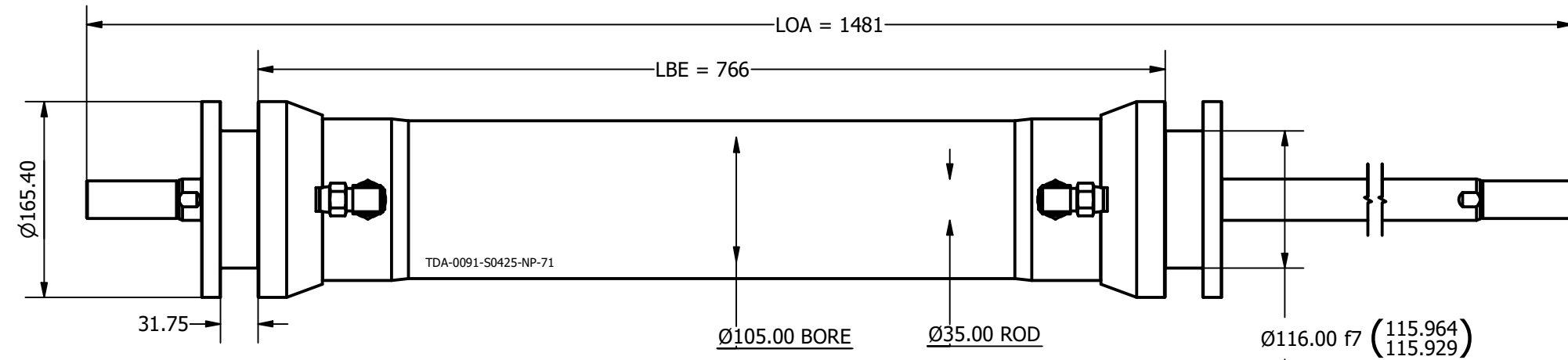

SAME MOUNTING  
DETAIL BOTH ENDS

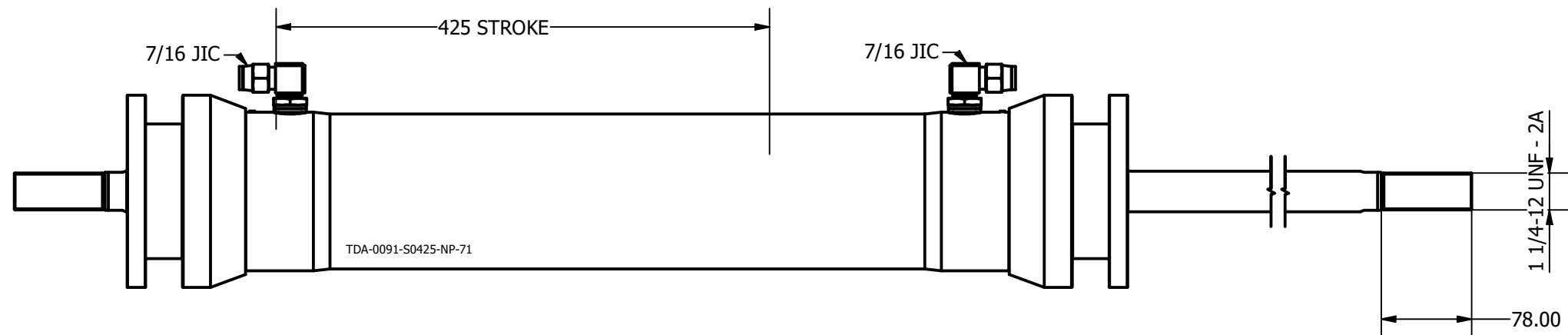
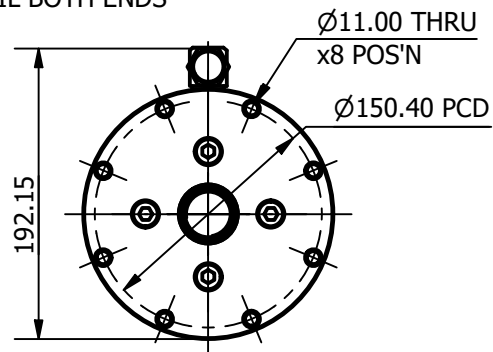

TOP SLOT SHOULD BE  
LARGER THAN ROD

BRACKET HOLE SHOULD  
MATCH RETAINER

BRACKET PLATE THICKNESS  
SHOULD BE EQUAL TO  
RETAINER GAP

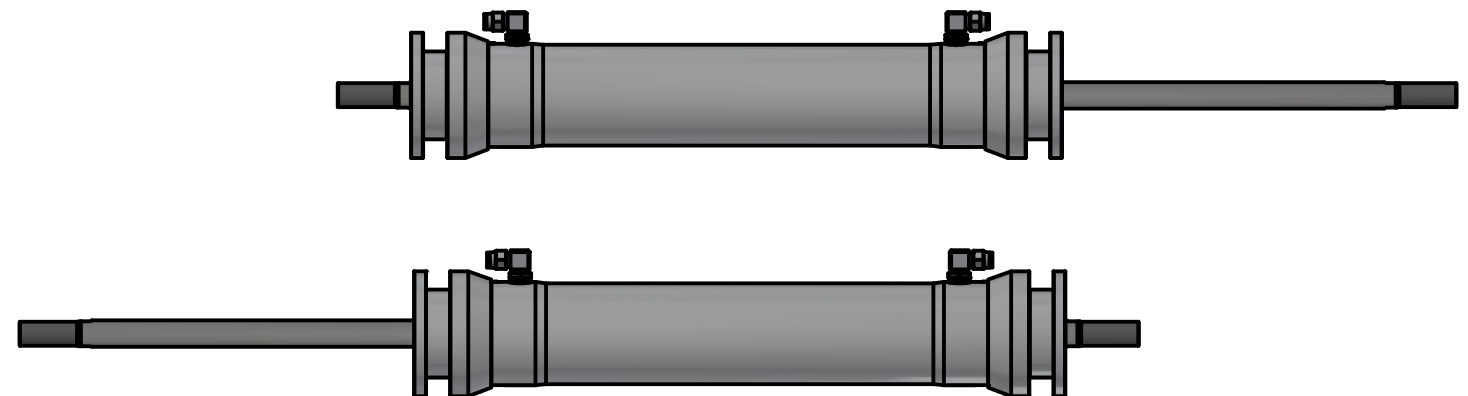
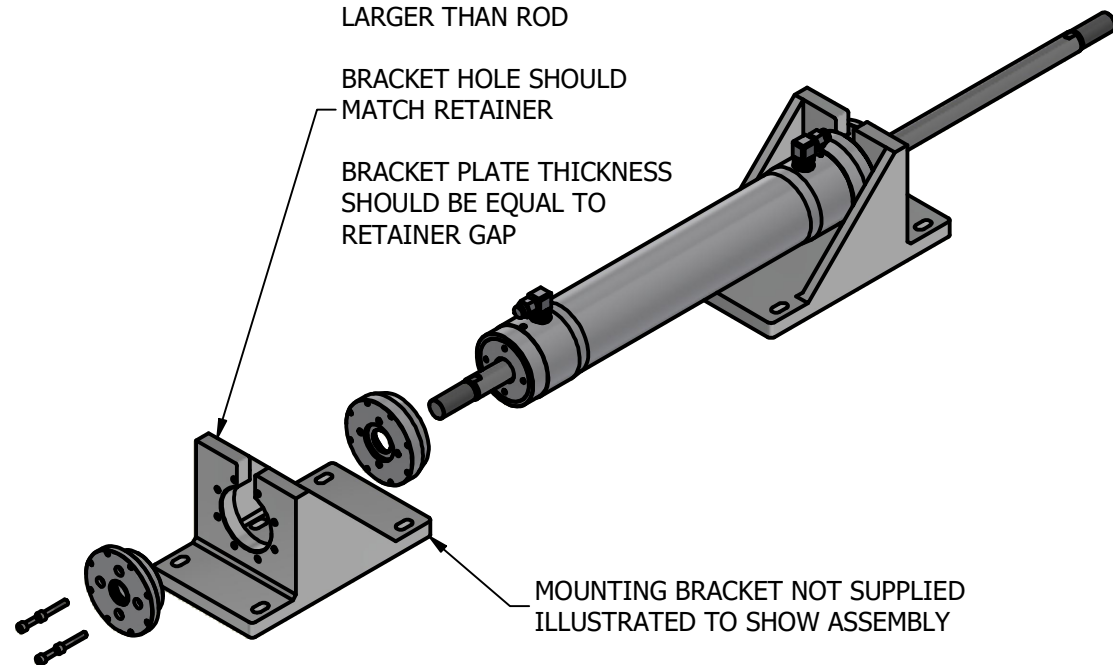

**OMS**  
Ocean Marine Systems

Title ALUMINIUM DOUBLE PULL TRAVELLER CYLINDER		Revision 1
Drawing No. TDA-0091-S0425-NP-71		Date Drawn By 03/11/2021 AL
Tel: +44 (0)1202 596630 www.oms.ltd		© Copyright. All rights to this drawing and design are the sole property of OMS Ltd. This drawing must not be copied, communicated or loaned to any third party without the written consent of OMS Ltd.