

SIZE -0076
 PCLC 987 mm
 PIN / GAP 31.75 mm
 BORE DIA 95 mm
 ROD DIA 35 mm
 STROKE 550 mm
 WEIGHT 21.25 Kg
 FULL BORE AREA (PUSHING/EXTENDING) 7088 mm²
 ANNULUS AREA (PULLING/RETRACTING) 6126 mm²
 GAS DISPLACEMENT (FULL BORE SIDE) 3.90 ltrs
 OIL DISPLACEMENT (ANNULUS SIDE) 2.30 ltrs
 MAXIMUM PUSH FORCE @ 5 BAR 361 Kg (3544 N)
 PULL FORCE @ 150 BAR 9367 Kg (91892 N)
 PULL FORCE @ 250 BAR 15612 Kg (153153 N)
 MAX PULL FORCE @ 350 BAR (RELIEF) 21857 Kg (214414 N)

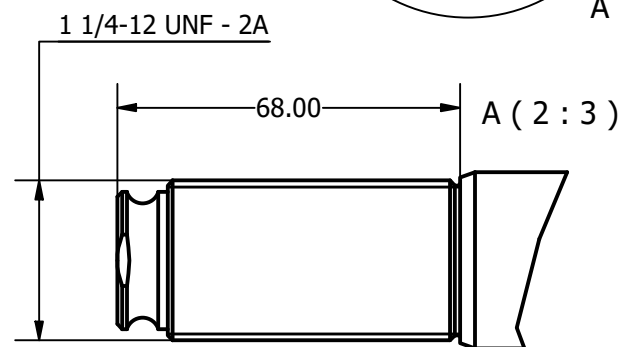
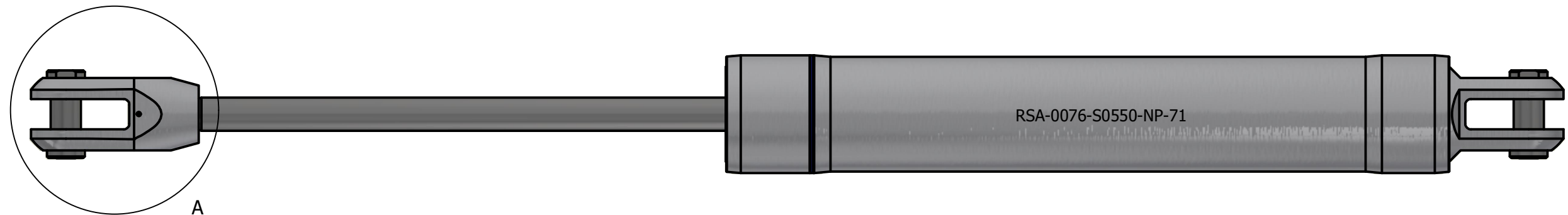
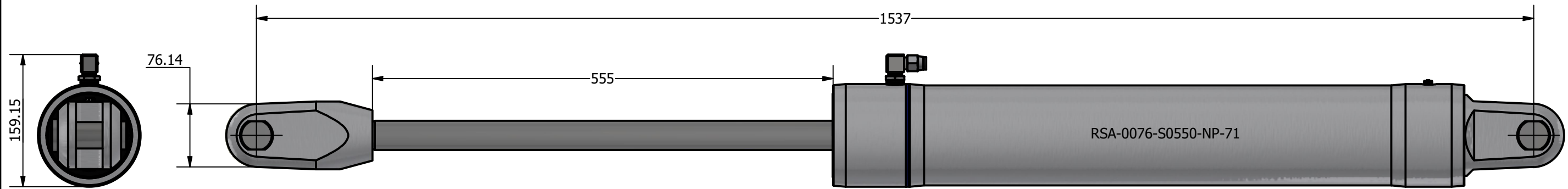
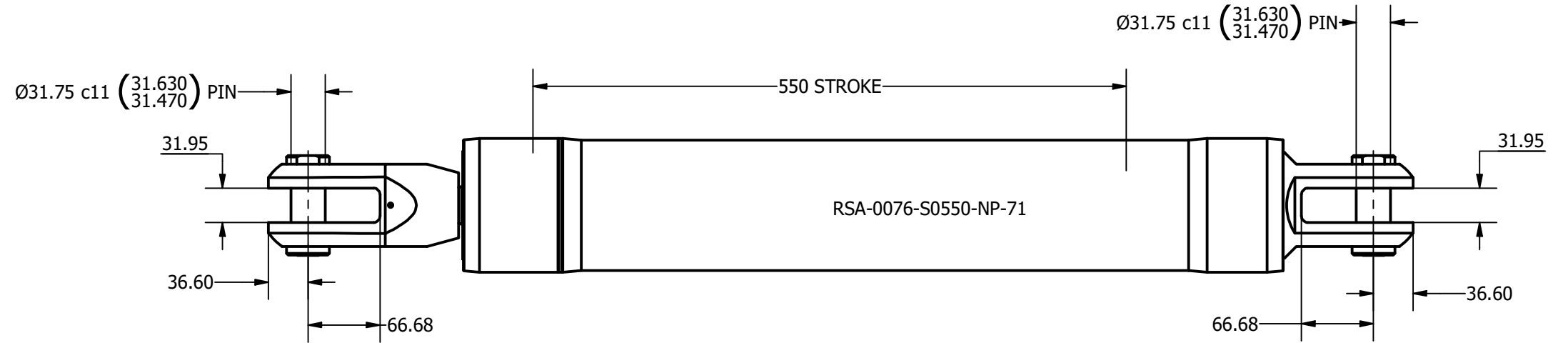
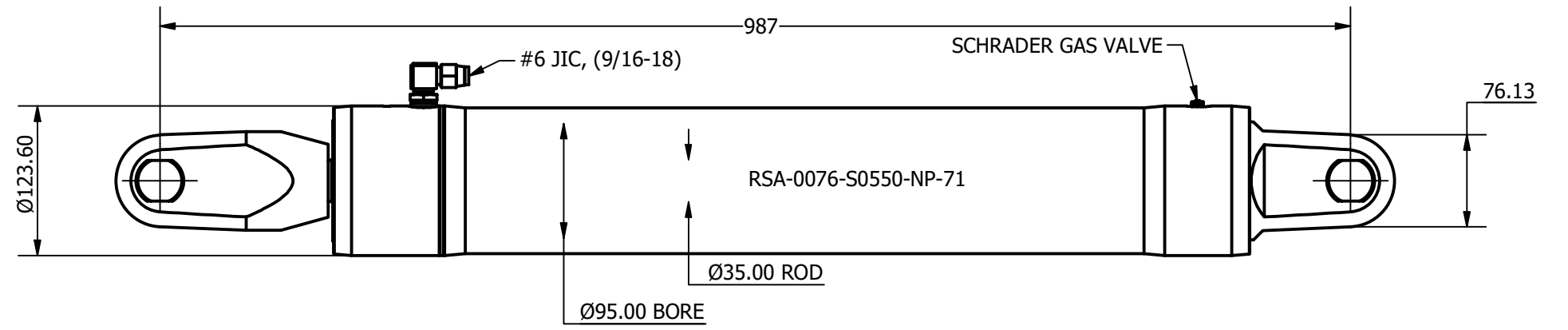

NOTE: CUSTOM STROKES, LENGTHS AND CLEVIS DIMENSIONS AVAILABLE UPON REQUEST

	Title ALUMINIUM SINGLE ACTING GAS RETURN CYLINDER		Revision 3
	Drawing No. RSA-0076-S0550-NP-71		Date Drawn 26/10/2021
	Tel: +44 (0)1202 596630 www.oms.ltd		By AL

© Copyright. All rights to this drawing and design are the sole property of OMS Ltd. This drawing must not be copied, communicated or loaned to any third party without the written consent of OMS Ltd.